

Submittal Data Sheet

Wilo IL - Inline Centrifugal Circulators



Wilo IL 1.25 1750 RPM



Project:	
Engineer:	
Contractor:	
Submitted By:	Date:
Approved By:	Date:

Tag #	Model #	Flow	Head	HP	Cycle	Phase	Voltage	RPM
					60Hz			1,750 (4 Pole)

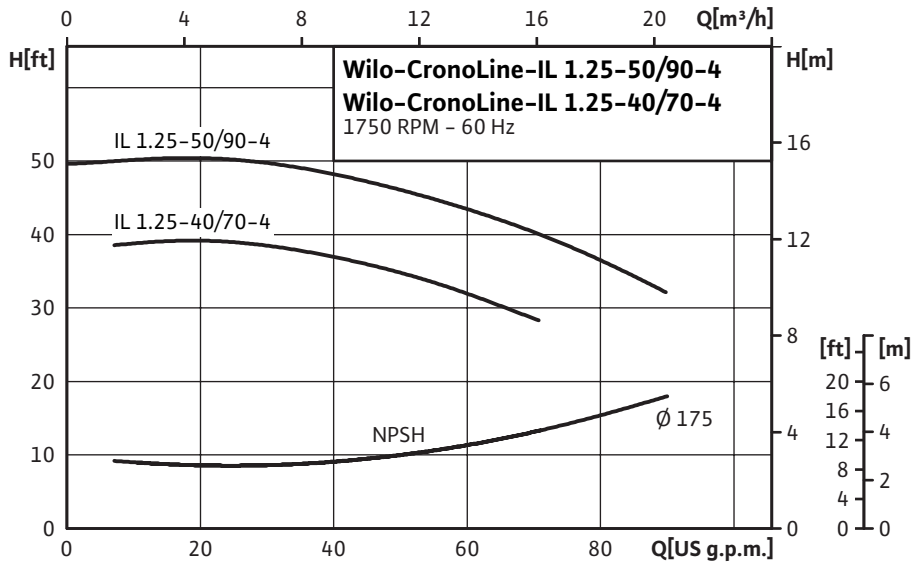

Technical Data	
Temp Range:	-5 °F to +285 °F (-20 °C to +140 °C)
Power Supply	1-115/208-230 volt 3-208-230/460, 575 volt
Motor Options	TEFC, (ODP Opt), EPACK Rated
Flange Connection	1½" NPT with ¼" pressure gauge tappings
Max operating pressure:	250 PSI (16 bar)

Materials of Construction	
Pump volute	Cast Iron
Impeller	Bronze (cast iron optional)
Shaft	316L stainless steel
Mechanical seal	Q1Q1X4GG (silicium carbide seal faces, HNBR elastomers)

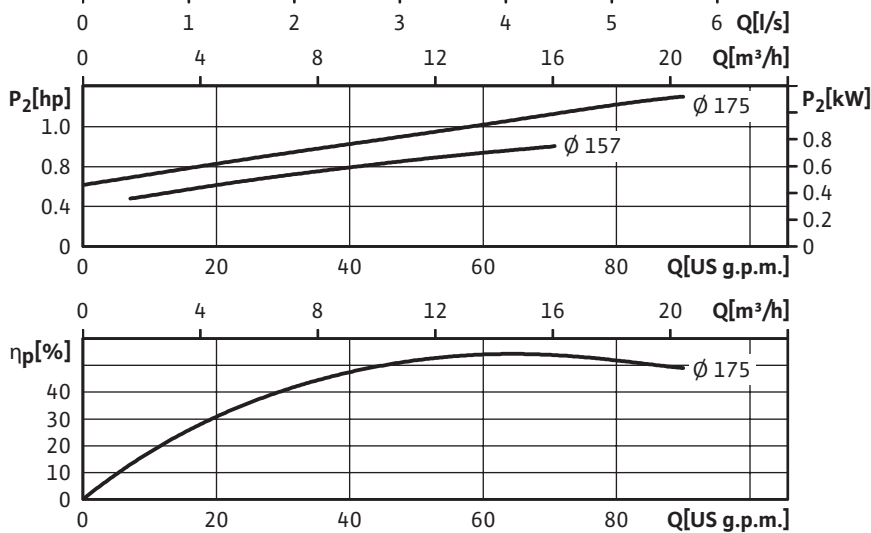

Applications	
• Hot water heating systems	• Industrial circulation systems
• Air conditioning systems	• Solar Systems
• Closed cooling circuits	• Geothermal Systems

Approval Stamp

Dimensions & Weights

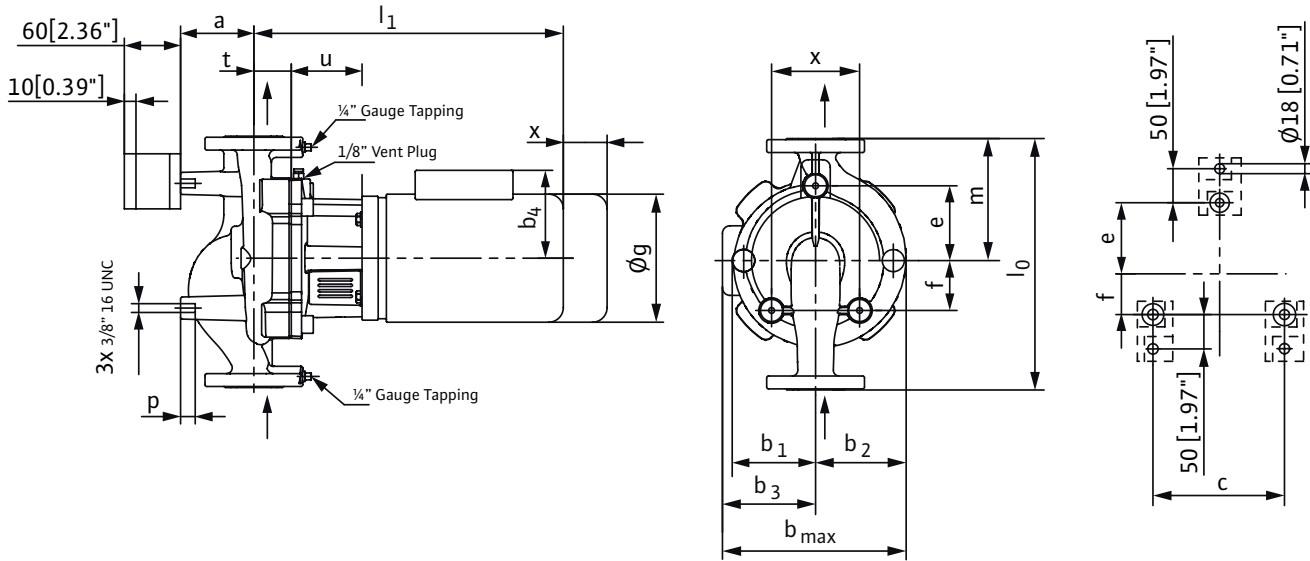

Dimensions and Weights

Model	Dia.	Dimensions-inches (mm)														Weight			
		l_0	a	b_1	b_2	b_3	b_4	b_{max}	c	e	f	ϕg	l_1	m	p		t	u	x
IL 1.25-40/70-4	1 1/4	13 1/2	3 15/16	4 1/2	4 7/8	5 5/8	5 1/2	10 1/2	4 3/4	4	2 11/16	7 3/16	16 7/8	6 9/16	13 1/16	2	3 13/16	4	95 lbs
	1 1/4	(343)	(100)	(114)	(124)	(143)	(139)	(267)	(120)	(102)	(68)	(183)	(431)	(166)	(20)	(51)	(97)	(102)	43 kg
IL 1.25-50/90-4	1 1/4	13 1/2	3 15/16	4 1/2	4 7/8	5 5/8	5 1/2	10 1/2	4 3/4	4	2 11/16	7 3/16	17 7/8	6 9/16	13 1/16	2	3 13/16	4	101 lbs
	1 1/4	(343)	(100)	(114)	(124)	(143)	(139)	(267)	(120)	(102)	(68)	(183)	(453)	(166)	(20)	(51)	(97)	(102)	46 kg

Flange Dimensions

Dimensions - Inches (mm)				
DN	ϕD	ϕd_1	ϕk	$n \times d_L$
1.25	5 1/4	3 1/16	3 1/2	4 x 5/8
	(133)	(78)	(89)	(4 x 16)

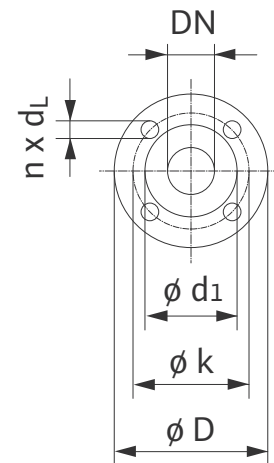

TEFC Motor Data

Model	P2	Phase	Voltage	FLA
	[HP]	[~]	[V]	[A]
IL 1.25-40/70-4	1	1	115 / 208-230	12.8/6.4
		3	208-230/460	3.7-3.4/1.7
IL 1.25-50/90-4	1.5	1	115 / 208-230	18/8
		3	208-230/460	4.5-4.2/2.1

Submittal Data Sheet

Wilco IL - In-line Centrifugal Circulators



Wilco IL 1.5-35, 1.5-45 1750 RPM



Project:			
Engineer:			
Contractor:			
Submitted By:		Date:	
Approved By:		Date:	

Tag #	Model #	Flow	Head	HP	Cycle	Phase	Voltage	RPM
					60Hz			1,750 (4 Pole)

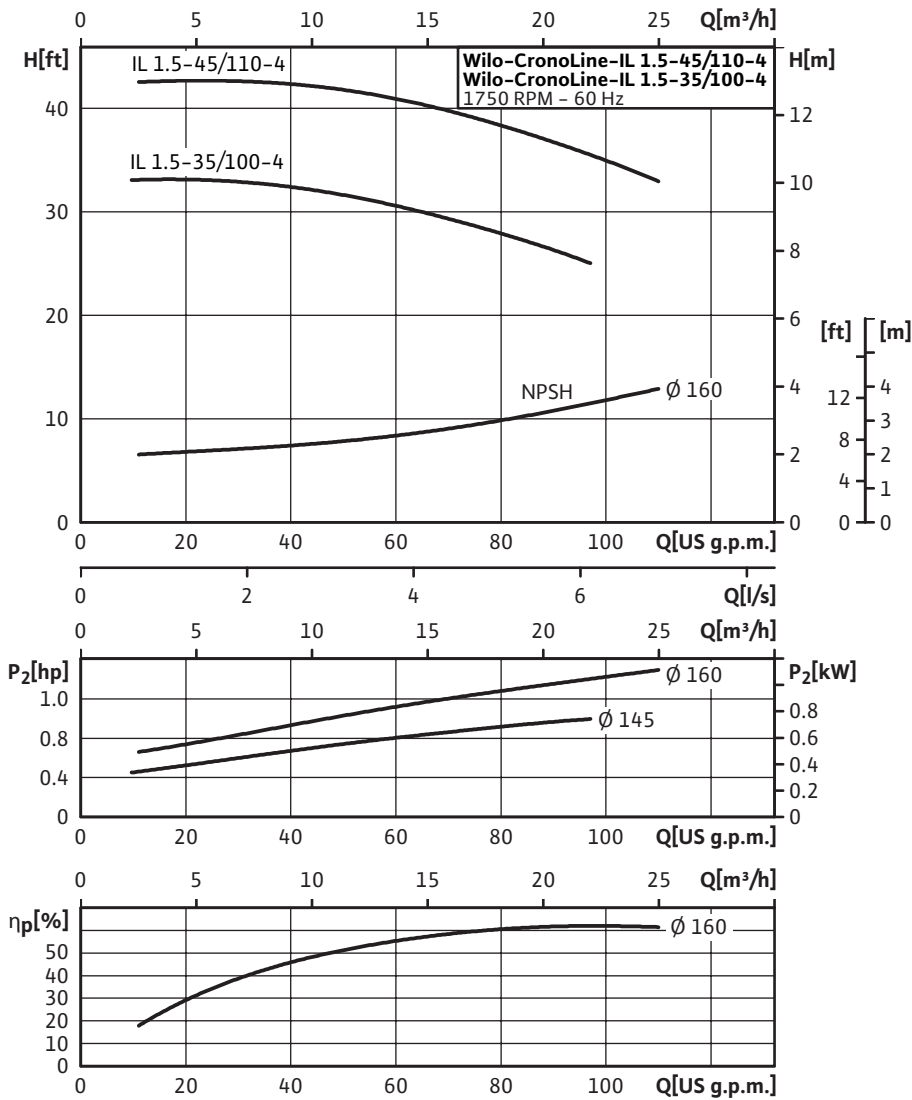

Technical Data

Temp Range:	-5 °F to +285 °F (-20 °C to +140 °C)
Power Supply	1-115/208-230 volt 3-208-230/460, 575 volt
Motor Options	TEFC, (ODP Opt), EPACK Rated
Flange Connection	1½" NPT with ¼" pressure gauge tappings
Max operating pressure:	250 PSI (16 bar)

Materials of Construction

Pump volute	Cast Iron
Impeller	Bronze (cast iron optional)
Shaft	316L stainless steel
Mechanical seal	Q1Q1X4GG (silicium carbide seal faces, HNBR elastomers)

Applications

• Hot water heating systems	• Industrial circulation systems
• Air conditioning systems	• Solar Systems
• Closed cooling circuits	• Geothermal Systems

Approval Stamp

Dimensions & Weights

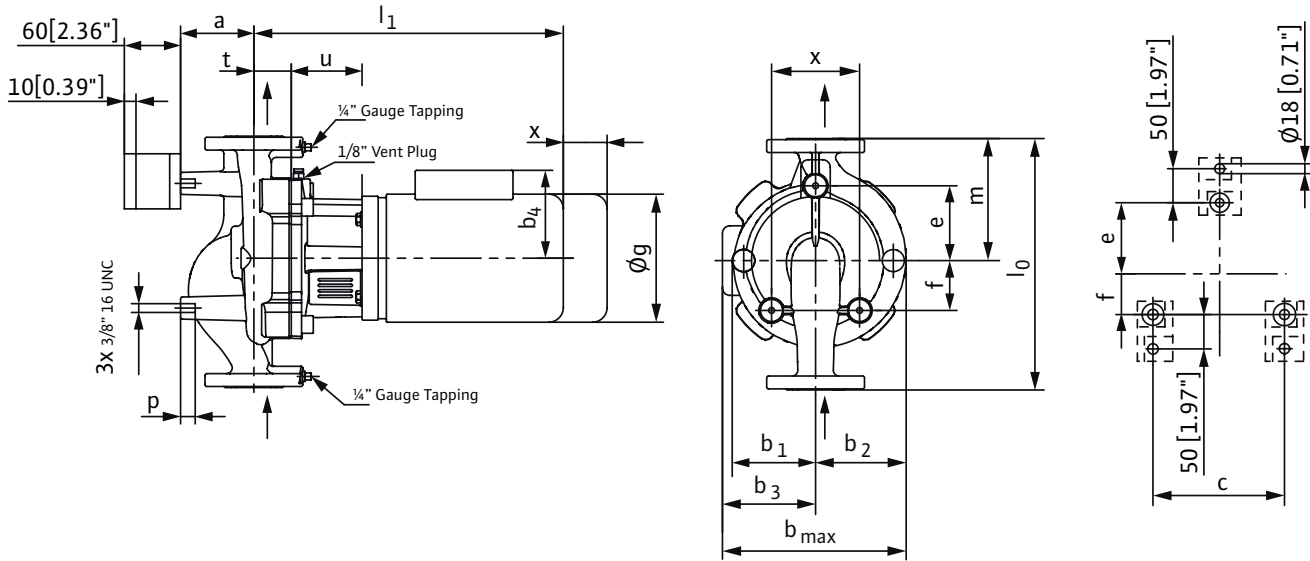

Dimensions and Weights

Model	Dia	Dimensions-inches (mm)														Weight			
		l_0	a	b_1	b_2	b_3	b_4	b_{max}	c	e	f	ϕg	l_1	m	p		t	u	x
IL 1.5-35/100-4	1½	14½	3¼	4½	5 ^{1/16}	5 ^{5/8}	5½	10 ^{11/16}	5 ^{1/8}	5 ^{7/8}	2 ^{5/16}	7 ^{3/16}	17½	7	1 ^{3/16}	2 ^{9/16}	3 ^{13/16}	4	99 lbs
	1½ (368)	(82)	(114)	(129)	(143)	(139)	(272)	(130)	(149)	(58)	(183)	(445)	(178)	20	(65)	(97)	(102)	45 kg	
IL 1.5-45/110-4	1½	14½	3¼	4½	5 ^{1/16}	5 ^{5/8}	5½	10 ^{11/16}	5 ^{1/8}	5 ^{7/8}	2 ^{5/16}	7 ^{3/16}	18 ^{3/8}	7	1 ^{3/16}	2 ^{9/16}	3 ^{13/16}	4	106 lbs
	1½ (368)	(82)	(114)	(129)	(143)	(139)	(272)	(130)	(149)	(58)	(183)	(467)	(178)	20	(65)	(97)	(102)	48 kg	

Flange Dimensions

Dimensions - Inches (mm)				
DN	ϕD	ϕd_1	ϕk	$n \times d_L$
1.5	6 ^{1/8}	3 ^{9/16}	3 ^{7/8}	4 x 5/8
	(155)	(90)	(99)	(4 x 16)

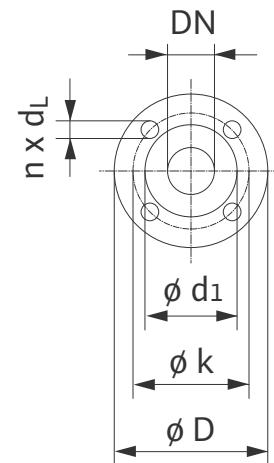

TEFC Motor Data

Model	P2	Phase	Voltage V (A)	Current A (C)
	[HP]	[~]	[V]	[A]
IL 1.5-35/100-4	1	1	115 / 208-230	12.8/6.4
		3	208-230/460	3.7-3.4/1.7
IL 1.5-45/110-4	1.5	1	115 / 208-230	18/8
		3	208-230/460	4.5-4.2/2.1

Submittal Data Sheet

Wilco IL - Inline Centrifugal Circulators



Wilco IL 1.5-55, 1.5-70 1750 RPM



Project:	
Engineer:	
Contractor:	
Submitted By:	Date:
Approved By:	Date:

Tag #	Model #	Flow	Head	HP	Cycle	Phase	Voltage	RPM
					60Hz			1,750 (4 Pole)

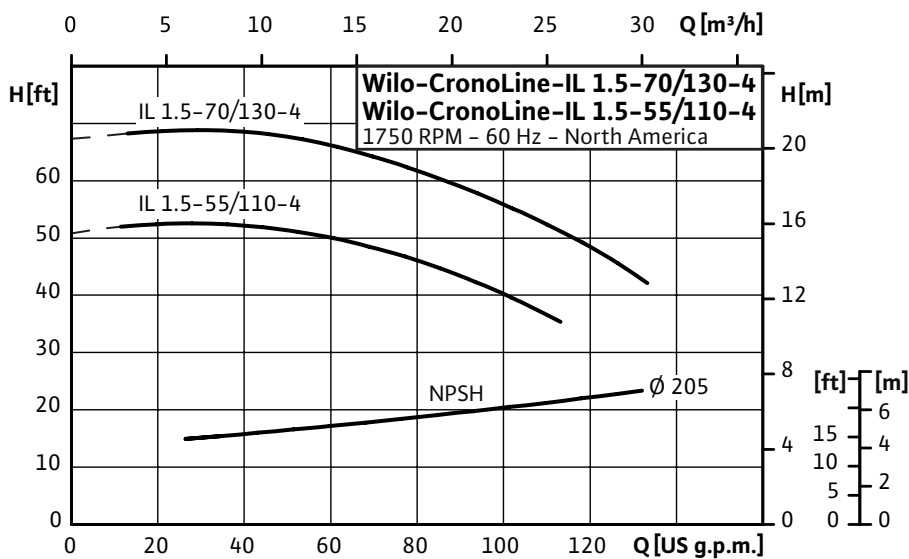

Technical Data	
Temp Range:	-5 °F to + 285 °F (-20 °C to +140 °C)
Power Supply	1-115/208-230 volt 3-208-230/460, 575 volt
Motor Options	TEFC, (ODP Opt), EPACK Rated
Flange Connection	1½" NPT with ¼" pressure gauge tappings
Max operating pressure:	250 PSI (16 bar)

Materials of Construction	
Pump volute	Cast Iron
Impeller	Bronze (cast iron optional)
Shaft	316L stainless steel
Mechanical seal	Q1Q1X4GG (silicium carbide seal faces, HNBR elastomers)

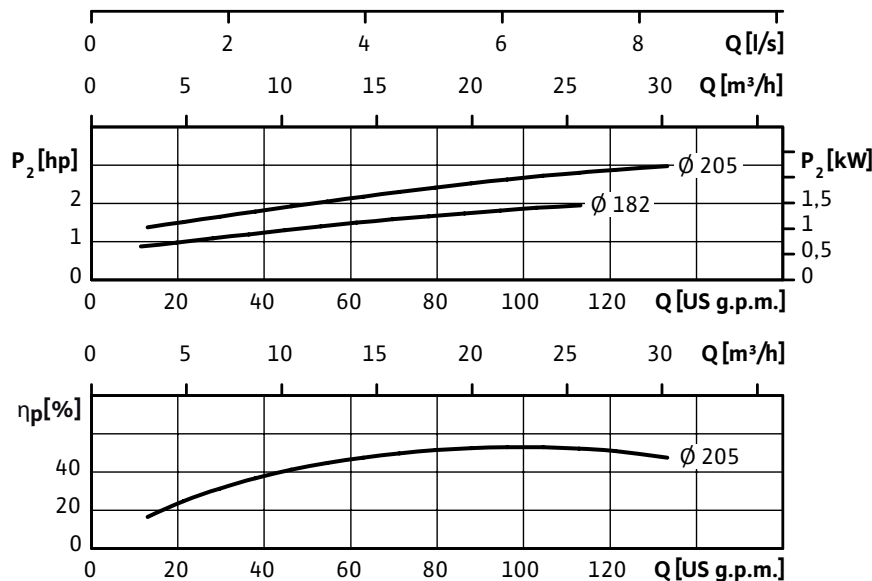

Applications	
• Hot water heating systems	• Industrial circulation systems
• Air conditioning systems	• Solar Systems
• Closed cooling circuits	• Geothermal Systems

Approval Stamp

Submittal Data Sheet

Wilo IL - Inline Centrifugal Circulators



Dimensions & Weights

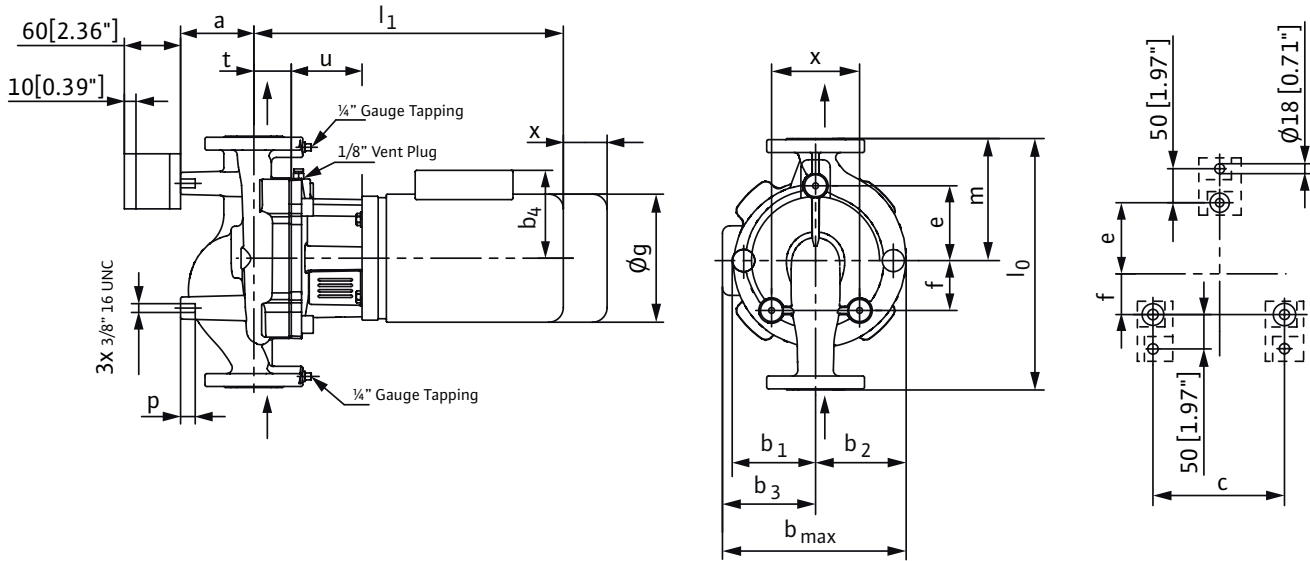

Dimensions and Weights

Model	Dia	Dimensions—inches (mm)																	Weight
		l ₀	a	b ₁	b ₂	b ₃	b ₄	b _{max}	c	e	f	φg	l ₁	m	p	t	u	x	
IL 1.5-55/110-4	1½	17	4 ⁵ / ₁₆	5 ¹¹ / ₁₆	5 ⁷ / ₈	5 ⁵ / ₈	5½	11½	7 ¹ / ₁₆	5 ³ / ₈	3 ¹ / ₁₆	7 ³ / ₁₆	19 ¹ / ₈	8	1 ³ / ₁₆	2 ³ / ₈	4 ¹¹ / ₁₆	4	137 lbs
	1½	(432)	(110)	(145)	(149)	(143)	(140)	(292)	(180)	(137)	(78)	(182)	(485)	(203)	(20)	(60)	(119)	(102)	62 kg
IL 1.5-70/130-4	1½	17	4 ⁵ / ₁₆	5 ¹¹ / ₁₆	5 ⁷ / ₈	5 ⁵ / ₈	-	11½	7 ¹ / ₁₆	5 ³ / ₈	3 ¹ / ₁₆	7 ³ / ₁₆	19 ¹ / ₈	8	1 ³ / ₁₆	2 ³ / ₈	4 ¹¹ / ₁₆	4	141 lbs
	1½	(432)	(110)	(145)	(149)	(143)	-	(292)	(180)	(137)	(78)	(182)	(485)	(203)	(20)	(60)	(119)	(102)	64 kg

Flange Dimensions

Dimensions - Inches (mm)				
DN	φD	φd ₁	φk	n x d _L
1.5	6 ¹ / ₈	3 ⁹ / ₁₆	3 ⁷ / ₈	4 x 5/8
	(155)	(90)	(99)	(4 x 16)

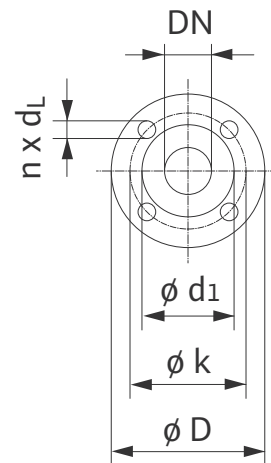

Motor Data

Model	P2	Phase	Voltage	FLA
	[HP]	[~]	[V]	[A]
IL 1.5-55/110-4	2	1	115/208-230	23/11.5
		3	208-230/460	6.5-6.2/3.1
IL 1.5-70/130-4	2	3	208-230/460	8.5-8.2/4.1

WILO USA LLC

Tel: (866) 945-6872 Web: www.wilo-usa.com
 Fax: (708) 338-9455 Email: info@wilo-usa.com

WILO Canada Inc.

Tel: (866) 945-6236 Web: www.wilo-canada.com
 Fax: (403) 277-9456 Email: info@wilo-canada.com

WILO Mexico

Tel: +52 55 5586 3209 Web: www.wilo-mexico.com.mx
 Fax: +52 1 55 5413 4165 Email: info@wilo.com.mx

Submittal Data Sheet

Wilco IL - Inline Centrifugal Circulators



Wilco IL 2-40 1750 RPM



Project:	
Engineer:	
Contractor:	
Submitted By:	Date:
Approved By:	Date:

Tag #	Model #	Flow	Head	HP	Cycle	Phase	Voltage	RPM
					60Hz			1,750 (4 Pole)

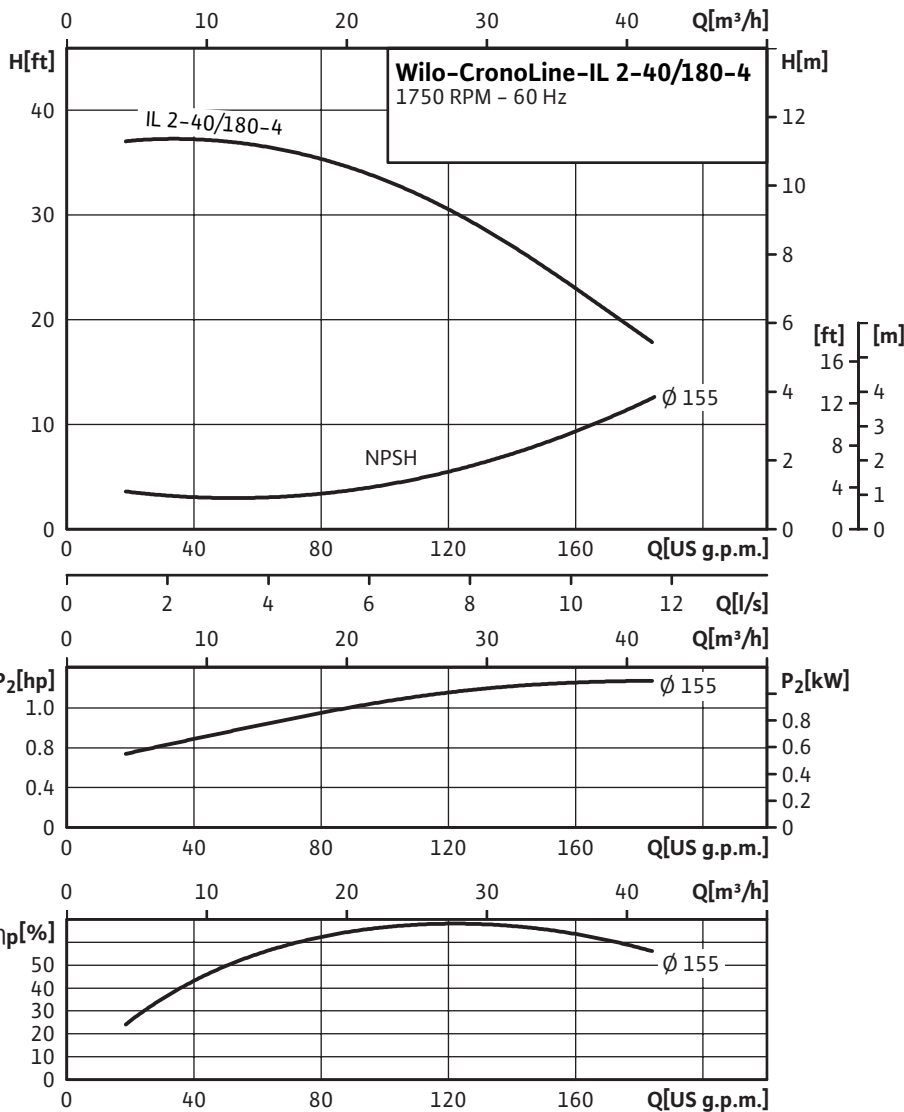

Technical Data	
Temp Range:	-5 °F to +285 °F (-20 °C to +140 °C)
Power Supply	1-115/208-230 volt 3-208-230/460, 575 volt
Motor Options	TEFC, (ODP Opt), EPACT Rated
Flange Connection	2" NPT with ¼" pressure gauge tappings
Max operating pressure:	250 PSI (16 bar)

Materials of Construction	
Pump volute	Cast Iron
Impeller	Bronze (cast iron optional)
Shaft	316L stainless steel
Mechanical seal	Q1Q1X4GG (silicium carbide seal faces, HNBR elastomers)

Applications	
• Hot water heating systems	• Industrial circulation systems
• Air conditioning systems	• Solar Systems
• Closed cooling circuits	• Geothermal Systems

Approval Stamp

Dimensions & Weights

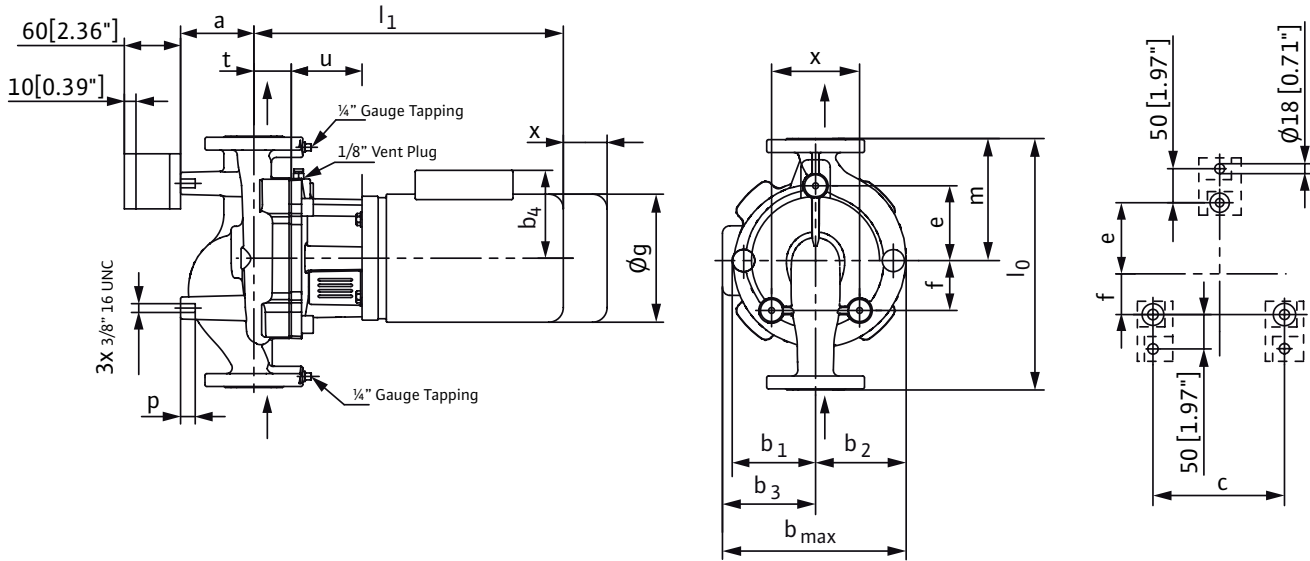

Dimensions and Weights

Model	Dia	Dimensions-inches (mm)																		Weight
		l ₀	a	b ₁	b ₂	b ₃	b ₄	b _{max}	c	e	f	φg	l ₁	m	p	t	u	x		
IL 2-40/180-4	2	15	3 ⁹ / ₁₆	4 ³ / ₄	5 ¹ / ₂	5 ¹ / ₁₆	5 ¹ / ₂	10 ⁹ / ₁₆	6 ⁷ / ₁₆	4 ⁵ / ₈	1 ⁷ / ₈	7 ³ / ₁₆	18 ⁹ / ₁₆	7 ⁵ / ₁₆	1 ³ / ₁₆	2 ¹³ / ₁₆	4 ⁹ / ₁₆	4	115 lbs	
	2	(381)	(90)	(120)	(139)	(129)	(139)	(268)	(164)	(117)	(48)	(183)	(472)	(186)	(20)	(72)	(116)	(102)	52 kg	

Flange Dimensions

Dimensions - Inches (mm)				
DN	φD	φd ₁	φk	n x d _L
2	6 ¹ / ₂	4 ³ / ₁₆	4 ³ / ₄	4 x 3/4
	(165)	(106)	(121)	(4 x 19)

TEFC Motor Data

Model	P2	Phase	Voltage	FLA
	[HP]	[~]	[V]	[A]
IL 2-40/180-4	1.5	1	115 / 208-230	18/8
		3	208-230/460	4.5-4.2/2.1

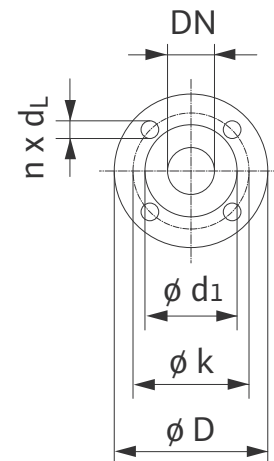

Submittal Data Sheet

Wilco IL - Inline Centrifugal Circulators



Wilco IL 2-45, 2-60 1750 RPM



Project:	
Engineer:	
Contractor:	
Submitted By:	Date:
Approved By:	Date:

Tag #	Model #	Flow	Head	HP	Cycle	Phase	Voltage	RPM
					60Hz			1,750 (4 Pole)

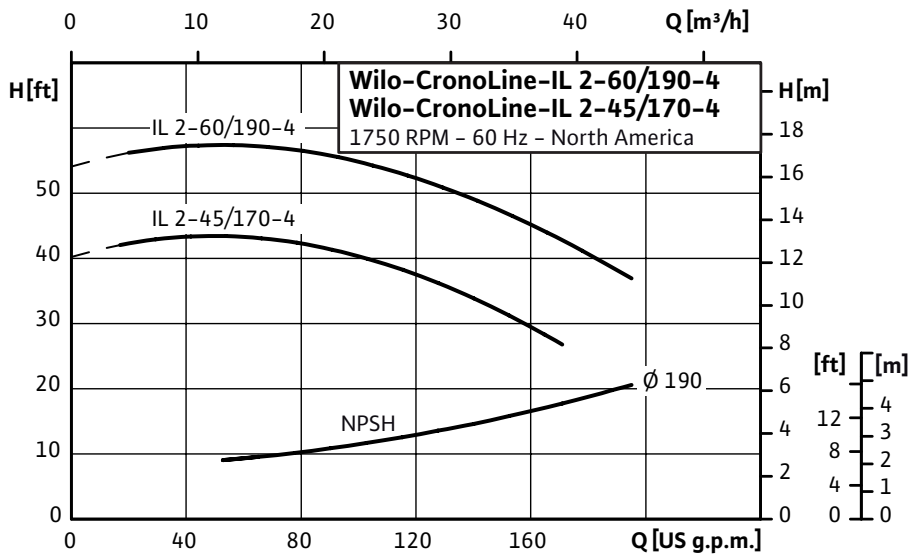

Technical Data	
Temp Range:	-5 °F to + 285 °F (-20 °C to +140 °C)
Power Supply	1-115/208-230 volt 3-208-230/460, 575 volt
Motor Options	TEFC, (ODP Opt), EPACK Rated
Flange Connection	2" NPT with ¼" pressure gauge tappings
Max operating pressure:	250 PSI (16 bar)

Materials of Construction	
Pump volute	Cast Iron
Impeller	Bronze (cast iron optional)
Shaft	316L stainless steel
Mechanical seal	Q1Q1X4GG (silicium carbide seal faces, HNBR elastomers)

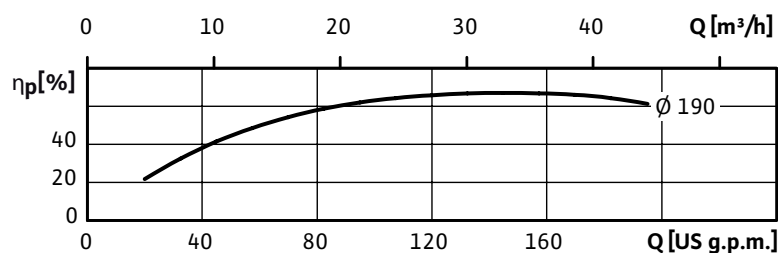
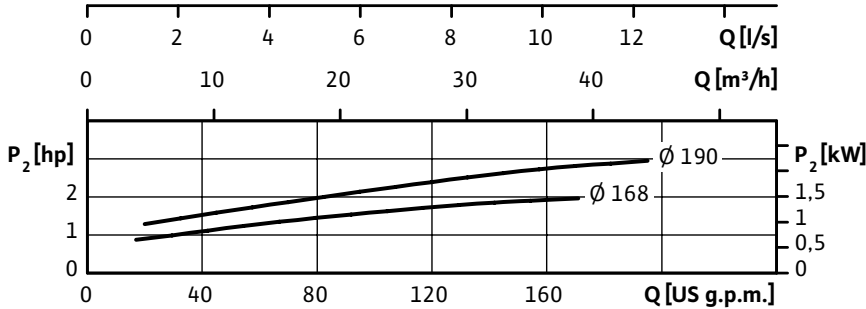

Applications	
• Hot water heating systems	• Industrial circulation systems
• Air conditioning systems	• Solar Systems
• Closed cooling circuits	• Geothermal Systems

Approval Stamp

Submittal Data Sheet

Wilo IL - Inline Centrifugal Circulators



Dimensions & Weights

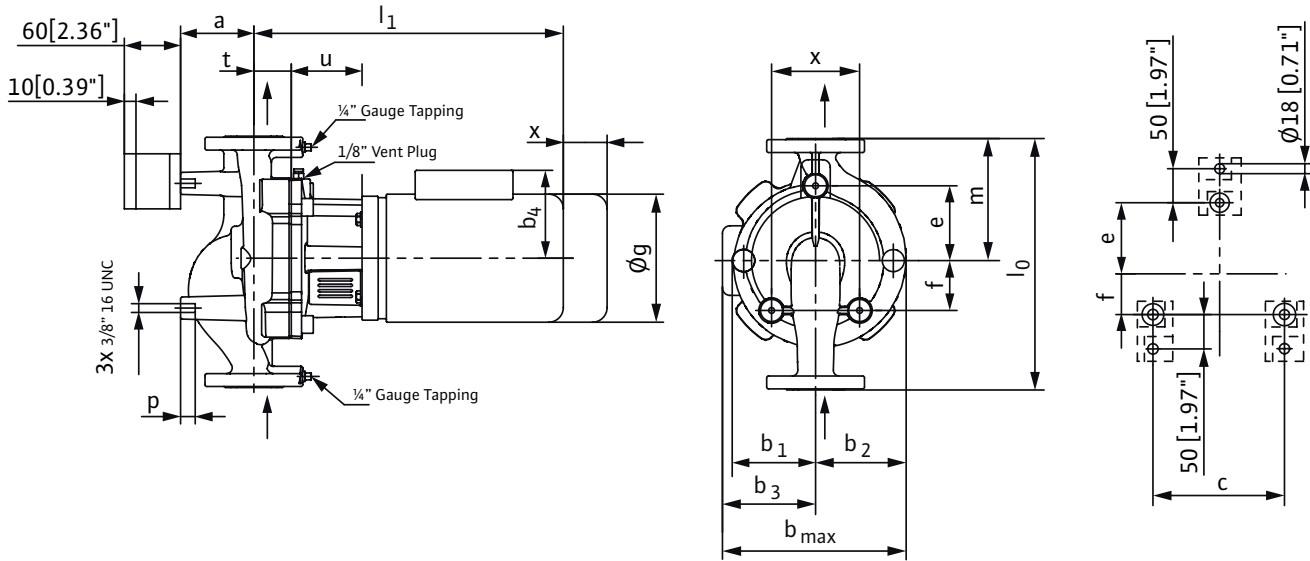

Dimensions and Weights

Model	Dia	Dimensions-inches (mm)																	Weight
		l_0	a	b_1	b_2	b_3	b_4	b_{max}	c	e	f	ϕg	l_1	m	p	t	u	x	
IL 2-45/170-4	2	17½	4¾	5 ^{11/16}	5 ^{7/8}	5 ^{5/8}	5½	11½	6 ^{5/16}	5 ^{3/16}	2¾	7 ^{3/16}	19 ^{1/8}	7 ^{15/16}	1 ^{3/16}	2 ^{3/8}	4 ^{11/16}	4	143 lbs
	2	(444)	(120)	(145)	(150)	(143)	(140)	(293)	(160)	(132)	(70)	(182)	(486)	(202)	(20)	(61)	(119)	(102)	65 kg
IL 2-60/190-4	2	17½	4¾	5 ^{11/16}	5 ^{7/8}	5 ^{5/8}	-	11½	6 ^{5/16}	5 ^{3/16}	2¾	7 ^{3/16}	19 ^{1/8}	7 ^{15/16}	1 ^{3/16}	2 ^{3/8}	4 ^{11/16}	4	148 lbs
	2	(444)	(120)	(145)	(150)	(143)	-	(293)	(160)	(132)	(70)	(182)	(486)	(202)	(20)	(61)	(119)	(102)	67 kg

Flange Dimensions

Dimensions - Inches (mm)				
DN	ϕD	ϕd_1	ϕk	$n \times d_L$
2	6½	4 ^{3/16}	4¾	4 x ¾
	(165)	(106)	(121)	(4 x 19)

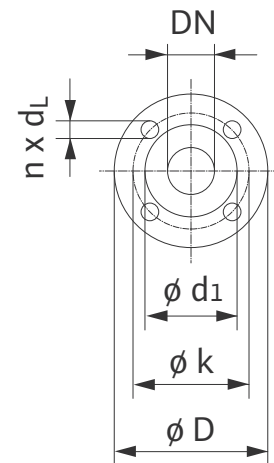

TEFC Motor Data

Model	P2	Phase	Voltage	FLA
	[HP]	[~]	[V]	[A]
IL 2-45/170-4	2	1	115 / 208-230	23/11.5
		3	208-230/460	6.5-6.2/3.1
IL 2-60/190-4	3	3	208-230/460	8.5-8.2/4.1

WILO USA LLC

Tel: (866) 945-6872 Web: www.wilo-usa.com
 Fax: (708) 338-9455 Email: info@wilo-usa.com

WILO Canada Inc.

Tel: (866) 945-6236 Web: www.wilo-canada.com
 Fax: (403) 277-9456 Email: info@wilo-canada.com

WILO Mexico

Tel: +52 55 5586 3209 Web: www.wilo-mexico.com.mx
 Fax: +52 1 55 5413 4165 Email: info@wilo.com.mx

Submittal Data Sheet

Wilo IL - Inline Centrifugal Circulators



Wilo IL 2.5-35, 2.5-45 1750 RPM



Project:	
Engineer:	
Contractor:	
Submitted By:	Date:
Approved By:	Date:

Tag #	Model #	Flow	Head	HP	Cycle	Phase	Voltage	RPM
					60Hz			1,750 (4 Pole)

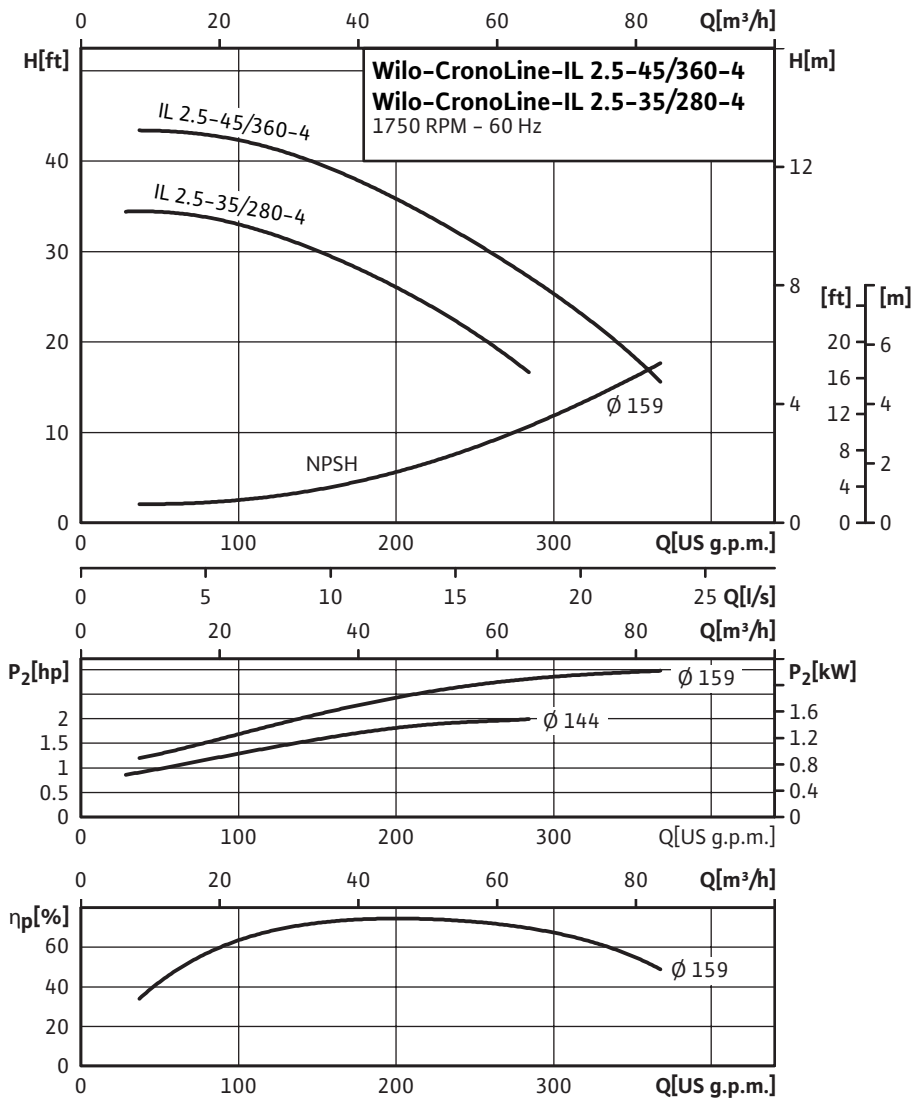

Technical Data	
Temp Range:	-5 °F to +285 °F (-20 °C to +140 °C)
Power Supply	1-115/208-230 volt 3-208-230/460, 575 volt
Motor Options	TEFC, (ODP Opt), EPACK Rated
Flange Connection	2½" NPT with ¼" pressure gauge tappings
Max operating pressure:	250 PSI (16 bar)

Materials of Construction	
Pump volute	Cast Iron
Impeller	Bronze (cast iron optional)
Shaft	316L stainless steel
Mechanical seal	Q1Q1X4GG (silicium carbide seal faces, HNBR elastomers)

Applications	
• Hot water heating systems	• Industrial circulation systems
• Air conditioning systems	• Solar Systems
• Closed cooling circuits	• Geothermal Systems

Approval Stamp

Dimensions & Weights

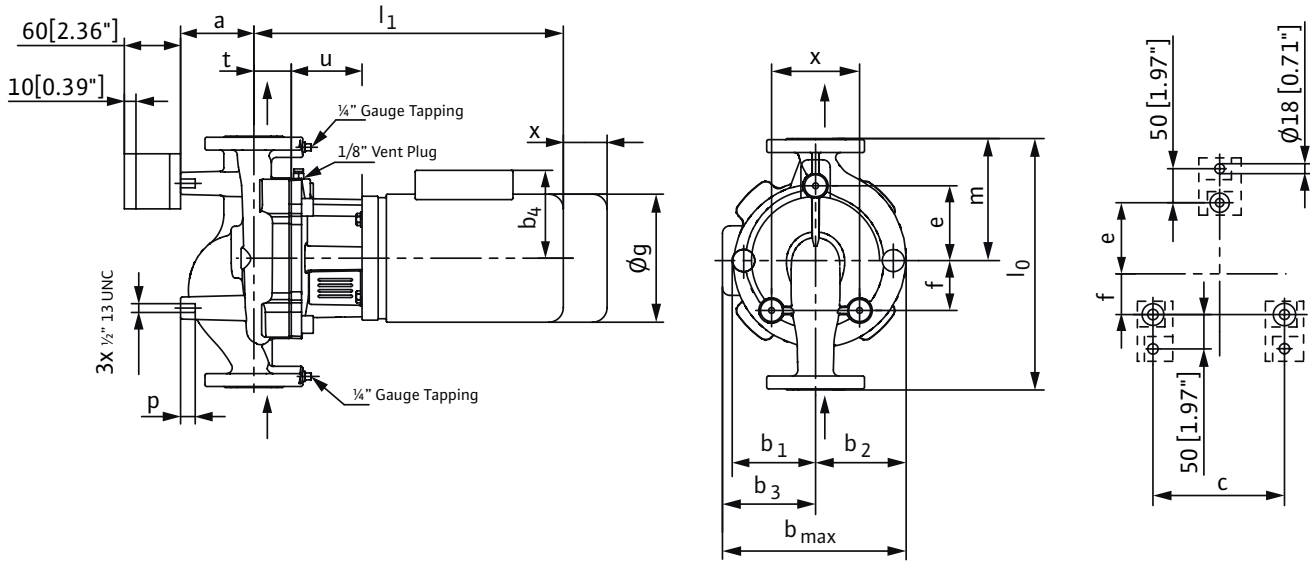

Dimensions and Weights

Model	Dia	Dimensions-inches (mm)																	Weight
		l_0	a	b_1	b_2	b_3	b_4	b_{max}	c	e	f	ϕg	l_1	m	p	t	u	x	
IL 2.5-35/280-4	2½	17½	4 ⁵ / ₁₆	5	5 ¹³ / ₁₆	5 ⁵ / ₈	-	11 ³ / ₈	7 ¹ / ₁₆	5½	2 ³ / ₈	7 ³ / ₁₆	19 ¹¹ / ₁₆	8½	1 ³ / ₁₆	3 ¹ / ₁₆	4 ⁹ / ₁₆	5	137 lbs
	2½	(445)	(110)	(127)	(147)	(143)	-	(290)	(180)	(140)	(60)	(182)	(500)	(216)	(20)	(78)	(116)	(127)	62 kg
IL 2.5-45/360-4	2½	17½	4 ⁵ / ₁₆	5	5 ¹³ / ₁₆	5 ⁵ / ₈	-	11 ³ / ₈	7 ¹ / ₁₆	5½	2 ³ / ₈	7 ³ / ₁₆	19 ¹¹ / ₁₆	8½	1 ³ / ₁₆	3 ¹ / ₁₆	4 ⁹ / ₁₆	5	143 lbs
	2½	(445)	(110)	(127)	(147)	(143)	-	(290)	(180)	(140)	(60)	(182)	(500)	(216)	(20)	(78)	(116)	(127)	65 kg

Flange Dimensions

Dimensions - Inches (mm)				
DN	ϕD	ϕd_1	ϕk	$n \times d_L$
2.5	4 ⁵ / ₁₆	4 ¹⁵ / ₁₆	5½	4 x ¾
	(110)	(126)	(140)	(4 x 19)

Motor Data

Model	P2	Phase	Voltage	FLA
	[HP]	[~]	[V]	[A]
IL 2.5-35/280-4	2	1	115 / 208-230	23/11.5
		3	208-230/460	6.5-6.2/3.1
IL 2.5-45/360-4	3	3	208-230/460	8.5-8.2/4.1

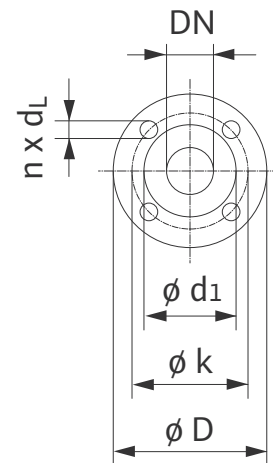

Submittal Data Sheet

Wilo IL - Inline Centrifugal Circulators



Wilo IL 3-35, 3-40 1750 RPM



Project:	
Engineer:	
Contractor:	
Submitted By:	Date:
Approved By:	Date:

Tag #	Model #	Flow	Head	HP	Cycle	Phase	Voltage	RPM
					60Hz			1,750 (4 Pole)

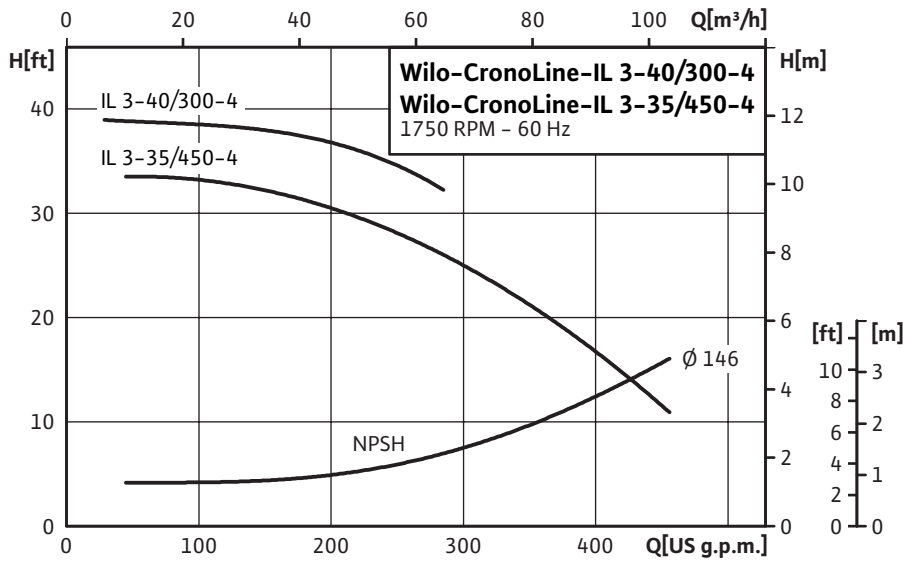

Technical Data	
Temp Range:	-5 °F to +285 °F (-20 °C to +140 °C)
Power Supply	3-208-230/460, 575 volt
Motor Options	TEFC, (ODP Opt), EPACT Rated
Flange Connection	3" NPT with 1/4" pressure gauge tappings
Max operating pressure:	250 PSI (16 bar)

Materials of Construction	
Pump volute	Cast Iron
Impeller	Bronze (cast iron optional)
Shaft	316L stainless steel
Mechanical seal	Q1Q1X4GG (silicium carbide seal faces, HNBR elastomers)

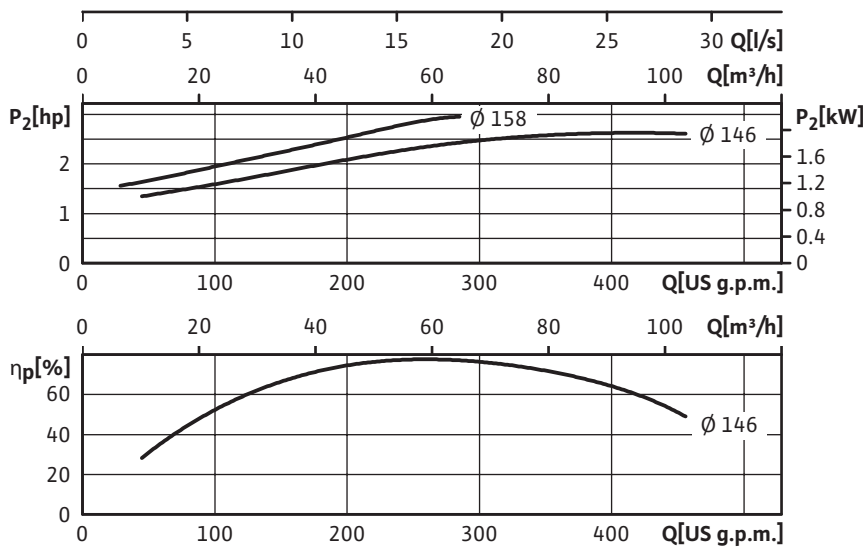

Applications	
• Hot water heating systems	• Industrial circulation systems
• Air conditioning systems	• Solar Systems
• Closed cooling circuits	• Geothermal Systems

Approval Stamp

Dimensions & Weights

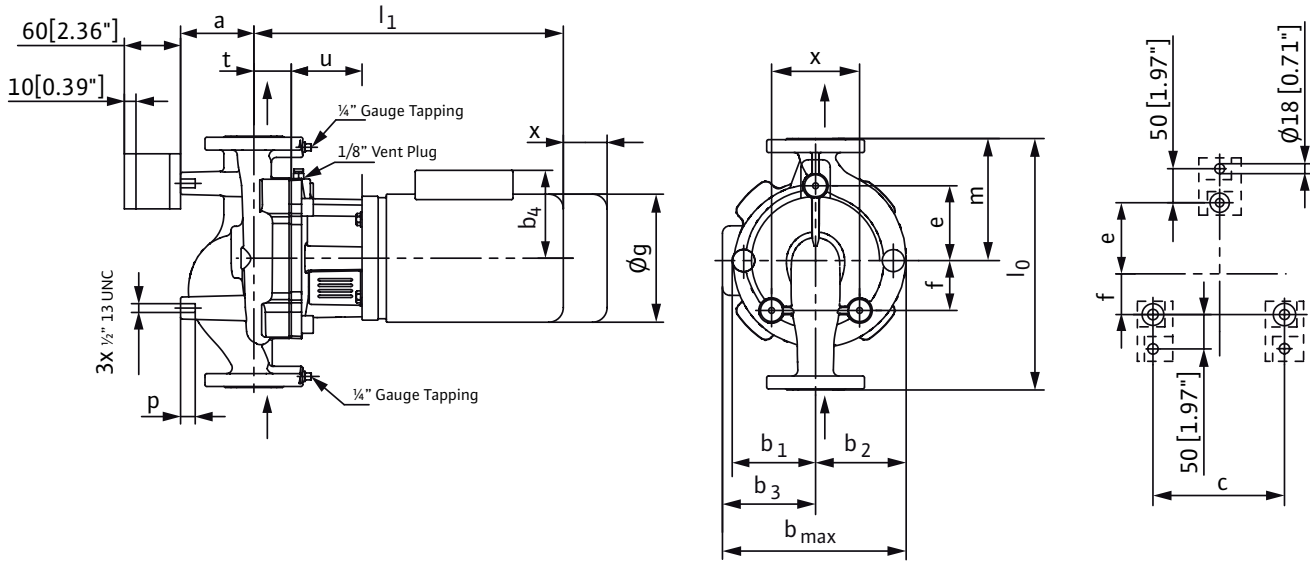

Dimensions and Weights

Model	Dia	Dimensions—inches (mm)																	Weight
		l_0	a	b_1	b_2	b_3	b_4	b_{max}	c	e	f	ϕg	l_1	m	p	t	u	x	
IL 3-35/450-4	3	19	$4^{13/16}$	$5^{3/8}$	$6^{3/8}$	$5^{5/8}$	-	12	$7^{1/16}$	$5^{1/16}$	$2^{13/16}$	$7^{3/16}$	$19^{15/16}$	$8^{9/16}$	$1^{3/16}$	$2^{15/16}$	$4^{15/16}$	5	165 lbs
	3	(483)	(123)	(136)	(162)	(143)	-	(305)	(180)	(128)	(72)	(182)	(507)	(218)	(20)	(75)	(125)	(127)	75 kg
IL 3-40/300-4	3	19	$4^{13/16}$	$5^{3/8}$	$6^{3/8}$	$5^{5/8}$	-	12	$7^{1/16}$	$5^{1/16}$	$2^{13/16}$	$7^{3/16}$	$19^{15/16}$	$8^{9/16}$	$1^{3/16}$	$2^{15/16}$	$4^{15/16}$	5	165 lbs
	3	(483)	(123)	(136)	(162)	(143)	-	(305)	(180)	(128)	(72)	(182)	(507)	(218)	(20)	(75)	(125)	(127)	75 kg

Flange Dimensions

Dimensions - Inches (mm)				
DN	ϕD	ϕd_1	ϕk	$n \times d_L$
3	$8\frac{1}{4}$	$5^{11/16}$	6	$4 \times \frac{3}{4}$
	(210)	(145)	(152)	(4 x 19)

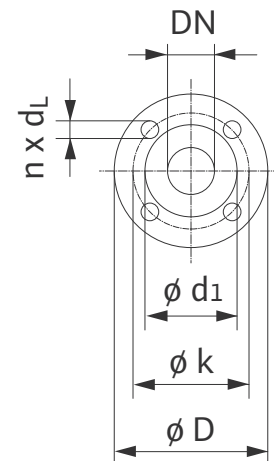

TEFC Motor Data

Model	P2	Phase	Voltage	FLA
	[HP]	[-]	[V]	[A]
IL 3-35/450-4	3	3	208-230/460	8.5-8.2/4.1
IL 3-40/300-4.S1	3	3	208-230/460	8.5-8.2/4.1

Submittal Data Sheet

Wilco IL - Inline Centrifugal Circulators



Wilco IL 3-60 1750 RPM



Project:	
Engineer:	
Contractor:	
Submitted By:	Date:
Approved By:	Date:

Tag #	Model #	Flow	Head	HP	Cycle	Phase	Voltage	RPM
					60Hz			1,750 (4 Pole)

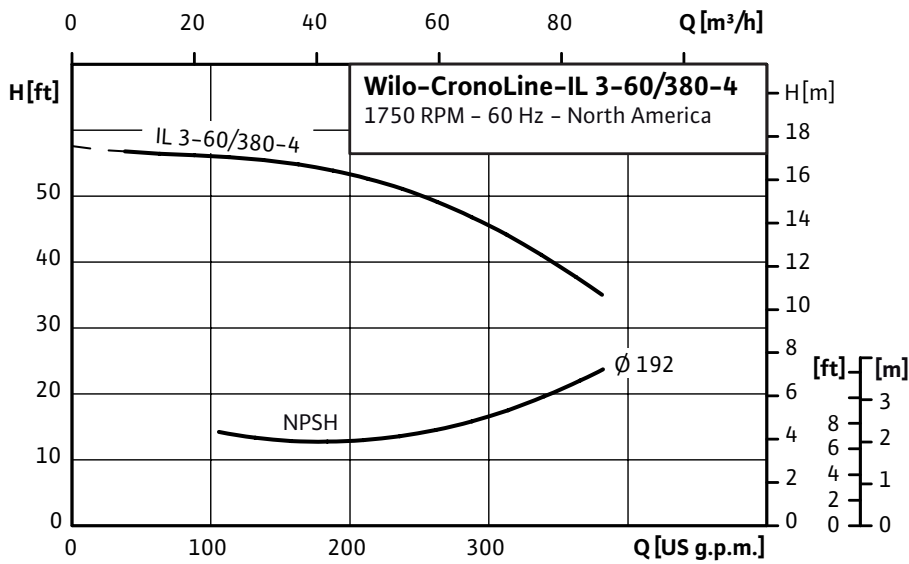

Technical Data	
Temp Range:	-5 °F to + 285 °F (-20 °C to +140 °C)
Power Supply	3-208-230/460, 575 volt
Motor Options	TEFC, (ODP Opt), EPACK Rated
Flange Connection	3" NPT with 1/4" pressure gauge tapings
Max operating pressure:	250 PSI (16 bar)

Materials of Construction	
Pump volute	Cast Iron
Impeller	Bronze (cast iron optional)
Shaft	316L stainless steel
Mechanical seal	Q1Q1X4GG (silicium carbide seal faces, HNBR elastomers)

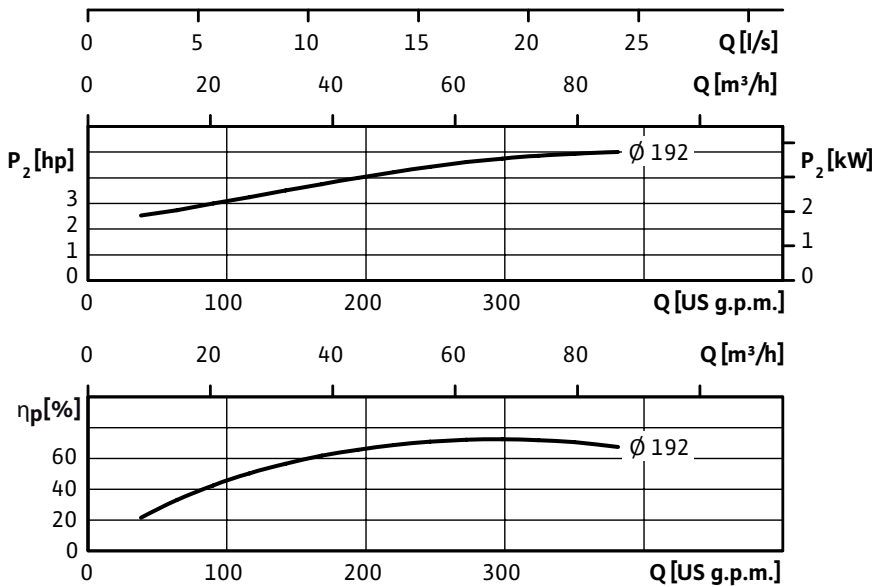

Applications	
• Hot water heating systems	• Industrial circulation systems
• Air conditioning systems	• Solar Systems
• Closed cooling circuits	• Geothermal Systems

Approval Stamp

Dimensions & Weights

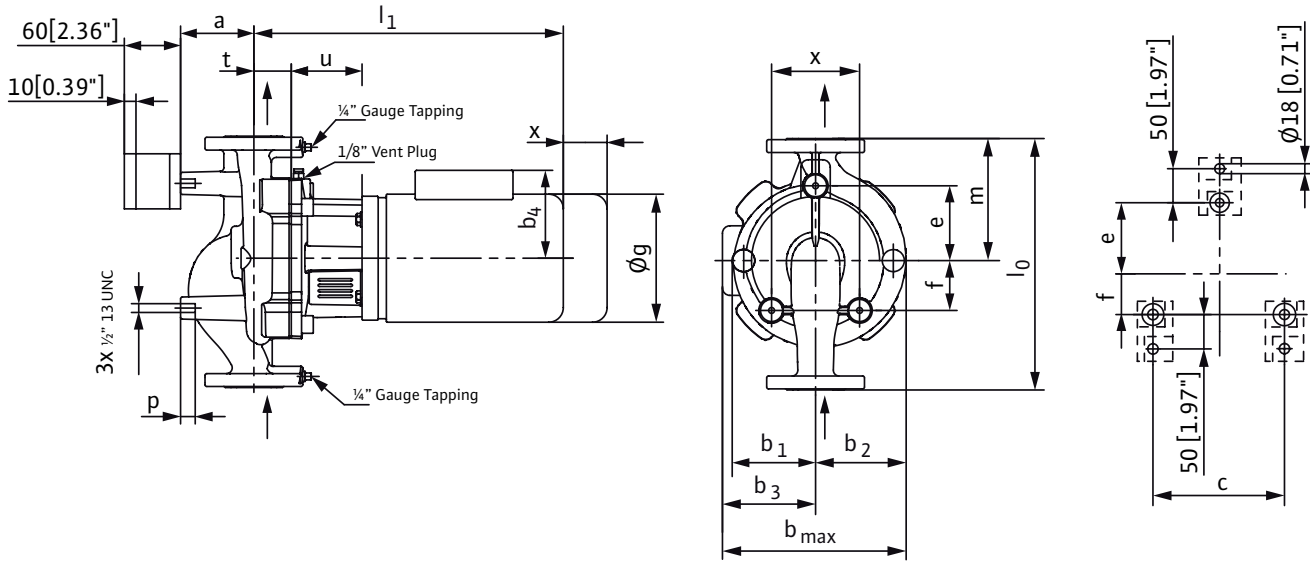

Dimensions and Weights

Model	Dia	Dimensions-inches (mm)													Weight				
		l ₀	a	b ₁	b ₂	b ₃	b ₄	b _{max}	c	e	f	φg	l ₁	m		p	t	u	x
IL 3-60/380-4	3	21	5 ^{11/16}	6 ^{3/16}	7 ^{3/16}	6 ^{7/8}	-	14 ^{1/16}	8 ^{11/16}	6 ^{11/16}	2 ^{7/16}	8 ^{5/8}	23	9 ^{11/16}	1 ^{3/16}	3 ^{1/16}	6	5	216 lbs
	3	(533)	(145)	(157)	(182)	(175)	-	(357)	(220)	(170)	(62)	(218)	(585)	(246)	(20)	(78)	(153)	(127)	98 kg

Flange Dimensions

Dimensions - Inches (mm)				
DN	φD	φd ₁	φk	n x d _L
3	8 ^{1/4}	5 ^{11/16}	6	4 x 3/4
	(210)	(145)	(152)	(4 x 19)

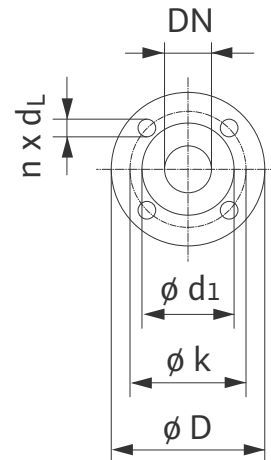

TEFC Motor Data

Model	P2	Phase	Voltage	FLA
	[HP]	[-]	[V]	[A]
IL 3-60/380-4	5	3	208-230/460	15-13.2/6.6

Submittal Data Sheet

Wilco IL - Inline Centrifugal Circulators



Wilco IL 4-25 1750 RPM



Project:	
Engineer:	
Contractor:	
Submitted By:	Date:
Approved By:	Date:

Tag #	Model #	Flow	Head	HP	Cycle	Phase	Voltage	RPM
					60Hz			1,750 (4 Pole)

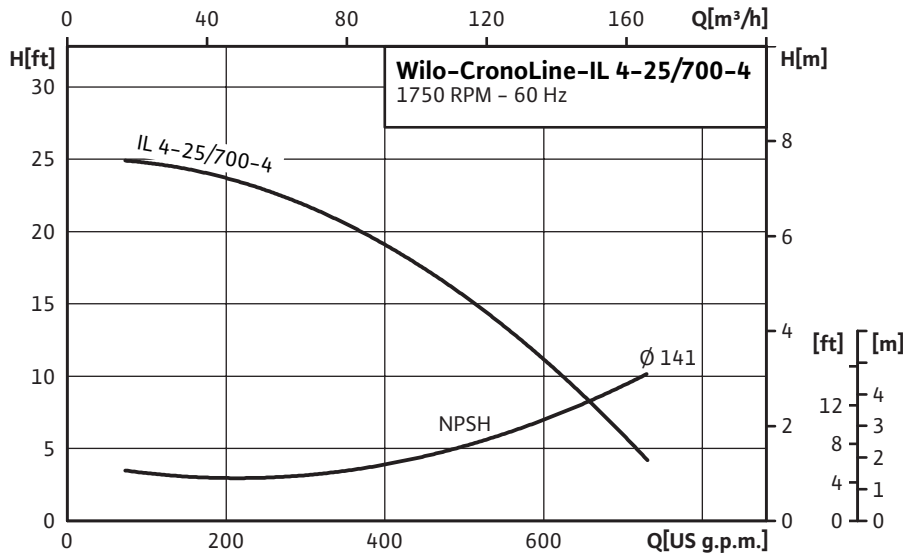

Technical Data	
Temp Range:	-5 °F to +285 °F (-20 °C to +140 °C)
Power Supply	3-208-230/460, 575 volt
Motor Options	TEFC, (ODP Opt), EPACT Rated
Flange Connection	4" NPT with ¼" pressure gauge tappings
Max operating pressure:	250 PSI (16 bar)

Materials of Construction	
Pump volute	Cast Iron
Impeller	Bronze (cast iron optional)
Shaft	316L stainless steel
Mechanical seal	Q1Q1X4GG (silicium carbide seal faces, HNBR elastomers)

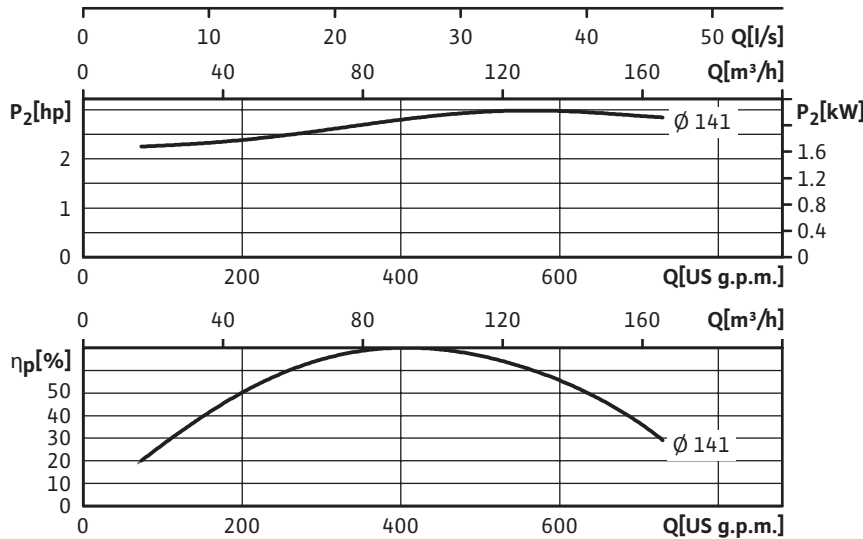

Applications	
• Hot water heating systems	• Industrial circulation systems
• Air conditioning systems	• Solar Systems
• Closed cooling circuits	• Geothermal Systems

Approval Stamp

Dimensions & Weights

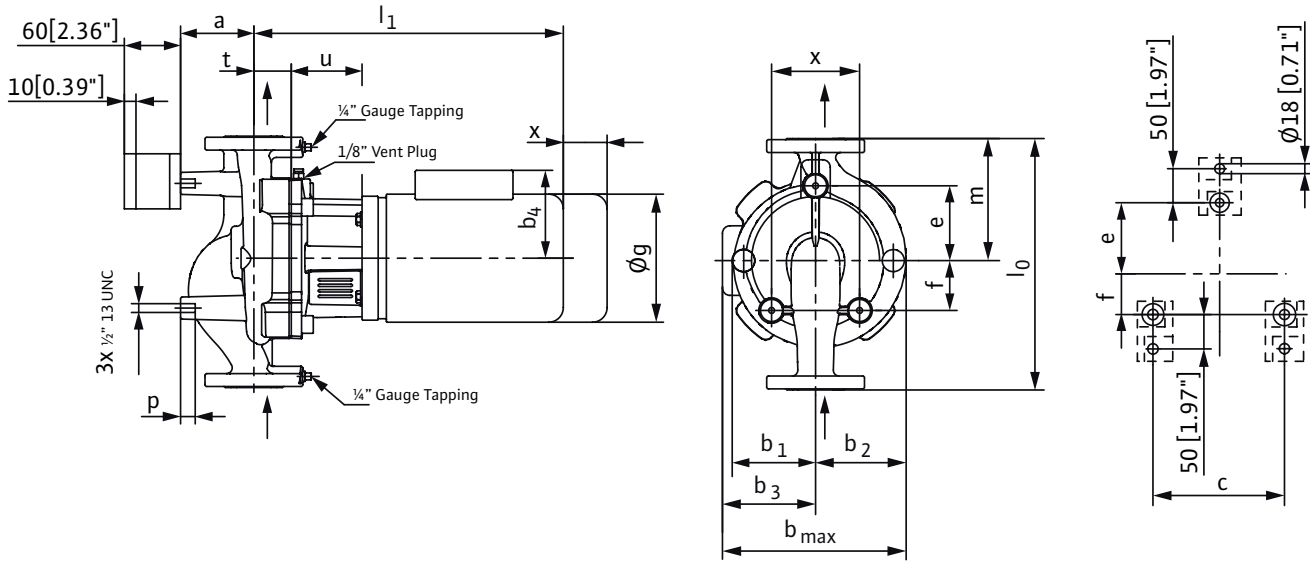

Dimensions and Weights

Model	Dia	Dimensions-inches (mm)																	Weight
		l_0	a	b_1	b_2	b_3	b_4	b_{max}	c	e	f	ϕg	l_1	m	p	t	u	x	
IL 4-25/700-4	4	$20\frac{1}{2}$	$5\frac{3}{16}$	$6\frac{1}{4}$	$7\frac{11}{16}$	$5\frac{5}{8}$	-	$13\frac{5}{16}$	$7\frac{7}{8}$	$9\frac{3}{16}$	$2\frac{3}{8}$	$7\frac{3}{16}$	$21\frac{5}{16}$	$10\frac{5}{16}$	$1\frac{3}{16}$	$4\frac{5}{16}$	$4\frac{15}{16}$	6	203 lbs
	4	(521)	(132)	(158)	(196)	(143)	-	(339)	(200)	(234)	(60)	(182)	(541)	(262)	(20)	(110)	(125)	(152)	92 kg

Flange Dimensions

Dimensions - Inches (mm)				
DN	ϕD	ϕd_1	ϕk	$n \times d_L$
4	10	$6\frac{15}{16}$	$7\frac{1}{2}$	$8 \times \frac{3}{4}$
	(254)	(176)	(191)	(8 x 19)

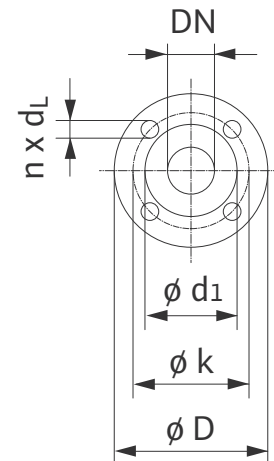

TEFC Motor Data

Model	P2	Phase	Voltage	FLA
	[HP]	[~]	[V]	[A]
IL 4-25/700-4	3	3	208-230/460	8.5-8.2/4.1

Submittal Data Sheet

Wilo IL - Inline Centrifugal Circulators



Wilo IL 4-55 1750 RPM



Project:	
Engineer:	
Contractor:	
Submitted By:	Date:
Approved By:	Date:

Tag #	Model #	Flow	Head	HP	Cycle	Phase	Voltage	RPM
					60Hz			1,750 (4 Pole)

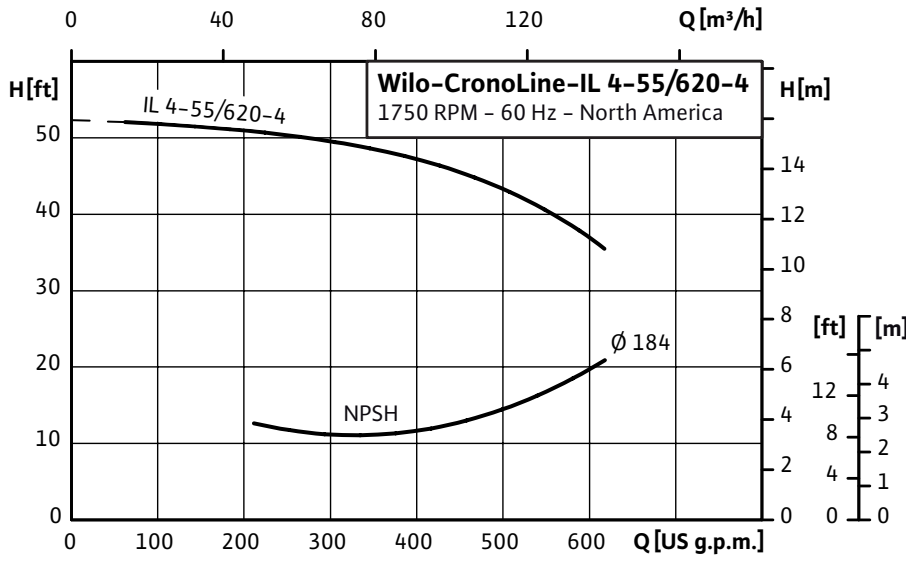

Technical Data	
Temp Range:	-5 °F to +285 °F (-20 °C to +140 °C)
Power Supply	3-208-230/460, 575 volt
Motor Options	TEFC, (ODP Opt), EPACK Rated
Flange Connection	4" NPT with 1/4" pressure gauge tapings
Max operating pressure:	250 PSI (16 bar)

Materials of Construction	
Pump volute	Cast Iron
Impeller	Bronze (cast iron optional)
Shaft	316L stainless steel
Mechanical seal	Q1Q1X4GG (silicium carbide seal faces, HNBR elastomers)

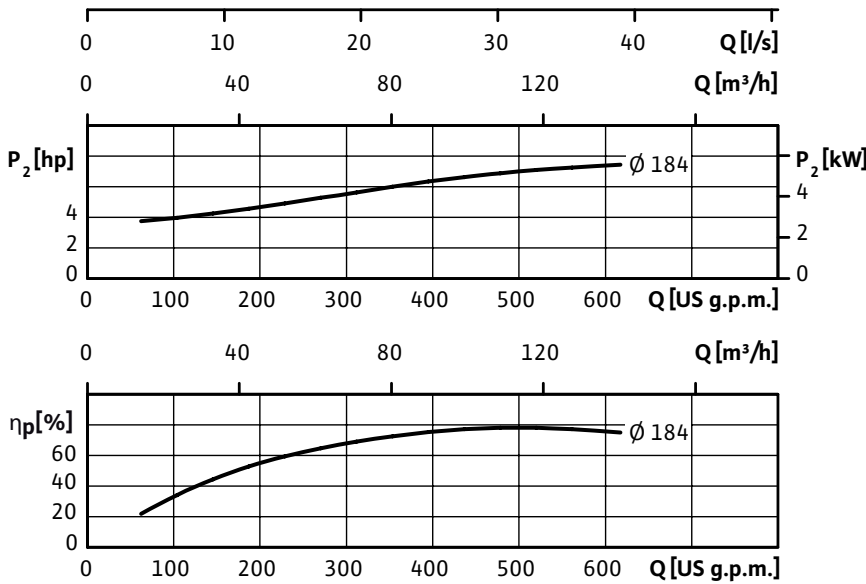

Applications	
• Hot water heating systems	• Industrial circulation systems
• Air conditioning systems	• Solar Systems
• Closed cooling circuits	• Geothermal Systems

Approval Stamp

Dimensions & Weights

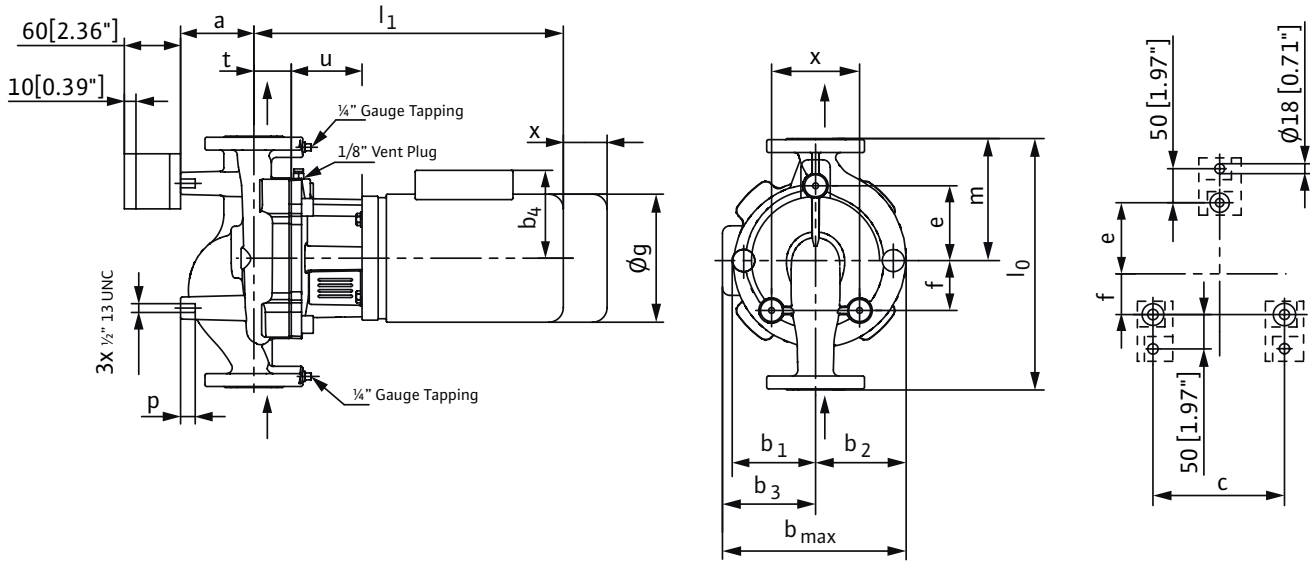

Dimensions and Weights

Model	Dia	Dimensions—inches (mm)																	Weight
		l ₀	a	b ₁	b ₂	b ₃	b ₄	b _{max}	c	e	f	øg	l ₁	m	p	t	u	x	
IL 4-55/620-4	4	22	6 1/8	6 13/16	7 15/16	7 15/16	-	15 7/8	8 11/16	9 3/16	3 7/8	-	25 15/16	10 3/16	13/16	3 7/16	6	5	287 lbs
	4	(559)	(155)	(173)	(202)	(201)	-	(403)	(220)	(233)	(99)	-	(659)	(260)	(20)	(88)	(153)	(127)	130 kg

Flange Dimensions

Dimensions - Inches (mm)				
DN	øD	ød ₁	øk	n x d _L
4	10	6 15/16	7 1/2	8 x 3/4
	(254)	(176)	(191)	(8 x 19)

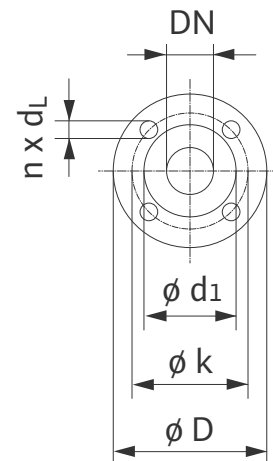

TEFC Motor Data

Model	P2	Phase	Voltage V (A)	Current A (C)
	[HP]	[~]	[V]	[A]
IL 4-55/620-4	7.50	3	208-230/460	21.4/10.7

Submittal Data Sheet

Wilo IL - Inline Centrifugal Circulators



Wilo IL 1.5-120, 1.5-150 3500 RPM



Project:								
Engineer:								
Contractor:								
Submitted By:					Date:			
Approved By:					Date:			

Tag #	Model #	Flow	Head	HP	Cycle	Phase	Voltage	RPM
					60Hz			3,500 (2 Pole)

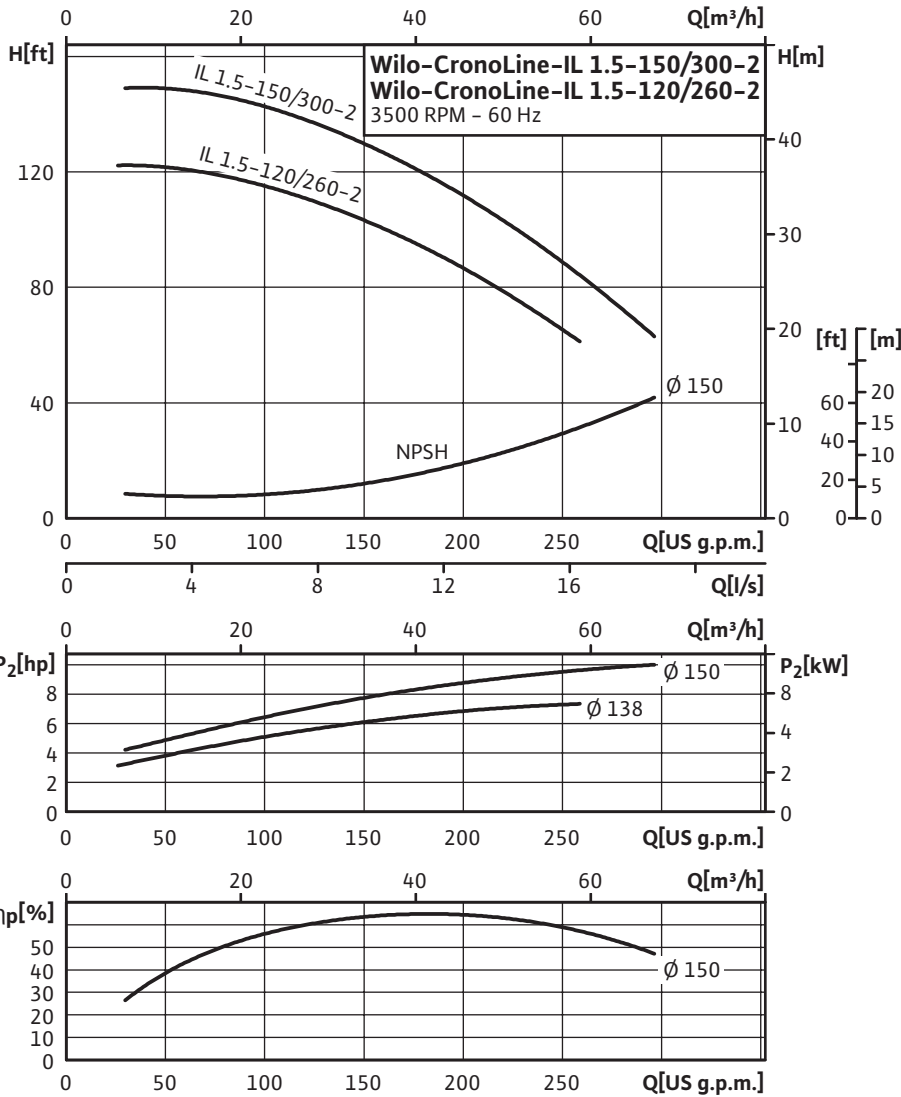

Technical Data

Temp Range:	-5 °F to +285 °F (-20 °C to +140 °C)
Power Supply	3-208-230/460, 575 volt
Motor Options	TEFC, (ODP Opt), EPACK Rated
Flange Connection	1½" NPT with ¼" pressure gauge tappings
Max operating pressure:	250 PSI (16 bar)

Materials of Construction

Pump volute	Cast Iron
Impeller	Bronze (cast iron optional)
Shaft	316L stainless steel
Mechanical seal	Q1Q1X4GG (silicium carbide seal faces, HNBR elastomers)

Applications

• Hot water heating systems	• Industrial circulation systems
• Air conditioning systems	• Solar Systems
• Closed cooling circuits	• Geothermal Systems

Approval Stamp

Submittal Data Sheet

Wilo IL - Inline Centrifugal Circulators



Dimensions & Weights

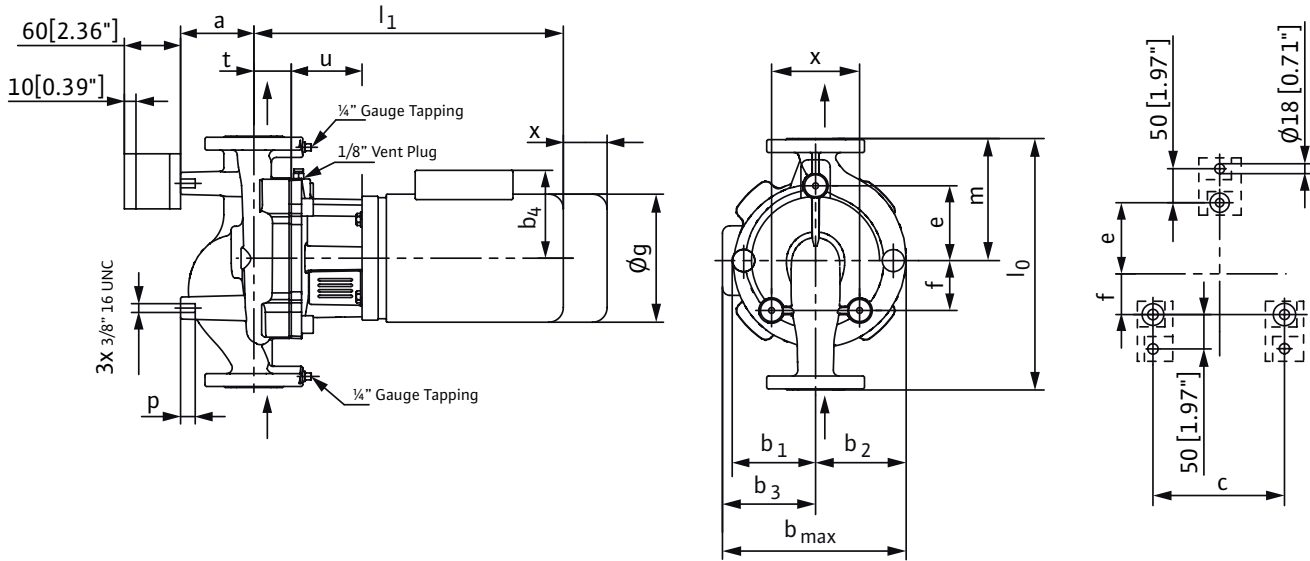

Dimensions and Weights

Model	Dia	Dimensions-inches (mm)																	Weight
		l_0	a	b_1	b_2	b_3	b_4	b_{max}	c	e	f	ϕg	l_1	m	p	t	u	x	
IL 1.5-120/260-2	1½	14½	¾	4½	5 ¹ / ₁₆	6 ⁷ / ₈	-	11 ¹⁵ / ₁₆	5 ¹ / ₈	5 ⁷ / ₈	2 ⁵ / ₁₆	8 ⁵ / ₈	22 ¹ / ₈	7	1 ³ / ₁₆	2 ⁹ / ₁₆	4 ³ / ₁₆	4	157 lbs
	1½	(368)	(82)	(114)	(129)	(175)	-	(304)	(130)	(149)	(58)	(218)	(563)	(178)	(20)	(65)	(107)	(102)	71 kg
IL 1.5-150/300-2	1½	14½	¾	4½	5 ¹ / ₁₆	7 ¹⁵ / ₁₆	-	13	5 ¹ / ₈	5 ⁷ / ₈	2 ⁵ / ₁₆	10 ³ / ₁₆	23 ⁹ / ₁₆	7	1 ³ / ₁₆	2 ⁹ / ₁₆	4 ³ / ₁₆	4	183 lbs
	1½	(368)	(82)	(114)	(129)	(201)	-	(330)	(130)	(149)	(58)	(259)	(598)	(178)	(20)	(65)	(107)	(102)	83 kg

Flange Dimensions

Dimensions - Inches (mm)				
DN	ϕD	ϕd_1	ϕk	$n \times d_L$
1.5	6 ¹ / ₈	3 ⁹ / ₁₆	3 ⁷ / ₈	4 x 5/8
	(155)	(90)	(99)	(4 x 16)

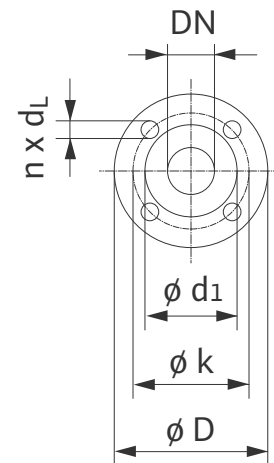

TEFC Motor Data

Model	P2	Phase	Voltage	FLA
	[HP]	[~]	[V]	[A]
IL 1.5-20/260-2	7.50	3	208-230/460	18-17.2/8.6
IL 1.5-130/200-2	7.50	3	208-230/460	18-17.2/8.6

WILO USA LLC

Tel: (866) 945-6872 Web: www.wilo-usa.com
Fax: (708) 338-9455 Email: info@wilo-usa.com

WILO Canada Inc.

Tel: (866) 945-6236 Web: www.wilo-canada.com
Fax: (403) 277-9456 Email: info@wilo-canada.com

WILO Mexico

Tel: +52 55 5586 3209 Web: www.wilo-mexico.com.mx
Fax: +52 1 55 5413 4165 Email: info@wilo.com.mx

Submittal Data Sheet

Wilco IL - Inline Centrifugal Circulators



Wilco IL 1.5-130, 1.5-150, 1.5-210 3500 RPM



Project:	
Engineer:	
Contractor:	
Submitted By:	Date:
Approved By:	Date:

Tag #	Model #	Flow	Head	HP	Cycle	Phase	Voltage	RPM
					60Hz			3,500 (2 Pole)

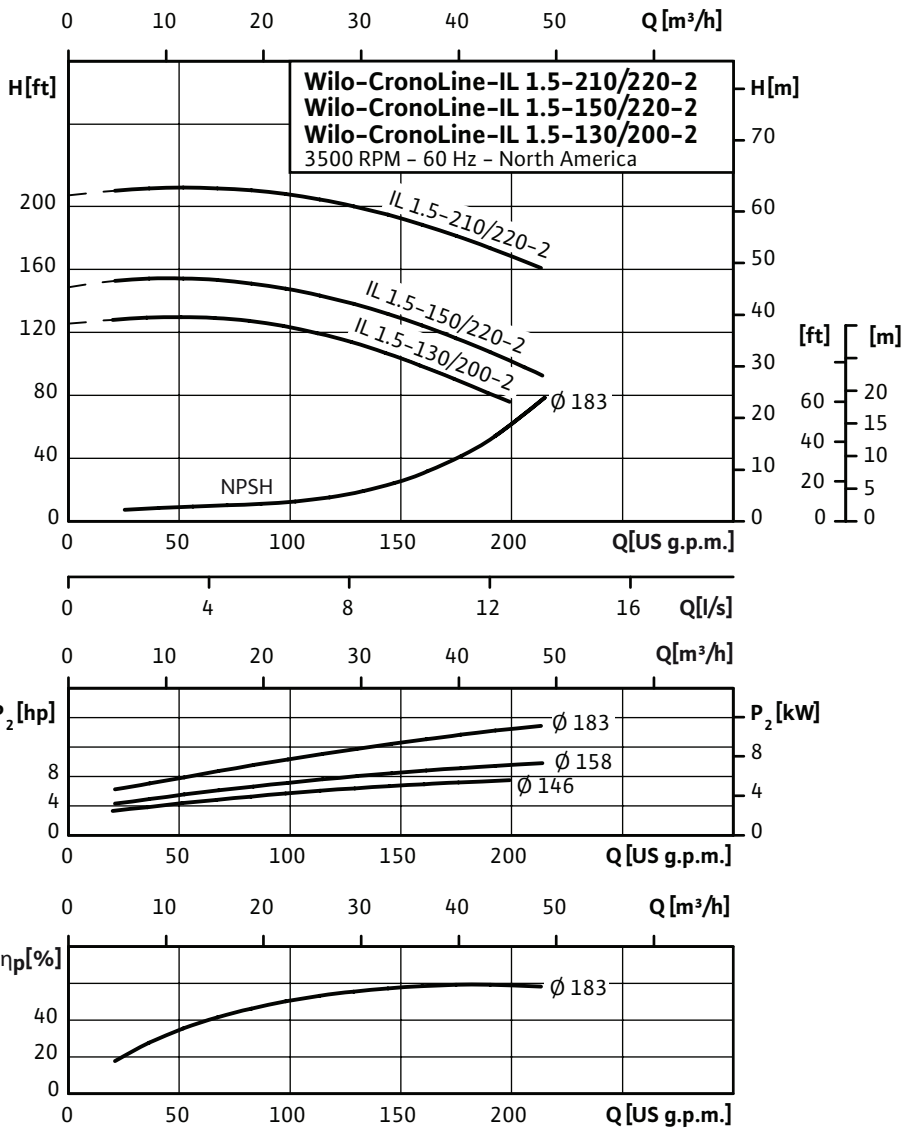

Technical Data

Temp Range:	-5 °F to +285 °F (-20 °C to +140 °C)
Power Supply	3-208-230/460, 575 volt
Motor Options	TEFC, (ODP Opt), EPACK Rated
Flange Connection	1½" NPT with ¼" pressure gauge tappings
Max operating pressure:	250 PSI (16 bar)

Materials of Construction

Pump volute	Cast Iron
Impeller	Bronze (cast iron optional)
Shaft	316L stainless steel
Mechanical seal	Q1Q1X4GG (silicium carbide seal faces, HNBR elastomers)

Applications

• Hot water heating systems	• Industrial circulation systems
• Air conditioning systems	• Solar Systems
• Closed cooling circuits	• Geothermal Systems

Approval Stamp

Submittal Data Sheet

Wilo IL - Inline Centrifugal Circulators



Dimensions & Weights

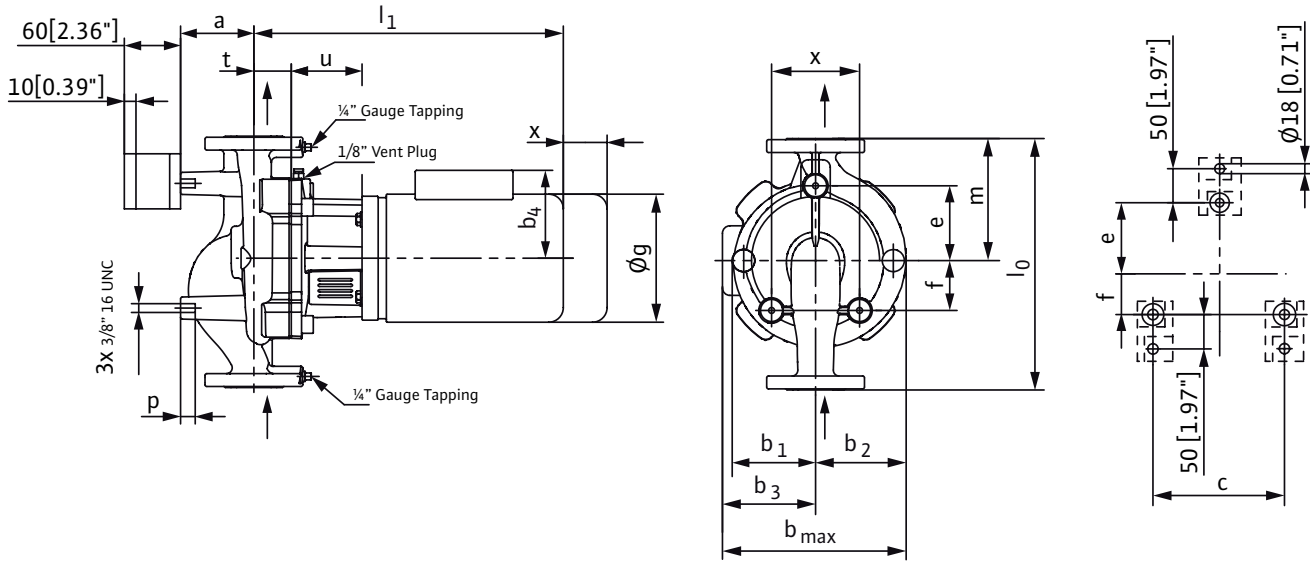

Dimensions and Weights

Model	Dia	Dimensions—inches (mm)															Weight		
		l_0	a	b_1	b_2	b_3	b_4	b_{max}	c	e	f	ϕg	l_1	m	p	t		u	x
IL 1.5-130/200-2	1½	17	4 ⁵ / ₁₆	5 ¹¹ / ₁₆	5 ⁷ / ₈	6 ⁷ / ₈	-	12¾	7 ¹ / ₁₆	5 ³ / ₈	3 ¹ / ₁₆	8 ⁵ / ₈	22 ⁵ / ₁₆	8	1 ³ / ₁₆	2 ³ / ₈	4 ⁹ / ₁₆	4	148 lbs
	1½	(432)	(110)	(145)	(149)	(175)	-	(324)	(180)	(137)	(78)	(218)	(566)	(203)	(20)	(60)	(116)	(102)	67 kg
IL 1.5-150/220-2	1½	17	4 ⁵ / ₁₆	5 ¹¹ / ₁₆	5 ⁷ / ₈	7 ¹⁵ / ₁₆	-	13 ¹³ / ₁₆	7 ¹ / ₁₆	5 ³ / ₈	3 ¹ / ₁₆	10 ³ / ₁₆	22¾	8	1 ³ / ₁₆	2 ³ / ₈	4 ⁹ / ₁₆	4	216 lbs
	1½	(432)	(110)	(145)	(149)	(201)	-	(350)	(180)	(137)	(78)	(259)	590	(203)	(20)	(60)	(116)	(102)	98 kg
IL 1.5-210/220-2	1½	17	4 ⁵ / ₁₆	5 ¹¹ / ₁₆	5 ⁷ / ₈	7 ¹⁵ / ₁₆	-	13 ¹³ / ₁₆	7 ¹ / ₁₆	5 ³ / ₈	3 ¹ / ₁₆	10 ³ / ₁₆	22¾	8	1 ³ / ₁₆	2 ³ / ₈	4 ⁹ / ₁₆	4	229 lbs
	1½	(432)	(110)	(145)	(149)	(201)	-	(350)	(180)	(137)	(78)	(259)	590	(203)	(20)	(60)	(116)	(102)	104 kg

Flange Dimensions

Dimensions - Inches (mm)				
DN	ϕD	ϕd_1	ϕk	$n \times d_L$
1.5	6 ¹ / ₈	3 ⁹ / ₁₆	3 ⁷ / ₈	4 x 5/8
	(155)	(90)	(99)	(4 x 16)

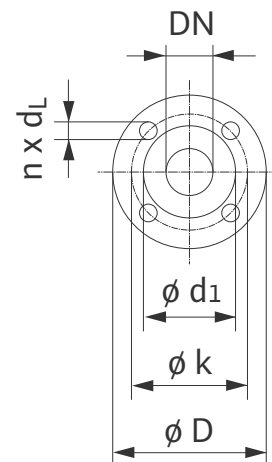

TEFC Motor Data

Model	P2	Phase	Voltage	FLA
	[HP]	[~]	[V]	[A]
IL 1.5-150/220-2	10	3	208-230/460	25-23/11.5
IL 1.5-150/300-2	10	3	208-230/460	25-23/11.5
IL 1.5-210/220-2	15	3	208-230/460	37.5-34/17

WILO USA LLC

Tel: (866) 945-6872 Web: www.wilo-usa.com
 Fax: (708) 338-9455 Email: info@wilo-usa.com

WILO Canada Inc.

Tel: (866) 945-6236 Web: www.wilo-canada.com
 Fax: (403) 277-9456 Email: info@wilo-canada.com

WILO Mexico

Tel: +52 55 5586 3209 Web: www.wilo-mexico.com.mx
 Fax: +52 1 55 5413 4165 Email: info@wilo.com.mx

Submittal Data Sheet

Wilo IL - Inline Centrifugal Circulators



Wilo IL 2-80 3500 RPM



Project:	
Engineer:	
Contractor:	
Submitted By:	Date:
Approved By:	Date:

Tag #	Model #	Flow	Head	HP	Cycle	Phase	Voltage	RPM
					60Hz			3,500 (2 Pole)

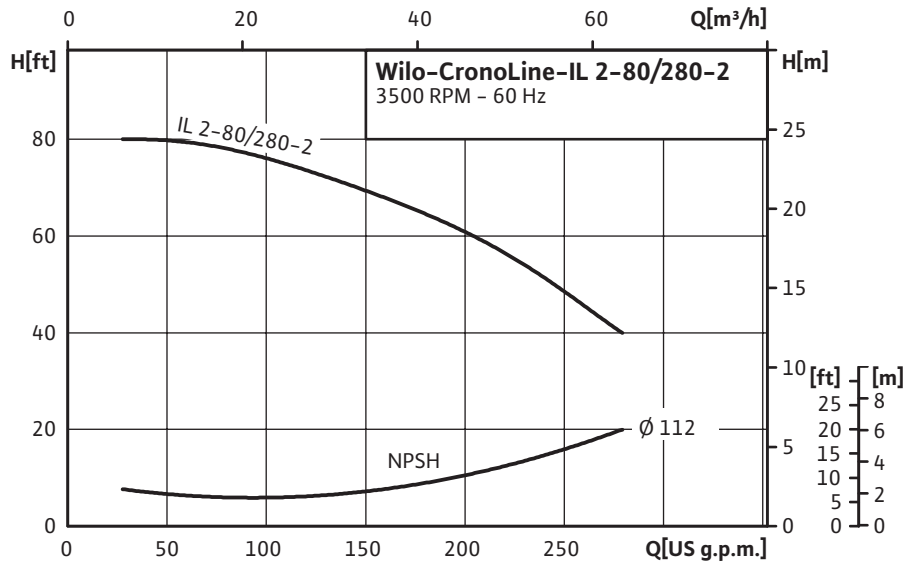

Technical Data	
Temp Range:	-5 °F to +285 °F (-20 °C to +140 °C)
Power Supply	3-208-230/460, 575 volt
Motor Options	TEFC, (ODP Opt), EPACK Rated
Flange Connection	2" NPT with 1/4" pressure gauge tapings
Max operating pressure:	250 PSI (16 bar)

Materials of Construction	
Pump volute	Cast iron
Impeller	Bronze (cast iron optional)
Shaft	316L stainless steel
Mechanical seal	Q1Q1X4GG (silicium carbide seal faces, HNBR elastomers)

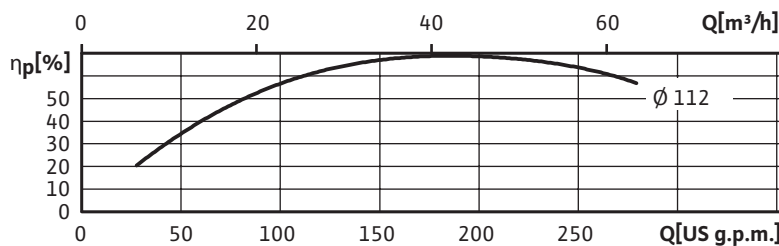
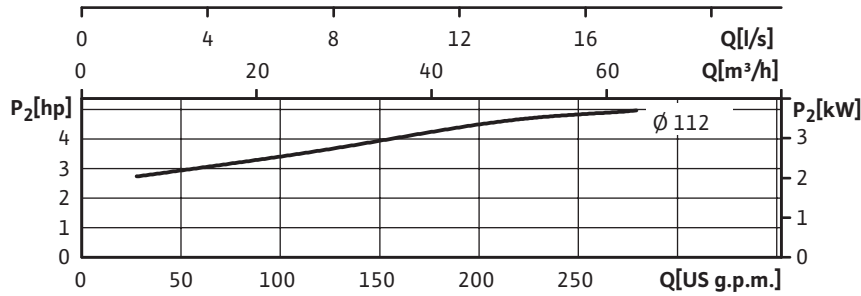

Applications	
• Hot water heating systems	• Industrial circulation systems
• Air conditioning systems	• Solar Systems
• Closed cooling circuits	• Geothermal Systems

Approval Stamp

Dimensions & Weights

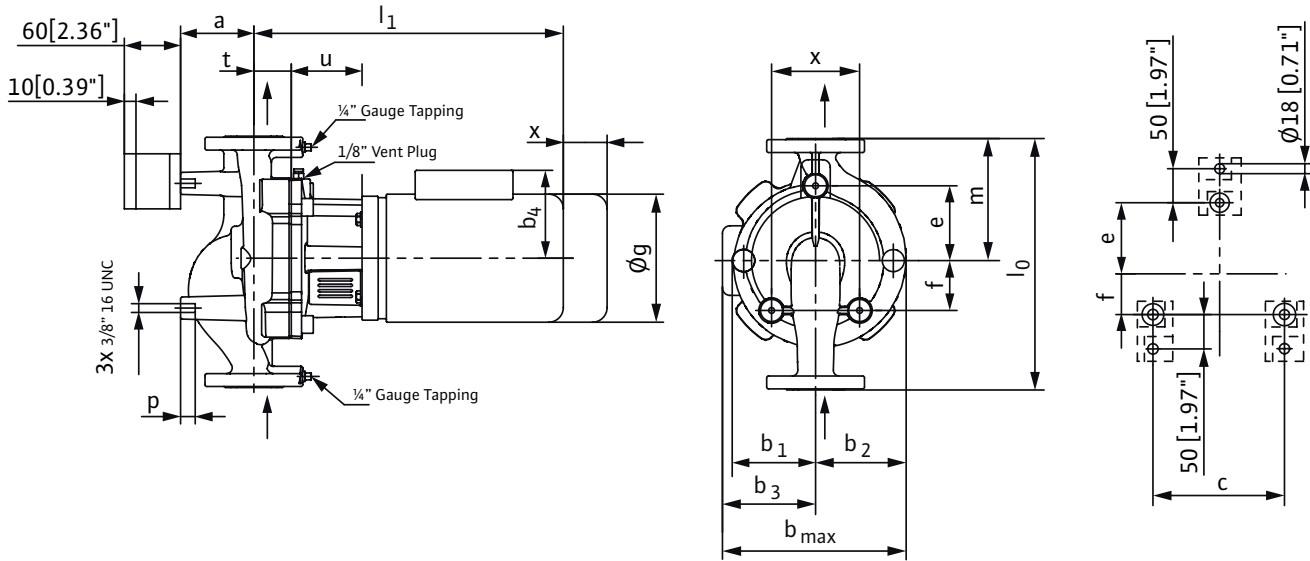

Dimensions and Weights

Model	Dia	Dimensions—inches (mm)																	Weight
		l_0	a	b_1	b_2	b_3	b_4	b_{max}	c	e	f	ϕg	l_1	m	p	t	u	x	
IL 2-80/280-2	2	14½	4⅞	4	4 ^{11/16}	6 ^{3/8}	-	11 ^{1/16}	5½	3 ^{7/8}	2 ^{1/8}	8 ^{5/8}	21¼	6 ^{5/8}	1 ^{3/16}	2 ^{3/8}	4	3 ^{15/16}	146 lbs
	2	(368)	(105)	(102)	(119)	(162)	-	(281)	(140)	(99)	(54)	(218)	(552)	(169)	(20)	(60)	(101)	(100)	66 kg

Flange Dimensions

Dimensions - Inches (mm)				
DN	ϕD	ϕd_1	ϕk	$n \times d_L$
2	6½	4 ^{3/16}	4¾	4 x ¾
	(165)	(106)	(121)	(4 x 19)

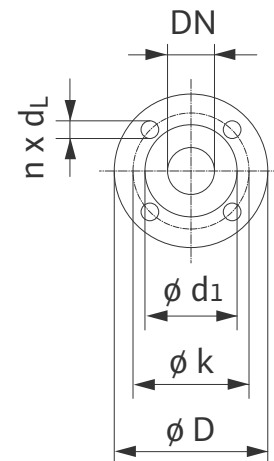

TEFC Motor Data

Model	P2	Phase	Voltage	FLA
	[HP]	[~]	[V]	[A]
IL 2-80/280-2	5	3	208-230/460	13-12/6

Submittal Data Sheet

Wilco IL - Inline Centrifugal Circulators



Wilco IL 2-110, 2-130, 2-170 3500 RPM



Project:	
Engineer:	
Contractor:	
Submitted By:	Date:
Approved By:	Date:

Tag #	Model #	Flow	Head	HP	Cycle	Phase	Voltage	RPM
					60Hz			3,500 (2 Pole)

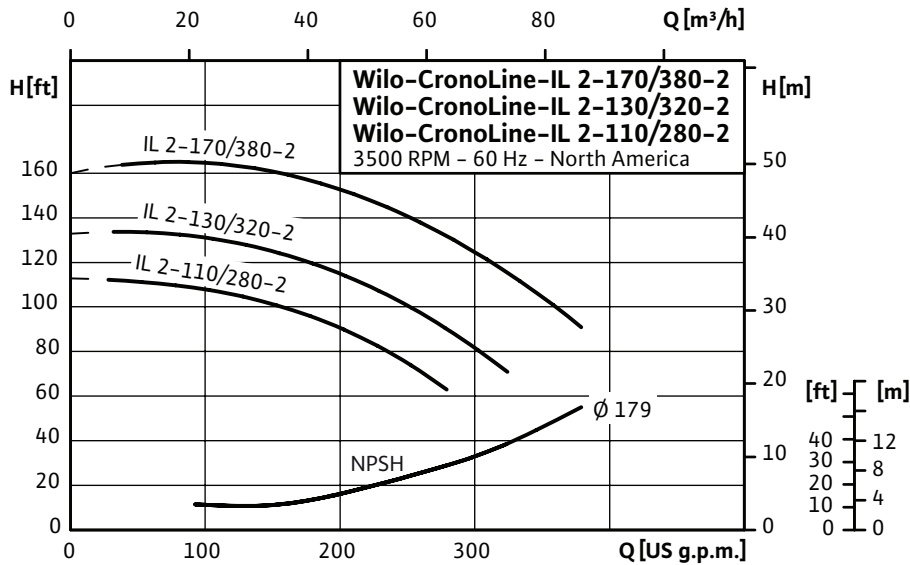

Technical Data	
Temp Range:	-5 °F to +285 °F (-20 °C to +140 °C)
Power Supply	3-208-230/460, 575 volt
Motor Options	TEFC, (ODP Opt), EPACK Rated
Flange Connection	2" NPT with 1/4" pressure gauge tapings
Max operating pressure:	250 PSI (16 bar)

Materials of Construction	
Pump volute	Cast Iron
Impeller	Bronze (cast iron optional)
Shaft	316L stainless steel
Mechanical seal	Q1Q1X4GG (silicium carbide seal faces, HNBR elastomers)

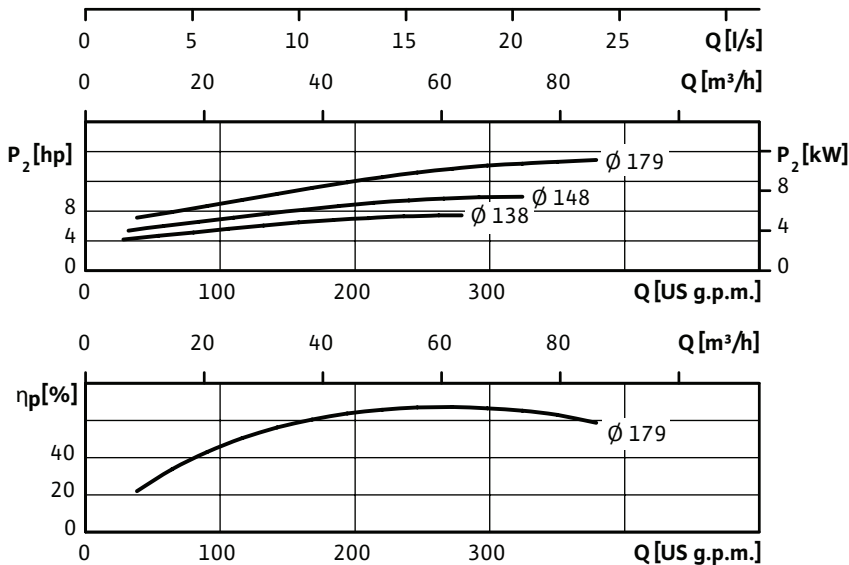

Applications	
• Hot water heating systems	• Industrial circulation systems
• Air conditioning systems	• Solar Systems
• Closed cooling circuits	• Geothermal Systems



Dimensions & Weights

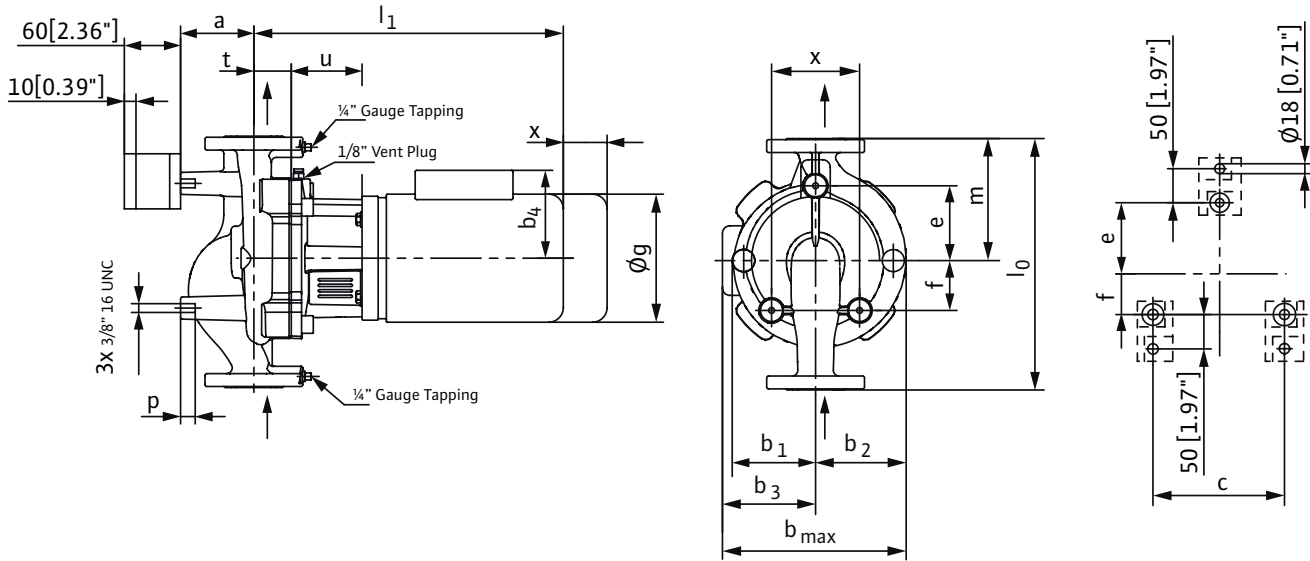

Dimensions and Weights

Model	Dia	Dimensions-inches (mm)															Weight		
		l_0	a	b_1	b_2	b_3	b_4	b_{max}	c	e	f	ϕ_g	l_1	m	p	t		u	x
IL 2-110/280-2	2	15	3 ⁹ / ₁₆	4 ³ / ₄	5 ¹ / ₂	6 ⁷ / ₈	-	12 ⁵ / ₁₆	6 ⁷ / ₁₆	4 ⁵ / ₈	1 ⁷ / ₈	8 ⁵ / ₈	22 ¹³ / ₁₆	7 ⁵ / ₁₆	1 ³ / ₁₆	2 ¹³ / ₁₆	4 ⁹ / ₁₆	4	139 lbs
		(381)	(90)	(120)	(139)	(175)	-	(314)	(164)	(117)	(48)	(218)	(579)	(186)	(20)	(72)	(116)	(102)	63 kg
IL 2-130/320-2	2	15	3 ⁹ / ₁₆	4 ³ / ₄	5 ¹ / ₂	7 ¹⁵ / ₁₆	-	13 ³ / ₈	6 ⁷ / ₁₆	4 ⁵ / ₈	1 ⁷ / ₈	10 ³ / ₁₆	22 ¹¹ / ₁₆	7 ⁵ / ₁₆	1 ³ / ₁₆	2 ¹³ / ₁₆	4 ⁹ / ₁₆	4	207 lbs
		(381)	(90)	(120)	(139)	(201)	-	(340)	(164)	(117)	(48)	(259)	(577)	(186)	(20)	(72)	(116)	(102)	94 kg
IL 2-170/380-2	2	15	3 ⁹ / ₁₆	4 ³ / ₄	5 ¹ / ₂	7 ¹⁵ / ₁₆	-	13 ³ / ₈	6 ⁷ / ₁₆	4 ⁵ / ₈	1 ⁷ / ₈	10 ³ / ₁₆	23 ¹¹ / ₁₆	7 ⁵ / ₁₆	1 ³ / ₁₆	2 ¹³ / ₁₆	4 ⁹ / ₁₆	4	223 lbs
		(381)	(90)	(120)	(139)	(201)	-	(340)	(164)	(117)	(48)	(259)	(602)	(186)	(20)	(72)	(116)	(102)	101 kg

Flange Dimensions

Dimensions - Inches (mm)				
DN	ϕD	ϕd_1	ϕk	$n \times d_L$
2	6 ¹ / ₂	4 ³ / ₁₆	4 ³ / ₄	4 x 3/4
	(165)	(106)	(121)	(4 x 19)

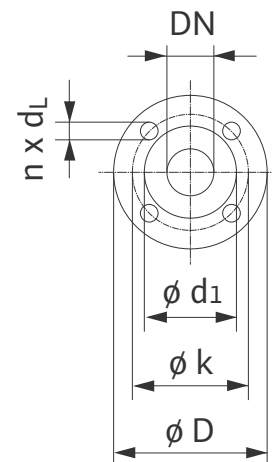

TEFC Motor Data

Model	P2	Phase	Voltage	FLA
	[HP]	[-]	[V]	[A]
IL 2-110/280-2	7.5	3	208-230/460	18-17.2/8.6
IL 2-130/320-2	10	3	208-230/460	25-23/11.5
IL 2-170/380-2	15	3	208-230/460	37.5-34/17

Submittal Data Sheet

Wilo IL - Inline Centrifugal Circulators



Wilo IL 2-200 3500 RPM



Project:								
Engineer:								
Contractor:								
Submitted By:					Date:			
Approved By:					Date:			

Tag #	Model #	Flow	Head	HP	Cycle	Phase	Voltage	RPM
					60Hz			3,500 (2 Pole)

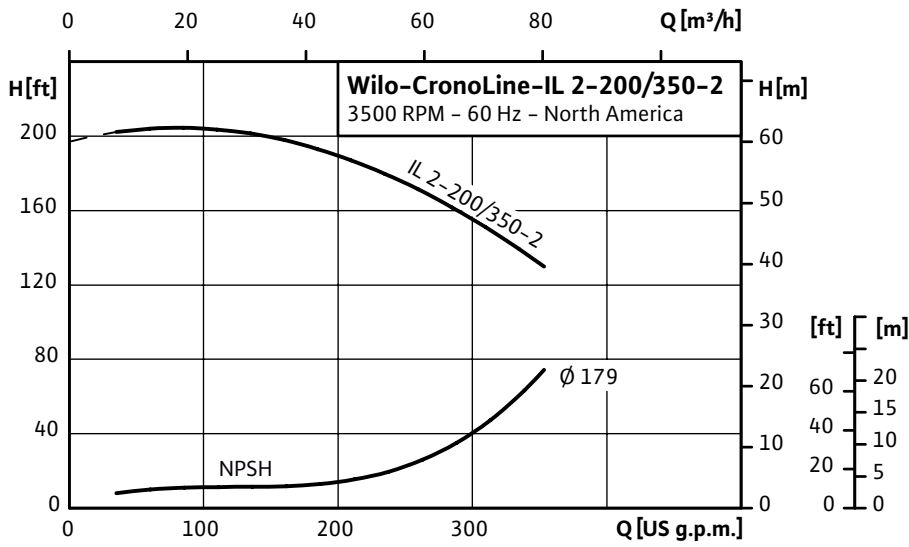

Technical Data	
Temp Range:	-5 °F to + 285 °F (-20 °C to +140 °C)
Power Supply	3-208-230/460, 575 volt
Motor Options	TEFC, (ODP Opt), EPACK Rated
Flange Connection	2" NPT with 1/4" pressure gauge tapings
Max operating pressure:	250 PSI (16 bar)

Materials of Construction	
Pump volute	Cast Iron
Impeller	Bronze (cast iron optional)
Shaft	316L stainless steel
Mechanical seal	Q1Q1X4GG (silicium carbide seal faces, HNBR elastomers)

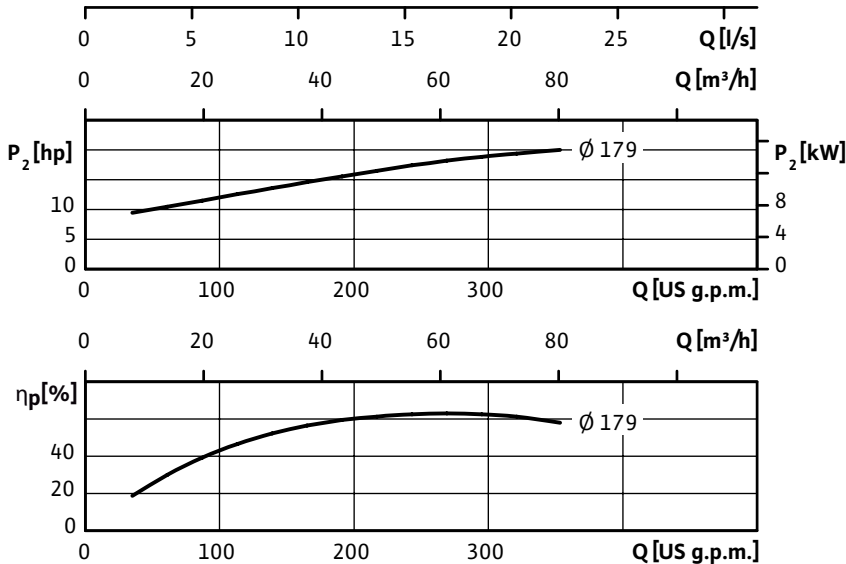

Applications	
• Hot water heating systems	• Industrial circulation systems
• Air conditioning systems	• Solar Systems
• Closed cooling circuits	• Geothermal Systems



Dimensions & Weights

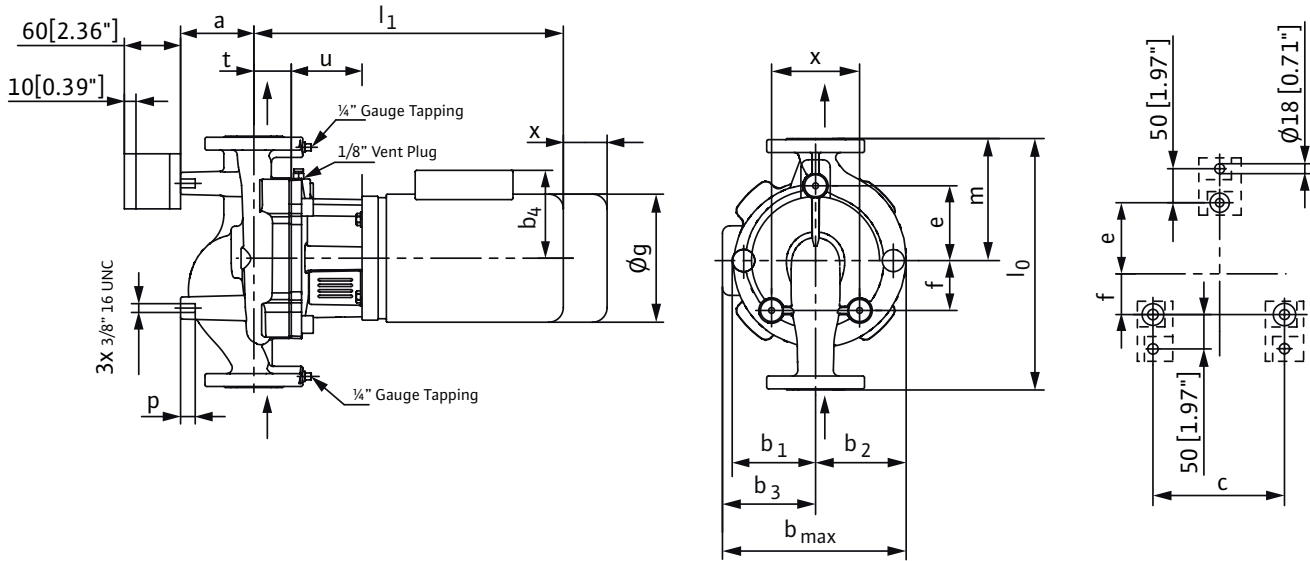

Dimensions and Weights

Model	Dia	Dimensions—inches (mm)																	Weight
		l ₀	a	b ₁	b ₂	b ₃	b ₄	b _{max}	c	e	f	φg	l ₁	m	p	t	u	x	
IL 2-200/350-2	2	17½	4¾	5 ¹¹ / ₁₆	5 ⁷ / ₈	8 ³ / ₁₆	-	14 ¹ / ₁₆	6 ⁵ / ₁₆	5 ³ / ₁₆	2¾	10 ³ / ₁₆	25 ⁷ / ₁₆	7 ¹⁵ / ₁₆	1 ³ / ₁₆	2 ³ / ₈	6 ⁵ / ₈	4	260 lbs
	2	(444)	(120)	(145)	(150)	(207)	-	(357)	(160)	(132)	(70)	(259)	(646)	(202)	(20)	(61)	(168)	(102)	118 kg

Flange Dimensions

Dimensions - Inches (mm)				
DN	φD	φd ₁	φk	n x d _L
2	6½	4 ³ / ₁₆	4¾	4 x ¾
	(165)	(106)	(121)	(4 x 19)

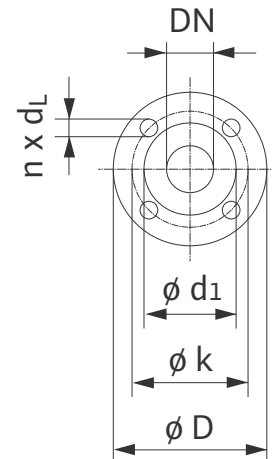

TEFC Motor Data

Model	P2	Phase	Voltage	FLA
	[HP]	[~]	[V]	[A]
IL 2-200/350-2	20	3	208-230/460	50.1-46/23

Submittal Data Sheet

Wilco IL - Inline Centrifugal Circulators



Wilco IL 2.5-85, 2.5-110 3500 RPM



Project:	
Engineer:	
Contractor:	
Submitted By:	Date:
Approved By:	Date:

Tag #	Model #	Flow	Head	HP	Cycle	Phase	Voltage	RPM
					60Hz			3,500 (2 Pole)

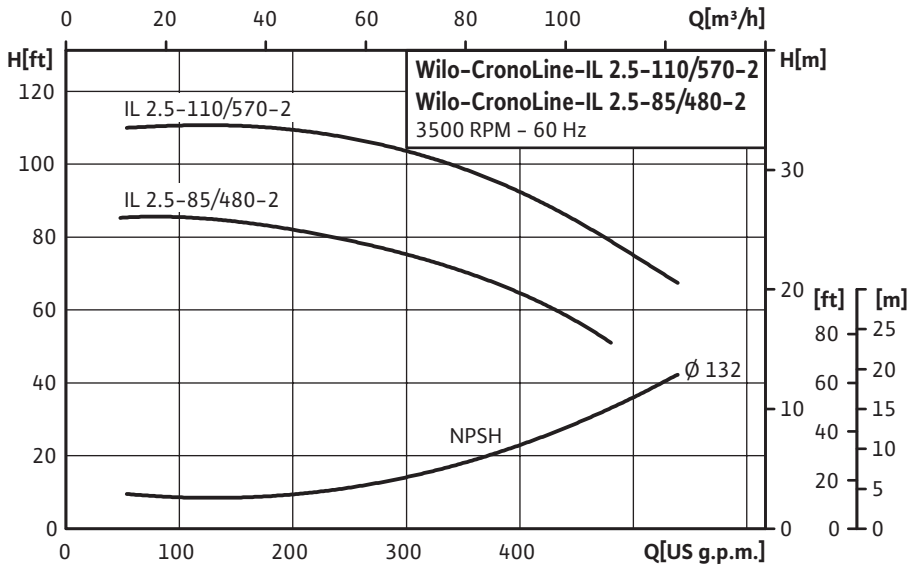

Technical Data	
Temp Range:	-5 °F to +285 °F (-20 °C to +140 °C)
Power Supply	3-208-230/460, 575 volt
Motor Options	TEFC, (ODP Opt), EPACK Rated
Flange Connection	2½" NPT with ¼" pressure gauge tappings
Max operating pressure:	250 PSI (16 bar)

Materials of Construction	
Pump volute	Cast iron
Impeller	Bronze (cast iron optional)
Shaft	316L stainless steel
Mechanical seal	Q1Q1X4GG (silicium carbide seal faces, HNBR elastomers)

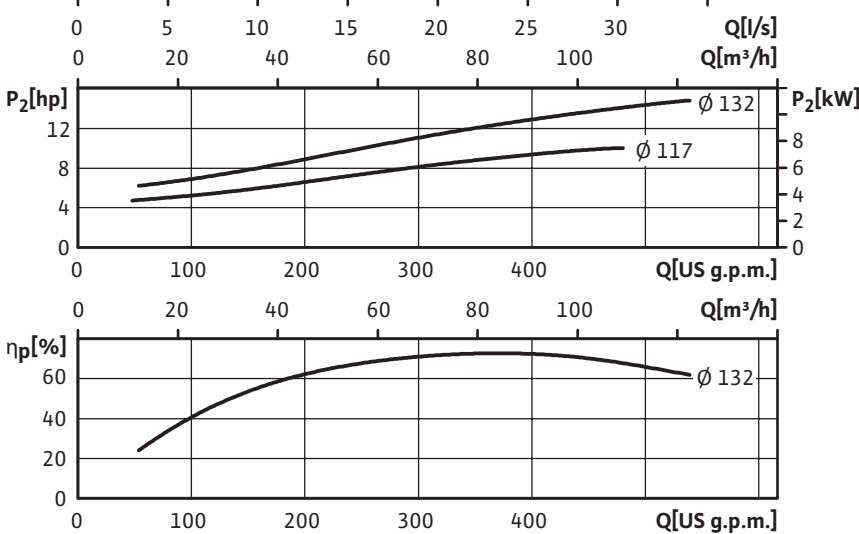

Applications	
• Hot water heating systems	• Industrial circulation systems
• Air conditioning systems	• Solar Systems
• Closed cooling circuits	• Geothermal Systems

Approval Stamp

Dimensions & Weights

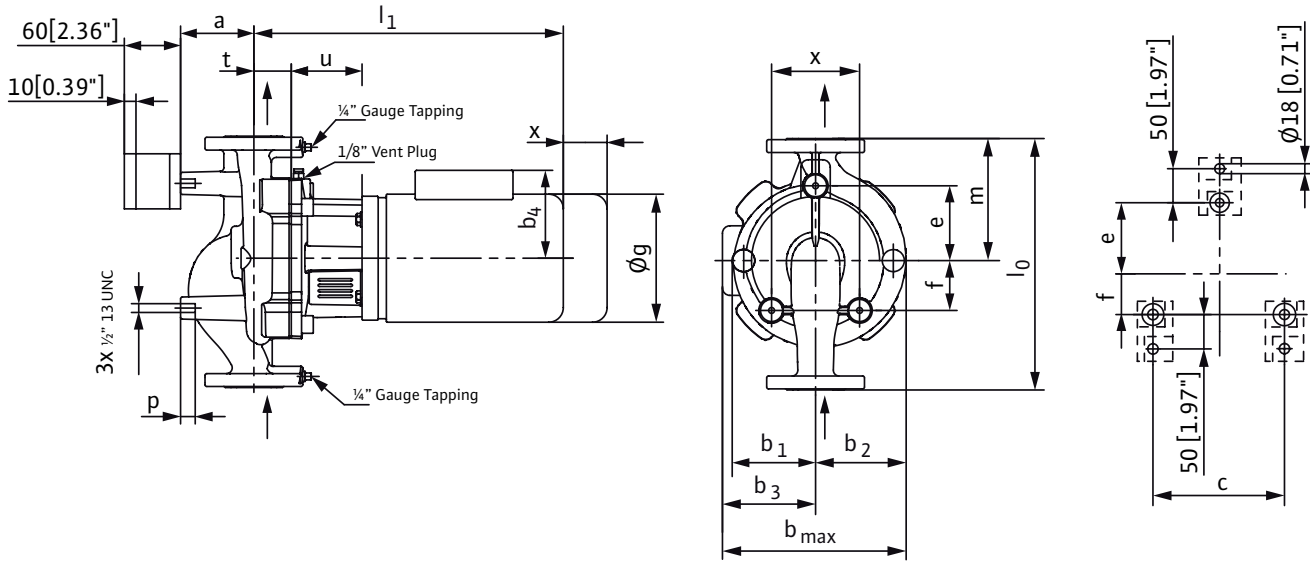

Dimensions and Weights

Model	Dia	Dimensions-inches (mm)																	Weight
		l ₀	a	b ₁	b ₂	b ₃	b ₄	b _{max}	c	e	f	φg	l ₁	m	p	t	u	x	
IL 2.5-85/480-2	2.5	15	4 3/4	4 7/16	5 1/4	7 15/16	-	13 3/16	5 1/2	3 15/16	2 3/8	10 3/16	24 5/8	7	1 3/16	2 15/16	4 15/16	5	209 lbs
	2.5	(381)	(120)	(112)	(134)	(201)	-	(335)	(140)	(100)	(60)	(259)	(626)	(178)	(20)	(75)	(126)	(127)	95 kg
IL 2.5-110/570-2	2.5	15	4 3/4	4 7/16	5 1/4	7 15/16	-	13 3/16	5 1/2	3 15/16	2 3/8	10 3/16	25 5/8	7	1 3/16	2 15/16	4 15/16	5	216 lbs
	2.5	(381)	(120)	(112)	(134)	(201)	-	(335)	(140)	(100)	(60)	(259)	(652)	(178)	(20)	(75)	(126)	(127)	98 kg

Flange Dimensions

Dimensions - Inches (mm)				
DN	φD	φd ₁	φk	n x d _L
2.5	4 5/16	4 15/16	5 1/2	4 x 3/4
	(110)	(126)	(140)	(4 x 19)

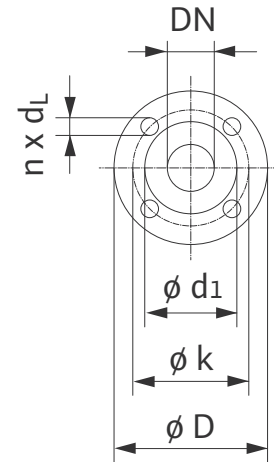

TEFC Motor Data

Model	P2	Phase	Voltage V (A)	Current A (C)
	[HP]	[-]	[V]	[A]
IL 2.5-85/480-2	10	3	208-230/460	25-23/11.5
IL 2.5-110/570-2	15	3	208-230/460	37.5-34/17

Submittal Data Sheet

Wilo IL - Inline Centrifugal Circulators



Wilo IL 2.5-90, 2.5-110, 2.5-140 3500 RPM



Project:								
Engineer:								
Contractor:								
Submitted By:					Date:			
Approved By:					Date:			

Tag #	Model #	Flow	Head	HP	Cycle	Phase	Voltage	RPM
					60Hz			3,500 (2 Pole)

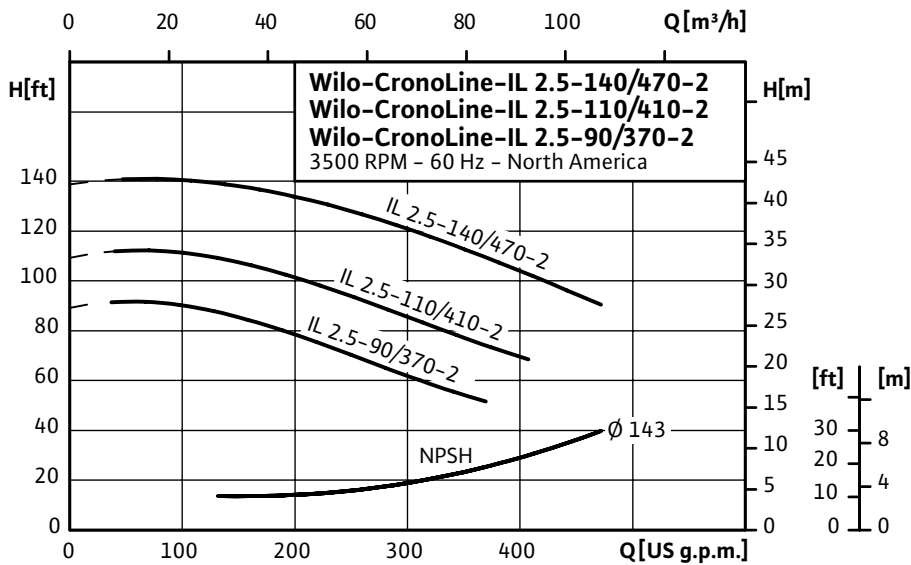

Technical Data	
Temp Range:	-5 °F to +285 °F (-20 °C to +140 °C)
Power Supply	3-208-230/460, 575 volt
Motor Options	TEFC, (ODP Opt), EPACK Rated
Flange Connection	2½" with ¼" pressure gauge tappings
Max operating pressure:	250 PSI (16 bar)

Materials of Construction	
Pump volute	Cast iron
Impeller	Bronze (cast iron optional)
Shaft	316L stainless steel
Mechanical seal	Q1Q1X4GG (silicium carbide seal faces, HNBR elastomers)

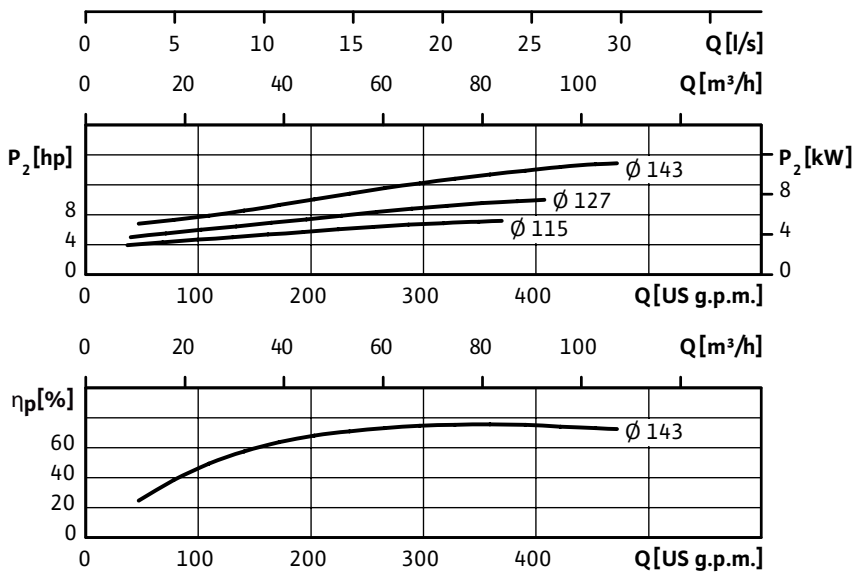

Applications	
• Hot water heating systems	• Industrial circulation systems
• Air conditioning systems	• Solar Systems
• Closed cooling circuits	• Geothermal Systems

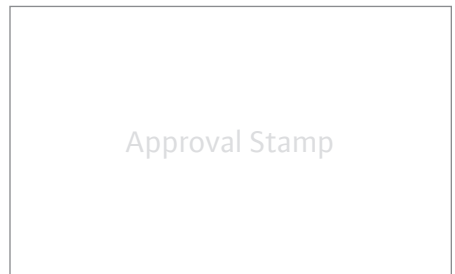

Submittal Data Sheet

Wilo IL - Inline Centrifugal Circulators



Dimensions & Weights

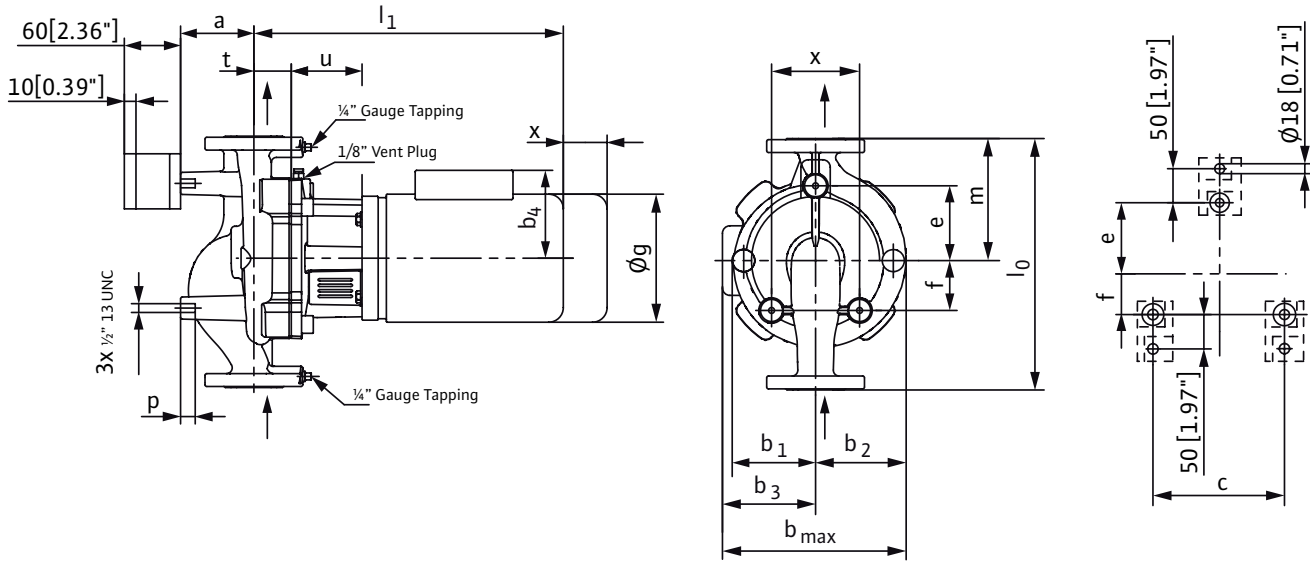

Dimensions and Weights

Model	Dia	Dimensions-inches (mm)																Weight	
		l ₀	a	b ₁	b ₂	b ₃	b ₄	b _{max}	c	e	f	φg	l ₁	m	p	t	u		x
IL 2.5-90/370-2	2.5	17½	4 ⁵ / ₁₆	5	5 ¹³ / ₁₆	6 ⁷ / ₈	-	12 ¹¹ / ₁₆	7 ¹ / ₁₆	5½	2 ³ / ₈	8 ⁵ / ₈	25	8½	1 ³ / ₁₆	3 ¹ / ₁₆	6 ⁹ / ₁₆	5	152 lbs
		(445)	(110)	(127)	(147)	(175)	-	(322)	(180)	(140)	(60)	(218)	(635)	(216)	(20)	(78)	(167)	(127)	69 kg
IL 2.5-110/410-2	2.5	17½	4 ⁵ / ₁₆	5	5 ¹³ / ₁₆	7 ¹⁵ / ₁₆	-	13 ¹¹ / ₁₆	7 ¹ / ₁₆	5½	2 ³ / ₈	10 ³ / ₁₆	24 ¹⁵ / ₁₆	8½	1 ³ / ₁₆	3 ¹ / ₁₆	6 ⁹ / ₁₆	5	218 lbs
		(445)	(110)	(127)	(147)	(201)	-	(348)	(180)	(140)	(60)	(259)	(633)	(216)	(20)	(78)	(167)	(127)	99 kg
IL 2.5-140/470-2	2.5	17½	4 ⁵ / ₁₆	5	5 ¹³ / ₁₆	7 ¹⁵ / ₁₆	-	13 ¹¹ / ₁₆	7 ¹ / ₁₆	5½	2 ³ / ₈	10 ³ / ₁₆	25 ¹⁵ / ₁₆	8½	1 ³ / ₁₆	3 ¹ / ₁₆	6 ⁹ / ₁₆	5	234 lbs
		(445)	(110)	(127)	(147)	(201)	-	(348)	(180)	(140)	(60)	(259)	(659)	(216)	(20)	(78)	(167)	(127)	106 kg

Flange Dimensions

Dimensions - Inches (mm)				
DN	φD	φd ₁	φk	n x d _L
2.5	4 ⁵ / ₁₆	4 ¹⁵ / ₁₆	5½	4 x ¾
	(110)	(126)	(140)	(4 x 19)

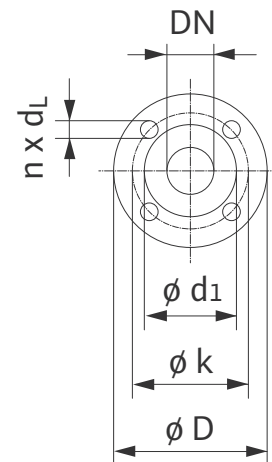

TEFC Motor Data

Model	P2	Phase	Voltage	FLA
	[HP]	[-]	[V]	[A]
IL 2.5-90/370-2	7.5	3	208-230/460	18-17.2/8.6
IL 2.5-110/410-2	10	3	208-230/460	25-23/11.5
IL 2.5-140/470-2	15	3	208-230/460	37.5-34/17

WILO USA LLC

Tel: (866) 945-6872 Web: www.wilo-usa.com
Fax: (708) 338-9455 Email: info@wilo-usa.com

WILO Canada Inc.

Tel: (866) 945-6236 Web: www.wilo-canada.com
Fax: (403) 277-9456 Email: info@wilo-canada.com

WILO Mexico

Tel: +52 55 5586 3209 Web: www.wilo-mexico.com.mx
Fax: +52 1 55 5413 4165 Email: info@wilo.com.mx

Submittal Data Sheet

Wilo IL - Inline Centrifugal Circulators



Wilo IL 3-80, 3-100 3500 RPM



Project:	
Engineer:	
Contractor:	
Submitted By:	Date:
Approved By:	Date:

Tag #	Model #	Flow	Head	HP	Cycle	Phase	Voltage	RPM
					60Hz			3,500 (2 Pole)

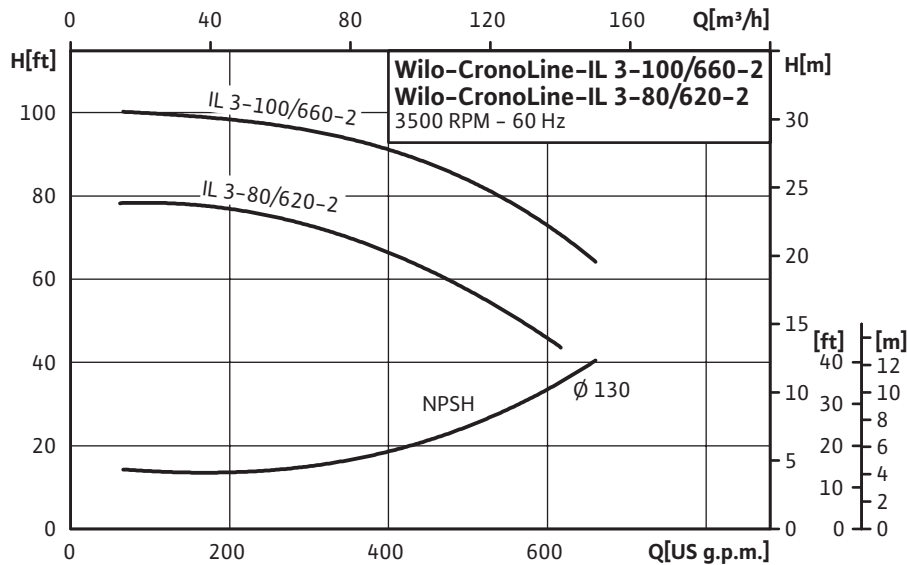

Technical Data	
Temp Range:	-5 °F to + 285 °F (-20 °C to +140 °C)
Power Supply	3-208-230/460, 575 volt
Motor Options	TEFC, (ODP Opt), EPACK Rated
Flange Connection	3" NPT with ¼" pressure gauge tappings
Max operating pressure:	250 PSI (16 bar)

Materials of Construction	
Pump volute	Cast Iron
Impeller	Bronze (cast iron optional)
Shaft	316L stainless steel
Mechanical seal	Q1Q1X4GG (silicium carbide seal faces, HNBR elastomers)

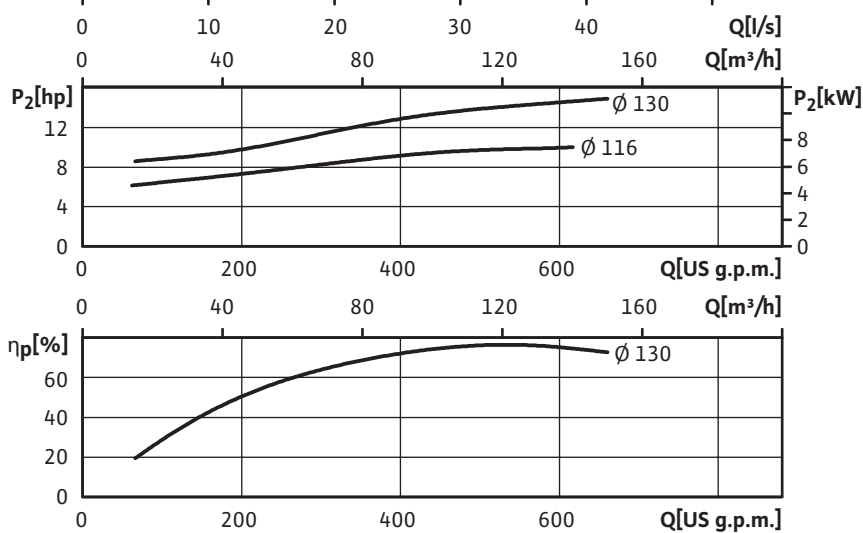

Applications	
• Hot water heating systems	• Industrial circulation systems
• Air conditioning systems	• Solar Systems
• Closed cooling circuits	• Geothermal Systems

Approval Stamp

Dimensions & Weights

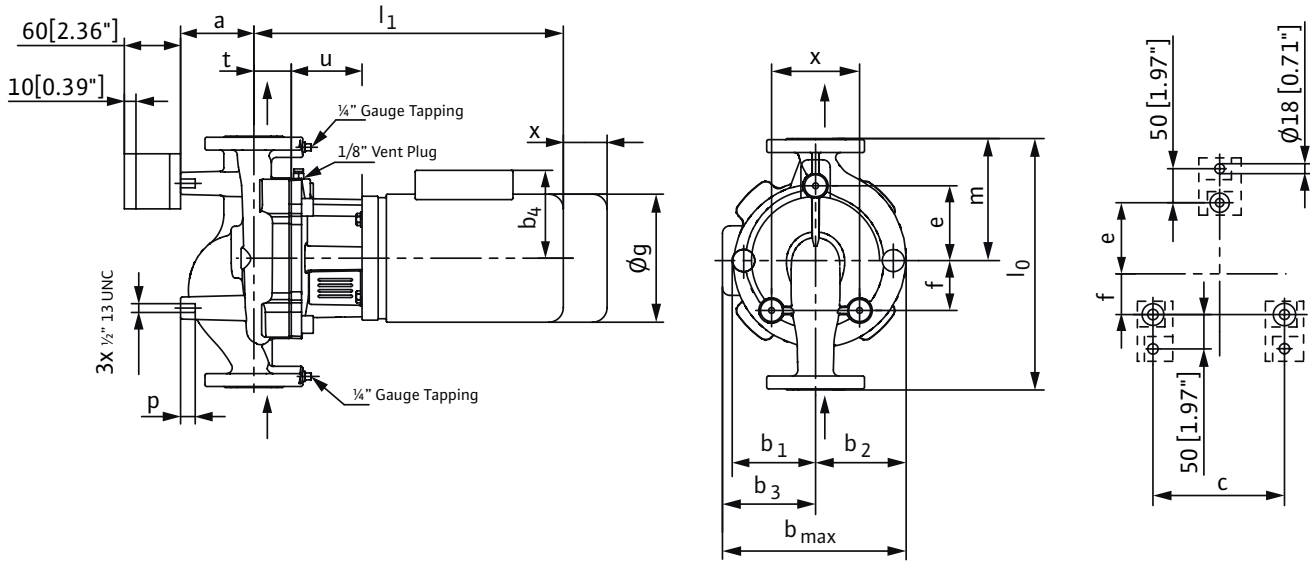

Dimensions and Weights

Model	Dia	Dimensions-inches (mm)																Weight	
		l ₀	a	b ₁	b ₂	b ₃	b ₄	b _{max}	c	e	f	φg	l ₁	m	p	t	u		x
IL 3-80/620-2	3	17½	4¼	4 ⁷ / ₈	5 ¹⁵ / ₁₆	7 ¹⁵ / ₁₆	-	13 ⁷ / ₈	7 ¹ / ₁₆	5½	2¼	10 ³ / ₁₆	25 ⁵ / ₁₆	8 ¹¹ / ₁₆	1 ³ / ₁₆	3 ⁵ / ₈	4 ¹⁵ / ₁₆	5	231 lbs
	3	(445)	(109)	(123)	(151)	(201)	-	(352)	(180)	(140)	(57)	(259)	(643)	(220)	(20)	(92)	(126)	(127)	105 kg
IL 3-100/660-2	3	17½	4¼	4 ⁷ / ₈	5 ¹⁵ / ₁₆	7 ¹⁵ / ₁₆	-	13 ⁷ / ₈	7 ¹ / ₁₆	5½	2¼	10 ³ / ₁₆	26 ⁵ / ₁₆	8 ¹¹ / ₁₆	1 ³ / ₁₆	3 ⁵ / ₈	4 ¹⁵ / ₁₆	5	238 lbs
	3	(445)	(109)	(123)	(151)	(201)	-	(352)	(180)	(140)	(57)	(259)	(669)	(220)	(20)	(92)	(126)	(127)	108 kg

Flange Dimensions

Dimensions - Inches (mm)				
DN	φD	φd ₁	φk	n x d _L
3	8¼	5 ¹¹ / ₁₆	6	4 x ¾
	(210)	(145)	(152)	(4 x 19)

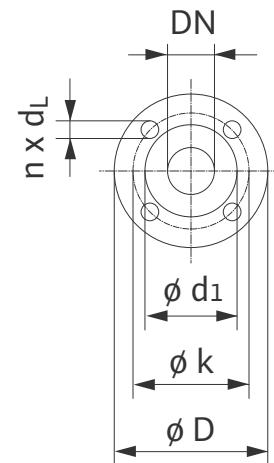

TEFC Motor Data

Model	P2	Phase	Voltage	FLA
	[HP]	[~]	[V]	[A]
IL 3-80/620-2	10	3	208-230/460	25-23/11.5
IL 3-100/660-2	15	3	208-230/460	37.5-34/17

Submittal Data Sheet

Wilco IL - Inline Centrifugal Circulators



Wilco IL 3-130 3500 RPM



Project:							
Engineer:							
Contractor:							
Submitted By:				Date:			
Approved By:				Date:			

Tag #	Model #	Flow	Head	HP	Cycle	Phase	Voltage	RPM
					60Hz			3,500 (2 Pole)

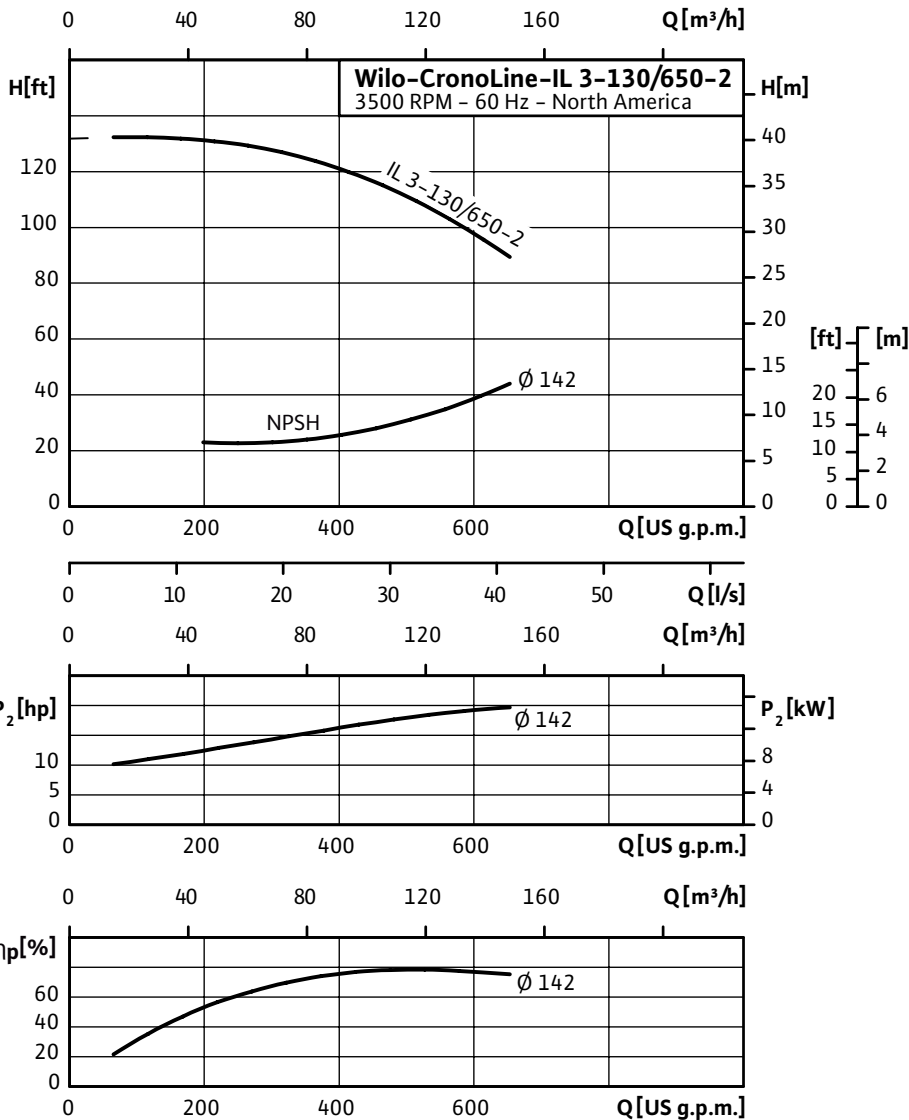

Technical Data

Temp Range:	-5 °F to + 285 °F (-20 °C to +140 °C)
Power Supply	3-208-230/460, 575 volt
Motor Options	TEFC, (ODP Opt), EPACK Rated
Flange Connection	1 1/4" to 4" NPT with 1/4" pressure gauge tappings
Max operating pressure:	250 PSI (16 bar)

Materials of Construction

Pump volute	Cast Iron
Impeller	Bronze (cast iron optional)
Shaft	316L stainless steel
Mechanical seal	Q1Q1X4GG (silicium carbide seal faces, HNBR elastomers)

Applications

• Hot water heating systems	• Industrial circulation systems
• Air conditioning systems	• Solar Systems
• Closed cooling circuits	• Geothermal Systems

Approval Stamp

Dimensions & Weights

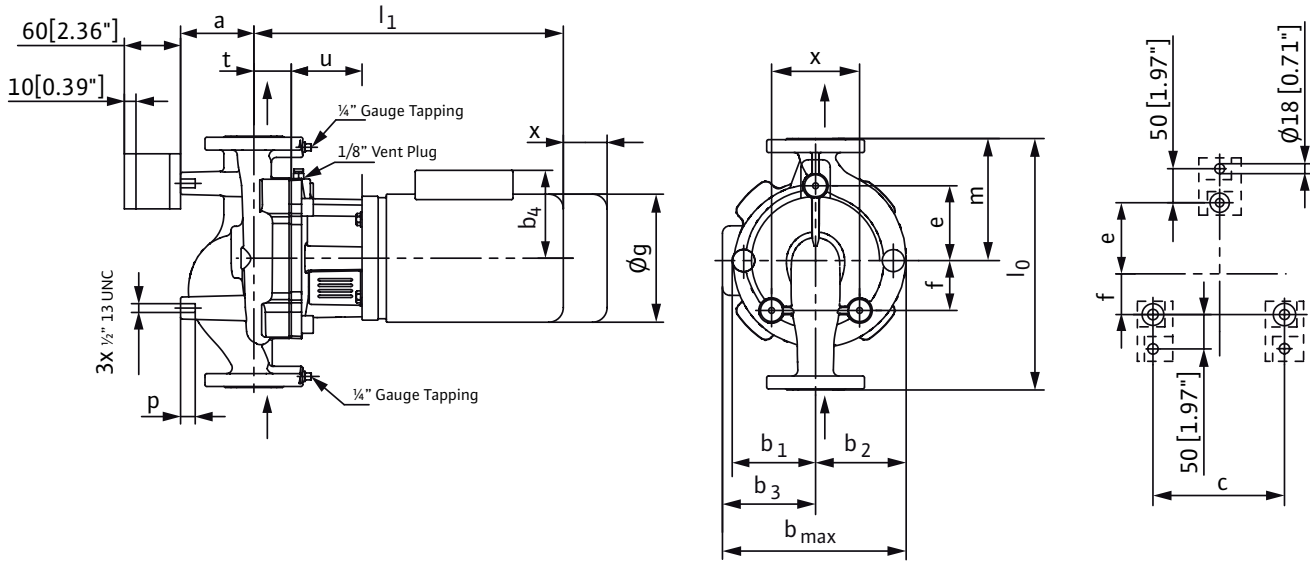

Dimensions and Weights

Model	Dia	Dimensions-inches (mm)																	Weight
		l ₀	a	b ₁	b ₂	b ₃	b ₄	b _{max}	c	e	f	Øg	l ₁	m	p	t	u	x	
IL 3-130/650-2	3	19	4 ^{13/16}	5 ^{3/8}	6 ^{3/8}	8 ^{3/16}	-	14 ^{9/16}	7 ^{1/16}	5 ^{1/16}	2 ^{13/16}	10 ^{3/16}	25 ^{15/16}	8 ^{9/16}	1 ^{3/16}	2 ^{15/16}	6 ^{9/16}	5	282 lbs
	3	(483)	(123)	(136)	(162)	(207)	-	(369)	(180)	(128)	(72)	(259)	(660)	(218)	(20)	(75)	(167)	(127)	128 kg

Flange Dimensions

Dimensions - Inches (mm)				
DN	ØD	Ød ₁	Øk	n x d _L
3	8 ^{1/4}	5 ^{11/16}	6	4 x 3/4
	(210)	(145)	(152)	(4 x 19)

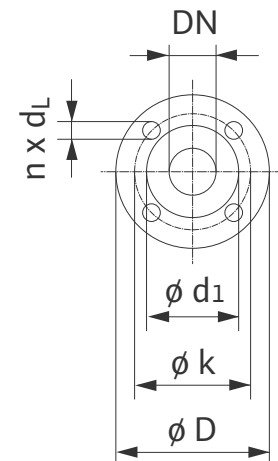

TEFC Motor Data

Model	P2	Phase	Voltage	FLA
	[HP]	[-]	[V]	[A]
IL 3-130/650-2	20	3	208-230/460	50.1-46/23

Submittal Data Sheet

Wilo IL - Inline Centrifugal Circulators



Wilo IL 3-220 3500 RPM



Project:	
Engineer:	
Contractor:	
Submitted By:	Date:
Approved By:	Date:

Tag #	Model #	Flow	Head	HP	Cycle	Phase	Voltage	RPM
					60Hz			3,500 (2 Pole)

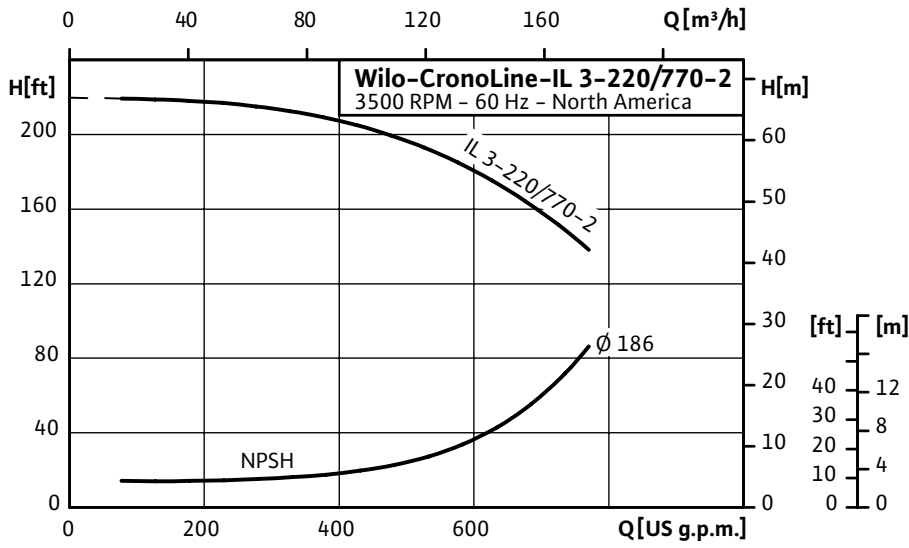

Technical Data	
Temp Range:	-5 °F to +285 °F (-20 °C to +140 °C)
Power Supply	3-208-230/460, 575 volt
Motor Options	TEFC, (ODP Opt), EPACK Rated
Flange Connection	1 1/4" to 4" NPT with 1/4" pressure gauge tapings
Max operating pressure:	250 PSI (16 bar)

Materials of Construction	
Pump volute	Cast Iron
Impeller	Bronze (cast iron optional)
Shaft	316L stainless steel
Mechanical seal	Q1Q1X4GG (silicium carbide seal faces, HNBR elastomers)

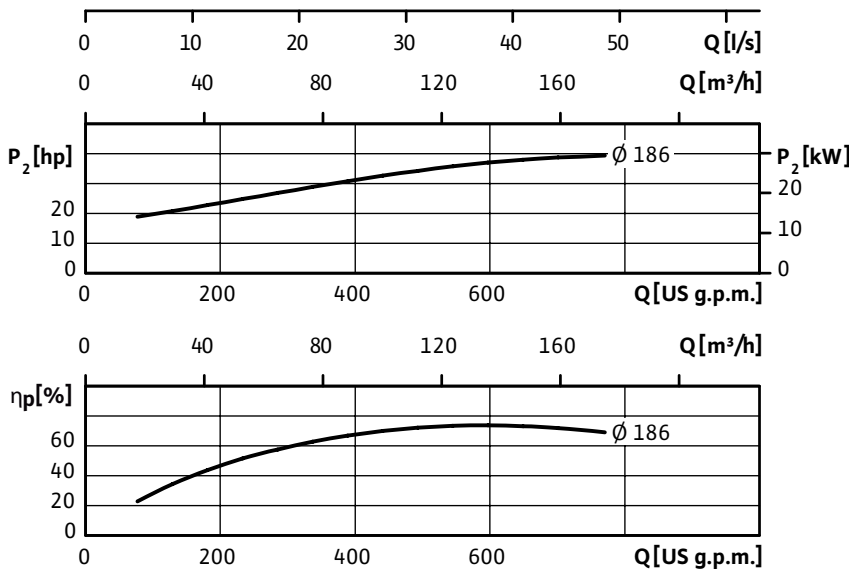

Applications	
• Hot water heating systems	• Industrial circulation systems
• Air conditioning systems	• Solar Systems
• Closed cooling circuits	• Geothermal Systems

Approval Stamp

Dimensions & Weights

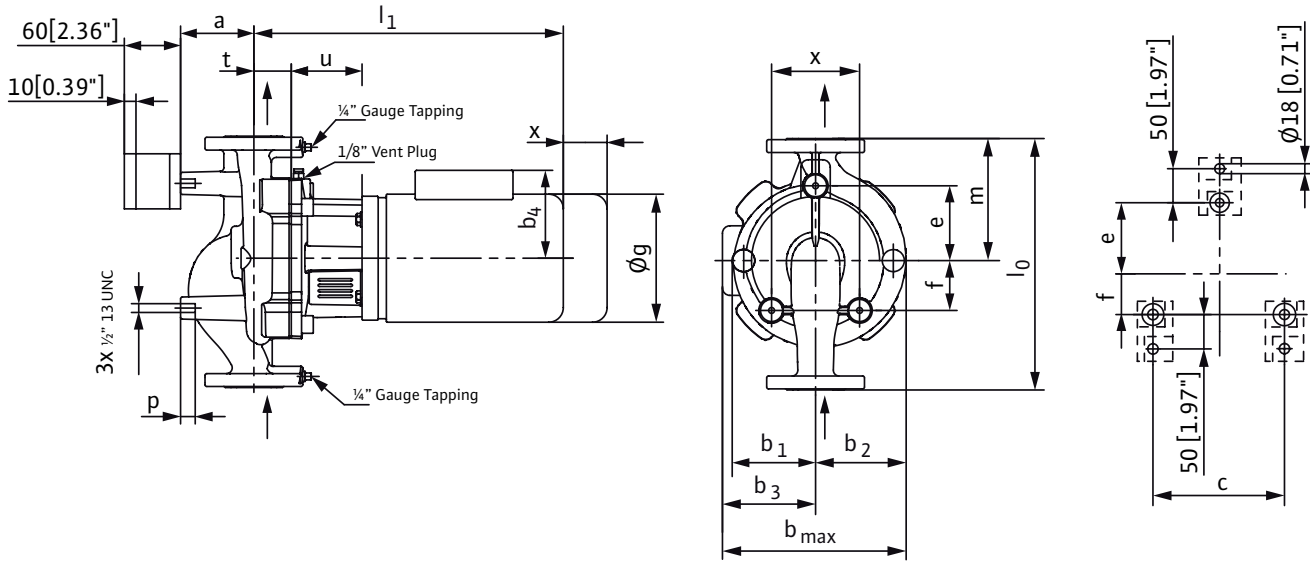

Dimensions and Weights

Model	Dia	Dimensions-inches (mm)																	Weight
		l ₀	a	b ₁	b ₂	b ₃	b ₄	b _{max}	c	e	f	φg	l ₁	m	p	t	u	x	
IL 3-220/770-2	3	21	5 ^{11/16}	6 ^{3/16}	7 ^{3/16}	11 ^{3/16}	-	18 ^{3/8}	8 ^{11/16}	6 ^{11/16}	2 ^{7/16}	11 ^{9/16}	30 ^{3/8}	9 ^{11/16}	1 ^{3/16}	3 ^{1/16}	5 ^{1/8}	5	443 lbs
	3	(533)	(145)	(157)	(182)	(285)	-	(467)	(220)	(170)	(62)	(293)	(772)	(246)	(20)	(78)	(131)	(127)	201 kg

Flange Dimensions

Dimensions - Inches (mm)				
DN	φD	φd ₁	φk	n x d _L
3	8 ^{1/4}	5 ^{11/16}	6	4 x 3/4
	(210)	(145)	(152)	(4 x 19)

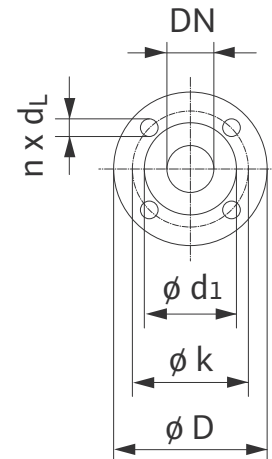

TEFC Motor Data

Model	P2	Phase	Voltage	FLA
	[HP]	[-]	[V]	[A]
IL 3-220/770-2	40	3	208-230/460	90/45

Submittal Data Sheet

Wilo IL - Inline Centrifugal Circulators



Wilo IL 4-140 3500 RPM



Project:								
Engineer:								
Contractor:								
Submitted By:					Date:			
Approved By:					Date:			

Tag #	Model #	Flow	Head	HP	Cycle	Phase	Voltage	RPM
					60Hz			3,500 (2 Pole)

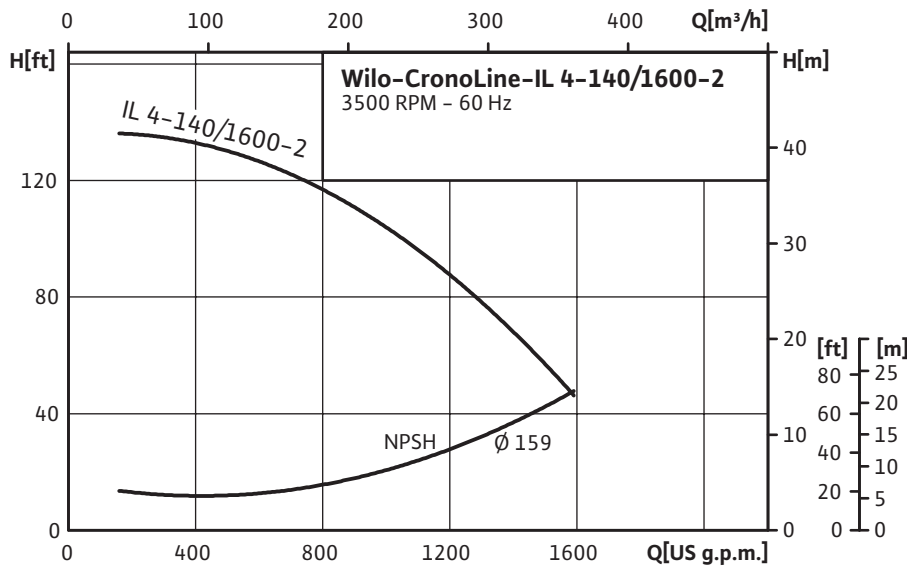

Technical Data	
Temp Range:	-5 °F to + 285 °F (-20 °C to +140 °C)
Power Supply	3-208-230/460, 575 volt
Motor Options	TEFC, (ODP Opt), EPACK Rated
Flange Connection	1 1/4" to 4" NPT with 1/4" pres- sure gauge tappings
Max operating pressure:	250 PSI (16 bar)

Materials of Construction	
Pump volute	Cast Iron
Impeller	Bronze (cast iron optional)
Shaft	316L stainless steel
Mechanical seal	Q1Q1X4GG (silicium carbide seal faces, HNBR elastomers)

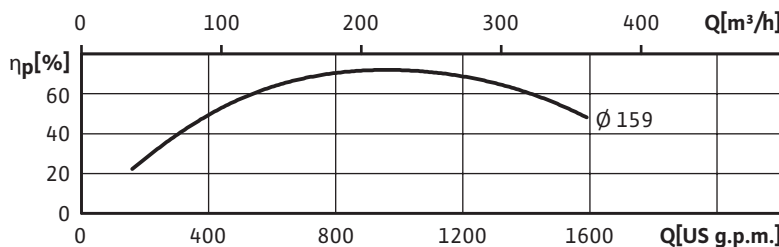
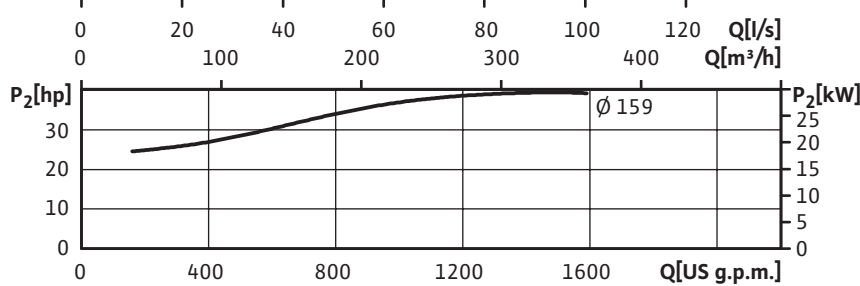

Applications	
• Hot water heating systems	• Industrial circulation systems
• Air conditioning systems	• Solar Systems
• Closed cooling circuits	• Geothermal Systems

Approval Stamp

Dimensions & Weights

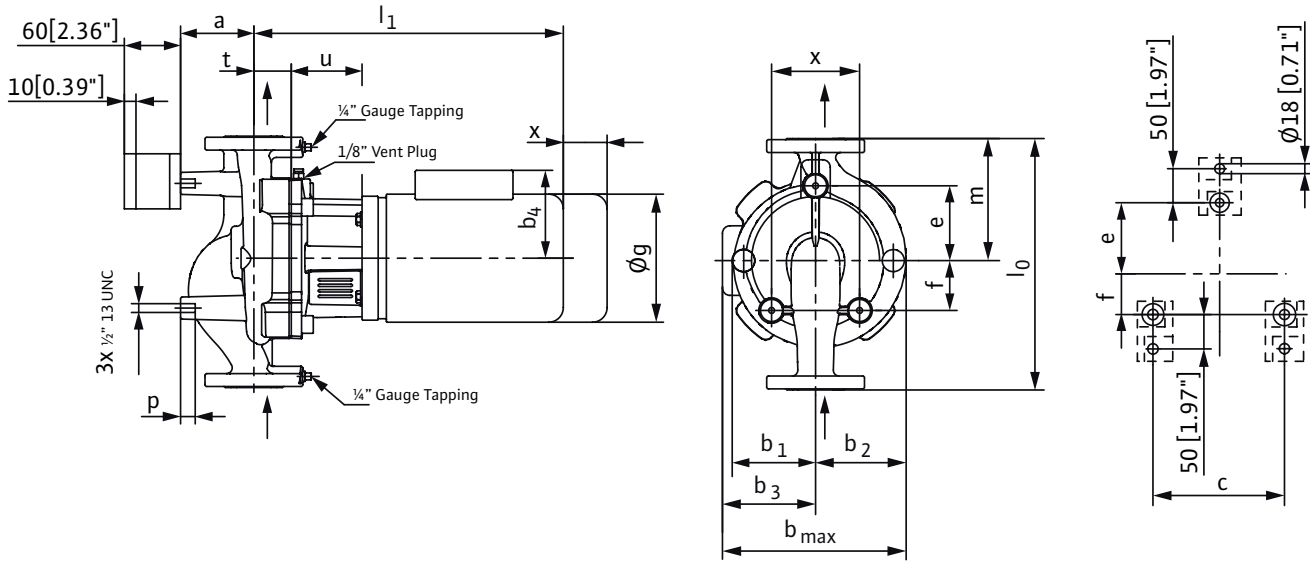

Dimensions and Weights

Model	Dia	Dimensions-inches (mm)																	Weight
		l ₀	a	b ₁	b ₂	b ₃	b ₄	b _{max}	c	e	f	φg	l ₁	m	p	t	u	x	
IL 4-140/1600-2	4	20 ¹ / ₂	5 ³ / ₁₆	6 ¹ / ₄	7 ¹¹ / ₁₆	11 ³ / ₁₆	-	18 ¹⁵ / ₁₆	7 ⁷ / ₈	9 ³ / ₁₆	2 ³ / ₈	11 ⁹ / ₁₆	31 ¹¹ / ₁₆	10 ⁵ / ₁₆	1 ³ / ₁₆	4 ⁵ / ₁₆	5 ³ / ₁₆	6	448 lbs
	4	(521)	(132)	(158)	(196)	(285)	-	(481)	(200)	(234)	(60)	(293)	(805)	(262)	(20)	(110)	(131)	(152)	203 kg

Flange Dimensions

DN	Dimensions - Inches (mm)			
	φD	φd ₁	φk	n x d _L
4	10	6 ¹⁵ / ₁₆	7 ¹ / ₂	8 x 3/4
	(254)	(176)	(191)	(8 x 19)

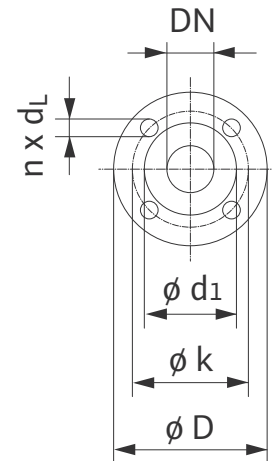

TEFC Motor Data

Model	P2	Phase	Voltage	FLA
	[HP]	[~]	[V]	[A]
IL 4-140/1600-2	40	3	208-230/460	90/45

Submittal Data Sheet

Wilco IL - Inline Centrifugal Circulators



Wilco IL 4-190 3500 RPM



Project:								
Engineer:								
Contractor:								
Submitted By:					Date:			
Approved By:					Date:			

Tag #	Model #	Flow	Head	HP	Cycle	Phase	Voltage	RPM
					60Hz			3,500 (2 Pole)

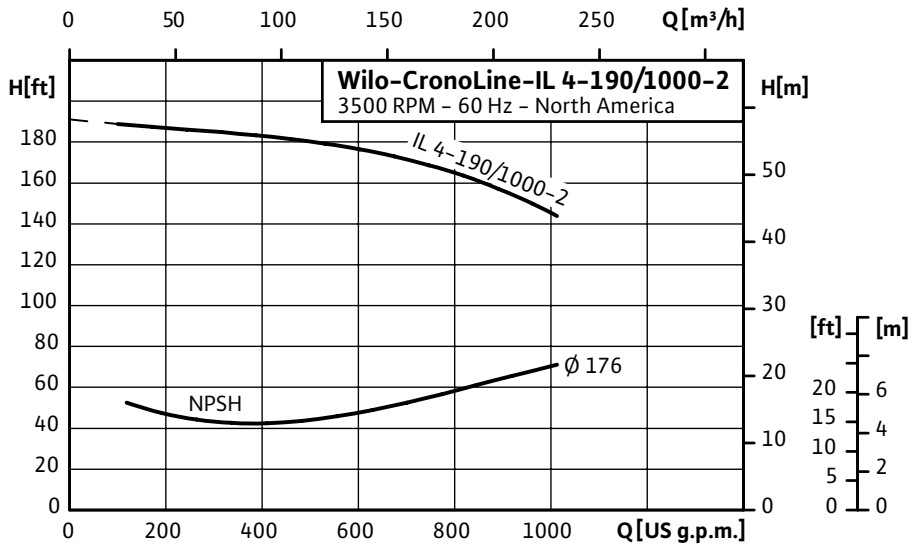

Technical Data	
Temp Range:	-5 °F to +285 °F (-20 °C to +140 °C)
Power Supply	3-208-230/460, 575 volt
Motor Options	TEFC, (ODP Opt), EPACK Rated
Flange Connection	1 1/4" to 4" NPT with 1/4" pressure gauge tappings
Max operating pressure:	250 PSI (16 bar)

Materials of Construction	
Pump volute	Cast iron
Impeller	Bronze (cast iron optional)
Shaft	316L stainless steel
Mechanical seal	Q1Q1X4GG (silicium carbide seal faces, HNBR elastomers)

Applications	
• Hot water heating systems	• Industrial circulation systems
• Air conditioning systems	• Solar Systems
• Closed cooling circuits	• Geothermal Systems

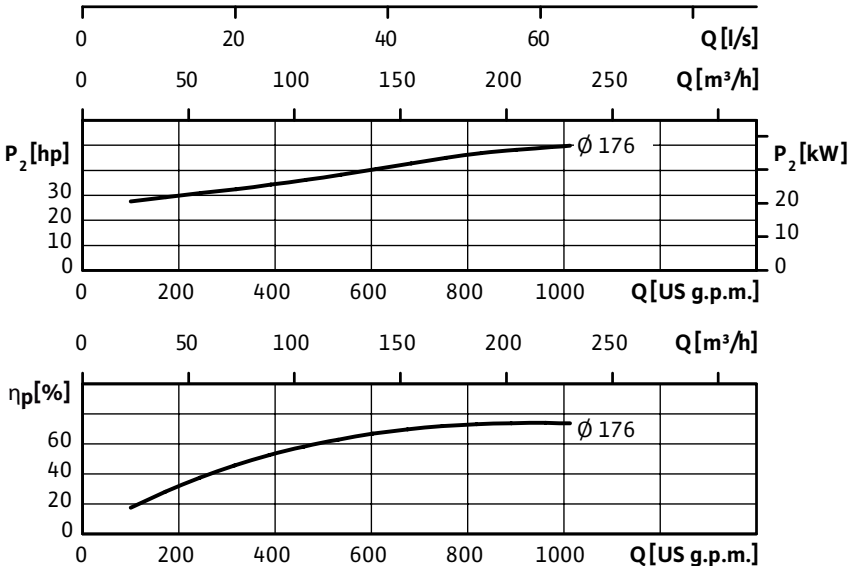

Approval Stamp

Dimensions & Weights

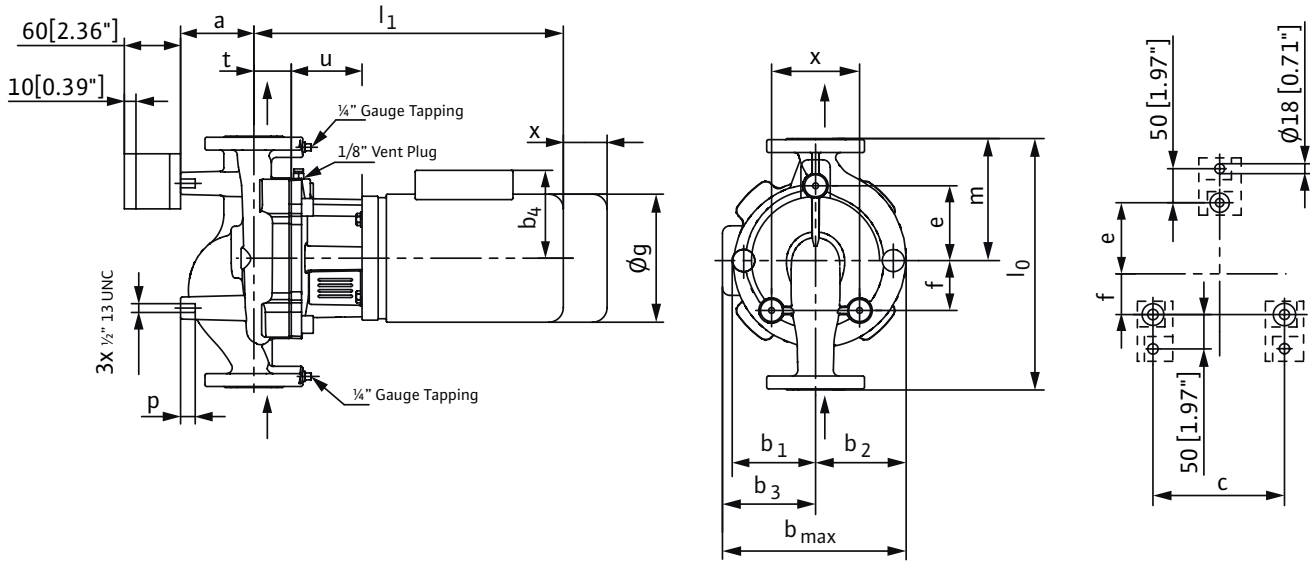

Dimensions and Weights

Model	Dia	Dimensions—inches (mm)																Weight	
		l ₀	a	b ₁	b ₂	b ₃	b ₄	b _{max}	c	e	f	φg	l ₁	m	p	t	u		x
IL 4-190/1000-2	4	22	6 ³ / ₈	6 ¹³ / ₁₆	7 ¹⁵ / ₁₆	12 ³ / ₁₆	-	20 ³ / ₁₆	8 ¹¹ / ₁₆	9 ³ / ₁₆	3 ⁷ / ₈	-	34 ¹³ / ₁₆	10 ³ / ₁₆	1 ³ / ₁₆	3 ⁷ / ₁₆	5 ¹¹ / ₁₆	5	604 lbs
	4	(559)	(155)	(173)	(202)	(310)	-	(512)	(220)	(233)	(99)	-	(884)	(260)	(20)	(88)	(144)	(127)	274 kg

Flange Dimensions

Dimensions - Inches (mm)				
DN	φD	φd ₁	φk	n x d _L
4	10	6 ¹⁵ / ₁₆	7 ¹ / ₂	8 x 3/4
	(254)	(176)	(191)	(8 x 19)

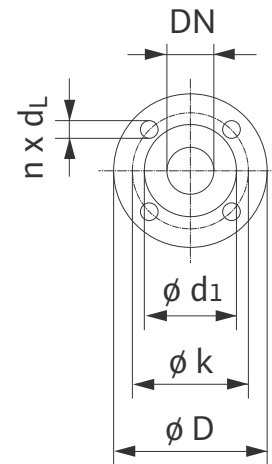

TEFC Motor Data

Model	P2	Phase	Voltage	FLA
	[HP]	[~]	[V]	[A]
IL 4-190/1000-2	50	3	208-230/460	112/56