

Wilo 3", 4" Submersibles

Data Booklet





Wilo-Quick Solar
Wilo-Opti Solar

Depths up to 755ft
Up to AC/DC compatible

Ask your Wilo representative today for details.

Wilo-TWU 3 HS (3" High-Speed Submersible Pumps with Noryl Impellers)

10 GPM	4
15 GPM	5
25 GPM	6

Wilo-TWI 4 (4" Stainless Steel Submersible Well Pumps)

General Material Data	7
Curves & Quick Select Charts	
5 GPM	8
7 GPM	10
10 GPM	12
18 GPM	14
25 GPM	16
40 GPM	18
70 GPM	20
Weights & Dimensions	
5, 7, 10 GPM	22
18, 25 GPM	24
40, 70 GPM	26

TWU 4 (4" Submersible Well Pumps with Noryl Impeller)

General Material Data	29
Curves & Quick Select Charts	
5 GPM	30
7 GPM	32
10 GPM	34
13 GPM	36
18 GPM	38
25 GPM	40
35 GPM	42
55 GPM	44
80 GPM	46
Weights & Dimensions	
5, 7 GPM	48
10, 13, 18 GPM	50
25, 35 GPM	52
55, 80 GPM	54

Motor Data

4" Motors	55
Wire Sizing	59

Wilo-Sub TWU 3 HS – 10 GPM

High-Speed Submersible Pumps with Noryl Impellers



Wilo-Sub TWU3.10 – 10 GPM

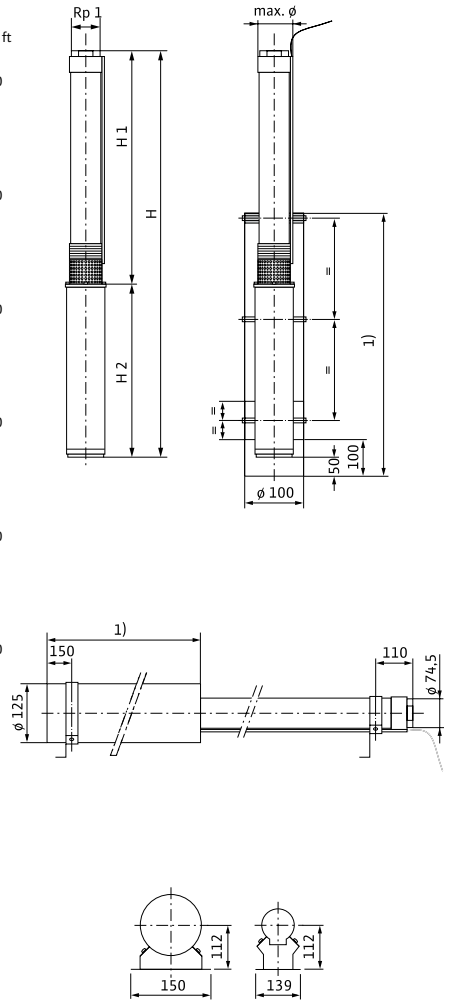
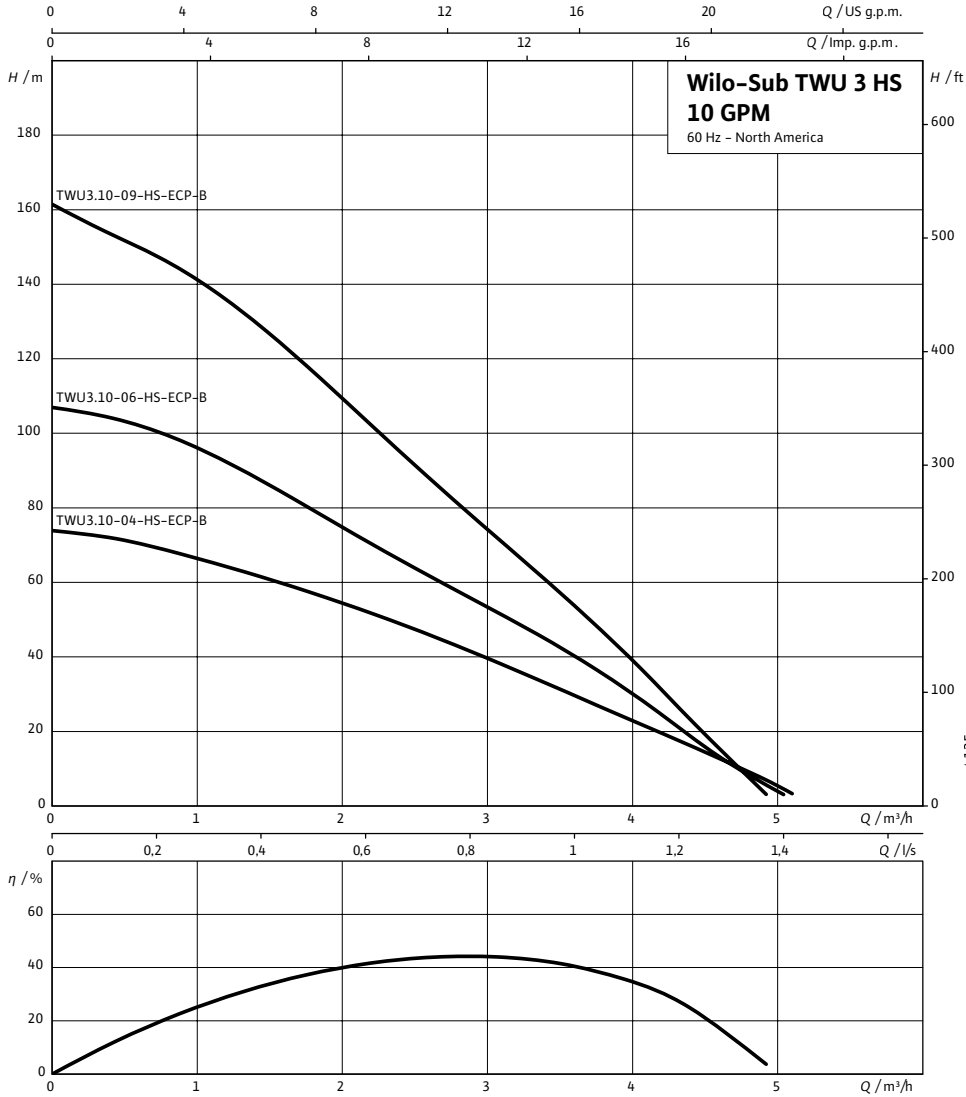

Weights and Dimensions

Model	Motor Dia. (in)	Power (HP)	Voltage	FLA	NPT (in)	Dimensions (in)			Cable Length (ft)	Weight (lbs)	Article Number
						H	H1	H2			
TWU3.10-04-HS-ECP-B	3	¾	1~ 230V	8.3	1	473	256	217	6	9.92	6079396
TWU3.10-06-HS-ECP-B	3	1	1~ 230V	10.4	1	521	304	217	6	11.24	6079397
TWU3.10-09-HS-ECP-B	3	1½	1~ 230V	14.5	1	597	380	217	6	12.13	6079398

Wilo-Sub TWU 3 HS - 15 GPM

High-Speed Submersible Pumps with Noryl Impellers



Wilo-Sub TWU3.15- 15 GPM

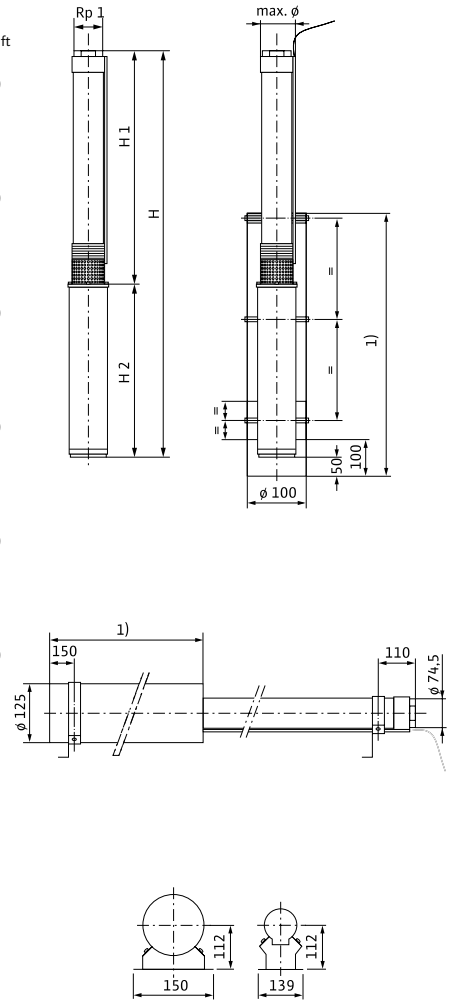
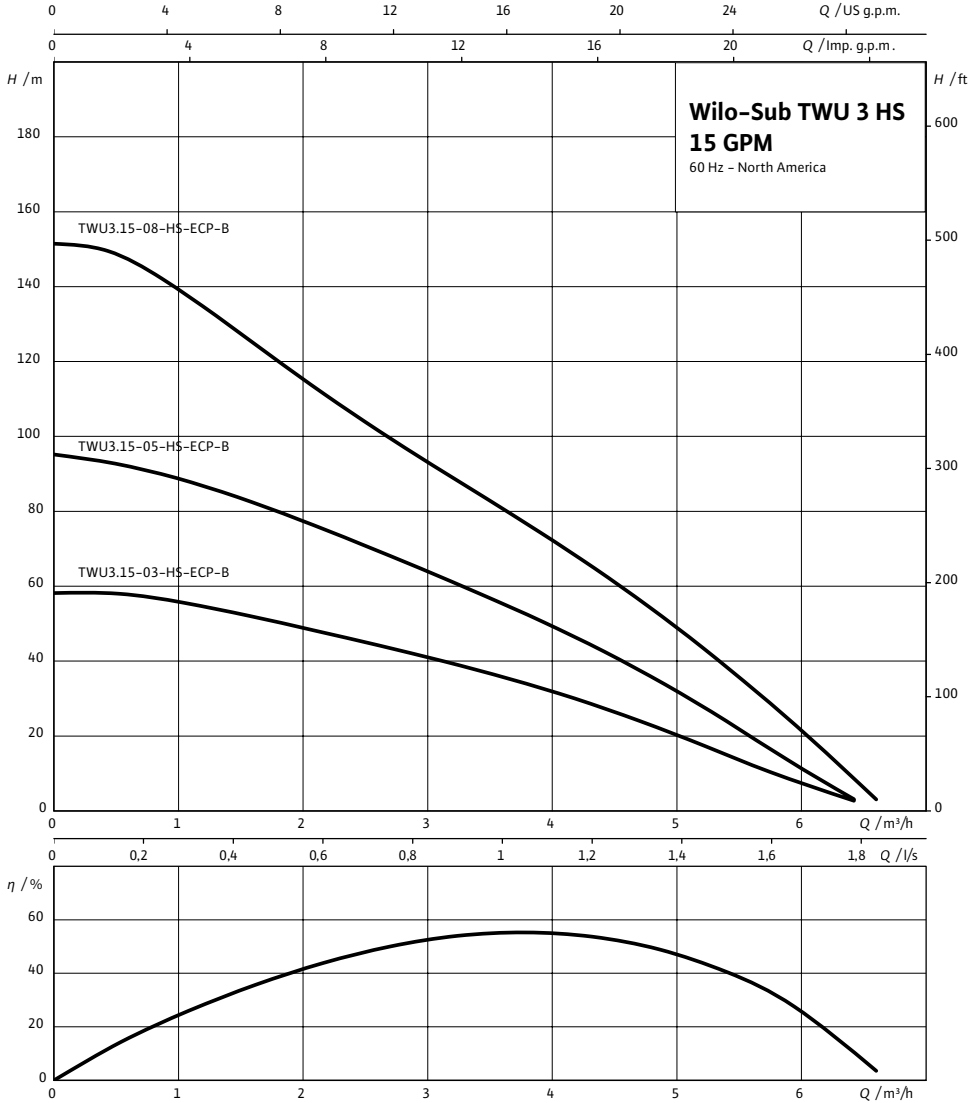

Weights and Dimensions											
Model	Motor Dia. (in)	Power (HP)	Voltage	FLA	NPT (in)	Dimensions (in)			Cable Length (ft)	Weight (lbs)	Article Number
						H	H1	H2			
TWU3.15-03-HS-ECP-B	3	¾	1~ 230V	8.3	1¼	447	230	217	6	9.7	6079399
TWU3.15-05-HS-ECP-B	3	1	1~ 230V	10.4	1¼	499	282	217	6	5	6079400
TWU3.15-08-HS-ECP-B	3	1½	1~ 230V	14.5	1¼	571	354	217	6	11.02	6079401

Wilo-Sub TWU 3 HS – 25 GPM

High-Speed Submersible Pumps with Noryl Impellers



Wilo-Sub TWU3.25 – 25 GPM

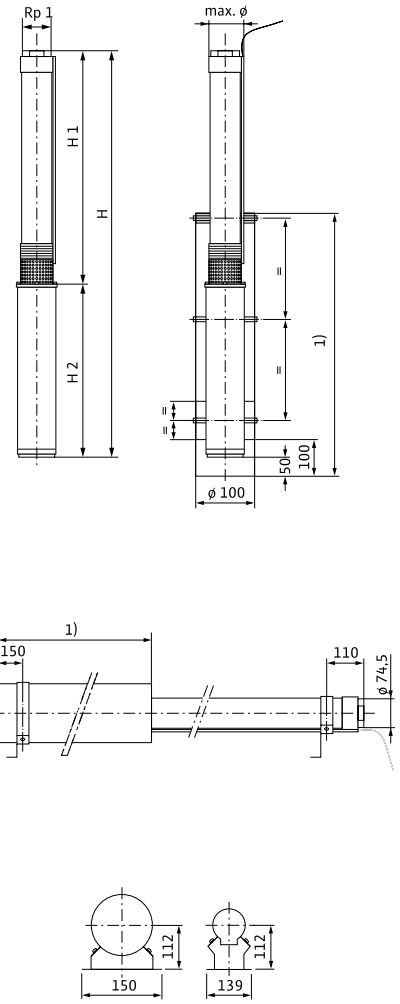
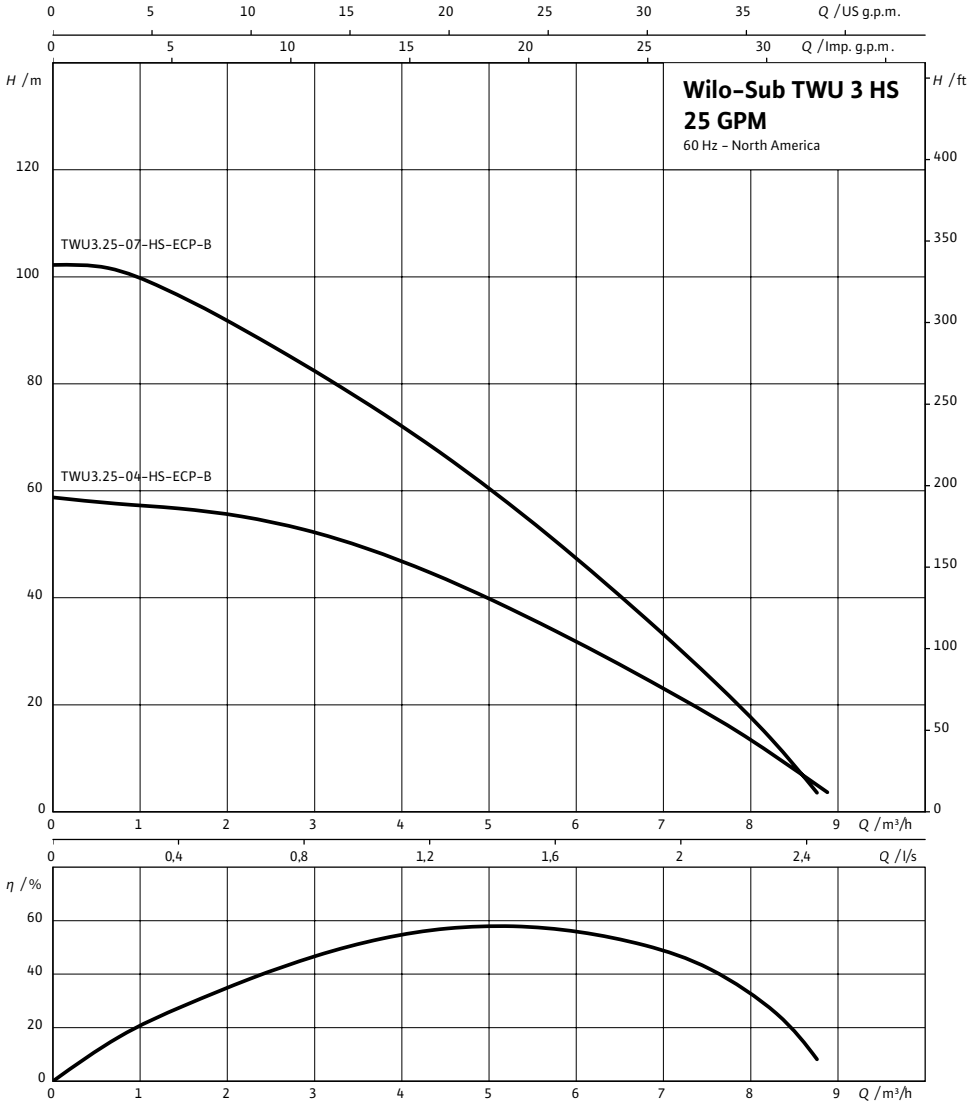

Weights and Dimensions

Model	Motor Dia. (in)	Power (HP)	Voltage	FLA	NPT (in)	Dimensions (in)			Cable Length (ft)	Weight (lbs)	Article Number
						H	H1	H2			
TWU3.22-04-HS-ECP-B	3	¾	1~230V	10.4	1¼	395	178	217	6	11.02	6079402
TWU3.22-07-HS-ECP-B	3	1½	1~230V	14.5	1¼	587	370	217	6	11.91	6079403

General Material Data

TWI 4"

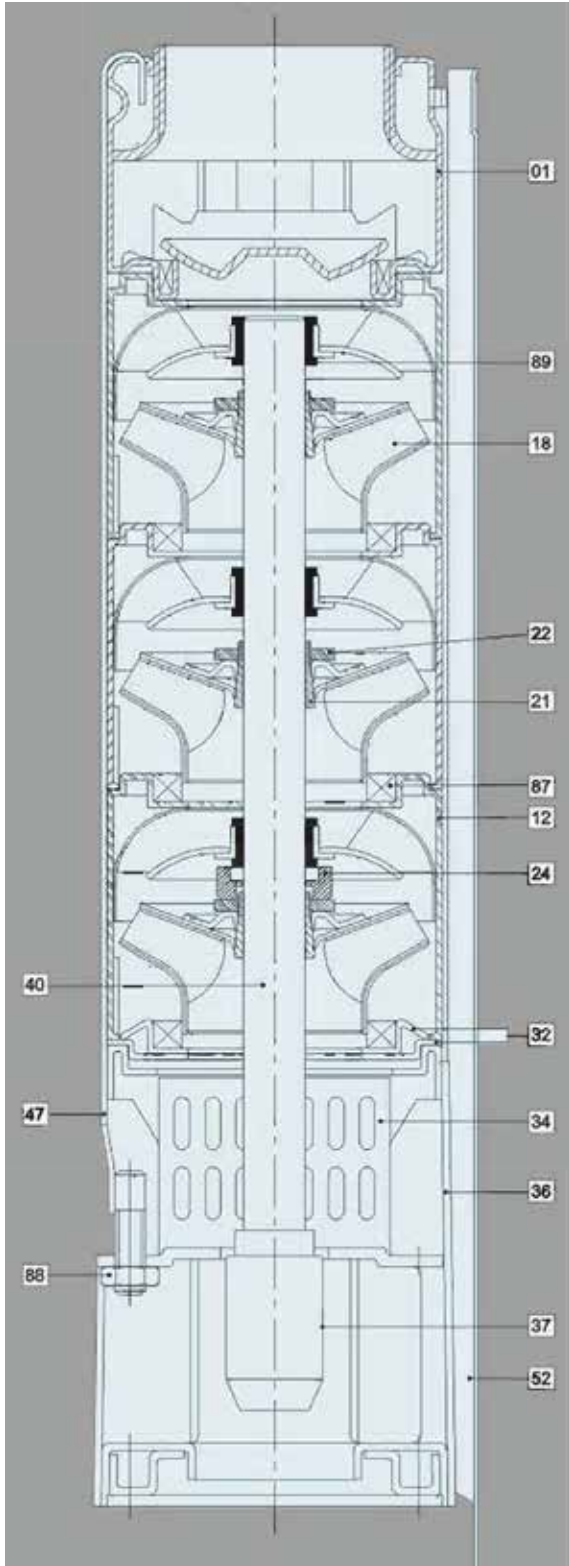

Pos.	Components	Material	Standard
01	Discharge	Stainless Steel	304
12	Diffuser	Stainless Steel	304
18	Impeller	Stainless Steel	304
21	Split Cone	Stainless Steel	304
22	Split Cone Nut	Stainless Steel	304
24	Stop Ring	Carbon/ Graphite/PTFE	
32	Neck Ring Retainer	Stainless Steel	304
24	Strainer	Stainless Steel	304
26	Suction Interconnector	Stainless Steel	304
40	Pump Shaft	Stainless Steel	304
37	Coupling	Stainless Steel	304
47	Strap	Stainless Steel	304
52	Cable Guard	Stainless Steel	304
87	Neck Ring	Stainless Steel	304
88	Nut	Stainless Steel	304
89	Bearing	NBR	

*AISI 316 Stainless Steel Pumps are available on request.

Wilo-TWI 4.05

Stainless Steel Submersible Well Pumps



5 GPM

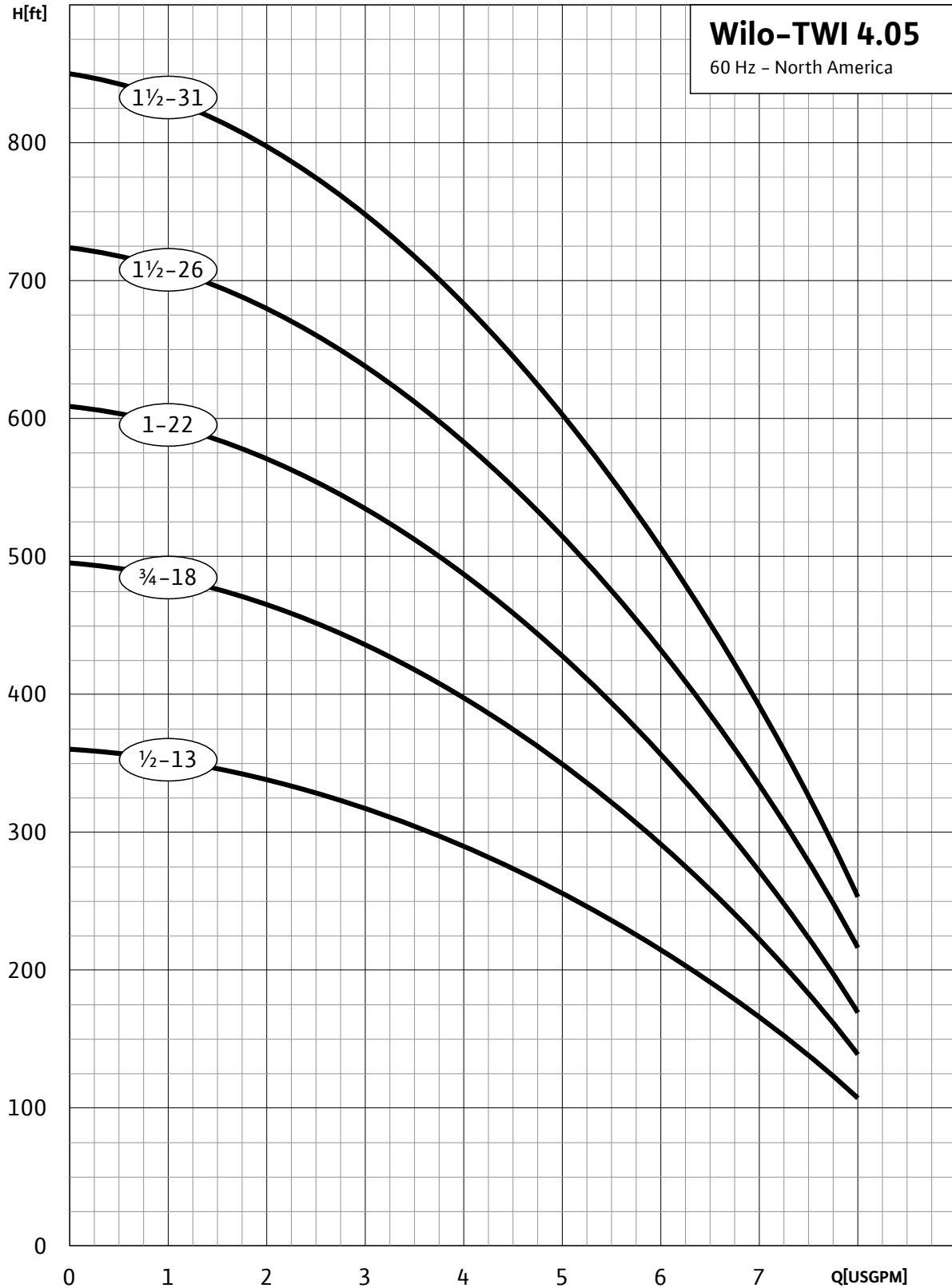

MODEL	HP	PSI	Depth to Water in Feet																												
			20	40	60	80	100	120	140	160	180	200	220	240	260	280	300	340	380	420	460	500	540	580	620	660	700	740	780		
TWI4.05-13	½	0								7.4	6.9	6.5	6.0	5.5	5.1	4.6	4.1	3.4													
		20					7.2	6.8	6.3	5.8	5.4	4.9	4.5	3.9	3.2	2.2															
		30				7.2	6.7	6.2	5.8	5.3	4.9	4.4	3.8	3.1	2.0																
		40		7.5	7.1	6.6	6.2	5.7	5.2	4.8	4.3	3.7	2.9	1.8																	
		50	7.5	7.0	6.6	6.1	5.6	5.2	4.7	4.2	3.6	2.8	1.5																		
		60	7.0	6.5	6.0	5.6	5.1	4.6	4.1	3.5	2.6																				
Shut-off PSI			144	135	126	118	109	101	92	83	75	66	57	49	40	31	23														
TWI4.05-18	¾	0									7.9	7.6	7.3	7.0	6.6	6.3	5.9	5.6	4.9	4.2	3.3	1.8									
		20						7.8	7.5	6.8	6.5	6.2	5.8	5.5	5.2	4.8	4.1	3.1	1.4												
		30						7.8	7.5	7.1	6.8	6.5	6.1	5.8	5.4	5.1	4.8	4.4	3.6	2.3											
		40				7.7	7.4	7.1	6.7	6.4	6.1	5.7	5.4	5.1	4.7	4.4	4.0	2.9	1.1												
		50			7.7	7.4	7.0	6.7	6.3	6.0	5.7	5.3	5.0	4.7	4.3	3.9	3.4	2.0													
		60		7.6	7.3	7.0	6.6	6.3	6.0	5.6	5.3	5.0	4.6	4.3	3.9	3.4	2.7														
Shut-off PSI			202	193	185	176	167	159	150	141	133	124	116	107	98	90	81	64	46	29	12										
TWI4.05-22	1	0											7.6	7.3	7.1	6.8	6.5	6.0	5.4	4.9	4.3	3.6	2.6								
		20										7.5	7.3	7.0	6.7	6.4	6.2	5.9	5.3	4.8	4.2	3.5	2.4								
		30										7.5	7.2	6.9	6.7	6.4	6.1	5.8	5.6	5.0	4.5	3.8	2.9	1.5							
		40								7.4	7.2	6.9	6.6	6.3	6.1	5.8	5.5	5.2	4.7	4.1	3.3	2.2									
		50								7.4	7.1	6.9	6.6	6.3	6.0	5.7	5.5	5.2	4.9	4.4	3.7	2.7	1.2								
		60								7.4	7.1	6.8	6.5	6.3	6.0	5.7	5.4	5.2	4.9	4.0	3.2	1.9									
Shut-off PSI							215	206	197	189	180	171	163	154	145	137	128	111	94	76	59	42	24								
TWI4.05-26	1½	0												7.8	7.6	7.4	7.2	6.7	6.2	5.7	5.3	4.8	4.4	3.8	3.0	1.9					
		20												7.5	7.3	7.1	6.9	6.6	6.1	5.7	5.2	4.8	4.3	3.7	2.9	1.7					
		30												7.5	7.3	7.1	6.8	6.6	6.3	5.9	5.4	5.0	4.5	4.0	3.3	2.3					
		40												7.5	7.2	7.0	6.8	6.5	6.3	6.1	5.6	5.2	4.7	4.2	3.6	2.7	1.5				
		50										7.4	7.2	7.0	6.7	6.5	6.3	6.0	5.8	5.3	4.9	4.4	3.9	3.1	2.1						
		60										7.4	7.2	6.9	6.7	6.5	6.2	6.0	5.8	5.5	5.1	4.6	4.1	3.5	2.6						
Shut-off PSI								244	235	226	218	209	201	192	183	175	157	140	123	105	88	71	53	36	19						
TWI4.05-31	1½	0															7.7	7.3	6.9	6.5	6.2	5.8	5.4	5.0	4.6	4.2	3.7	3.0	2.1		
		20															7.4	7.3	6.9	6.5	6.1	5.7	5.3	4.9	4.5	4.1	3.6	2.9	1.9		
		30															7.4	7.2	7.0	6.7	6.3	5.9	5.5	5.1	4.7	4.3	3.8	3.2	1.4	1.2	
		40															7.4	7.2	7.0	6.8	6.4	6.0	5.6	5.3	4.9	4.5	4.0	3.5	2.8	1.8	
		50															7.5	7.4	7.2	7.0	6.8	6.6	6.2	5.8	5.4	5.0	4.7	4.2	3.7	3.1	2.2
		60															7.5	7.3	7.1	7.0	6.8	6.6	6.4	6.0	5.6	5.2	4.8	4.4	4.0	3.4	2.6
Shut-off PSI													285	276	268	259	250	242	233	216	198	181	164	146	129	112	95	77	60	43	25



Wilo-TWI 4.07

Stainless Steel Submersible Well Pumps



7 GPM

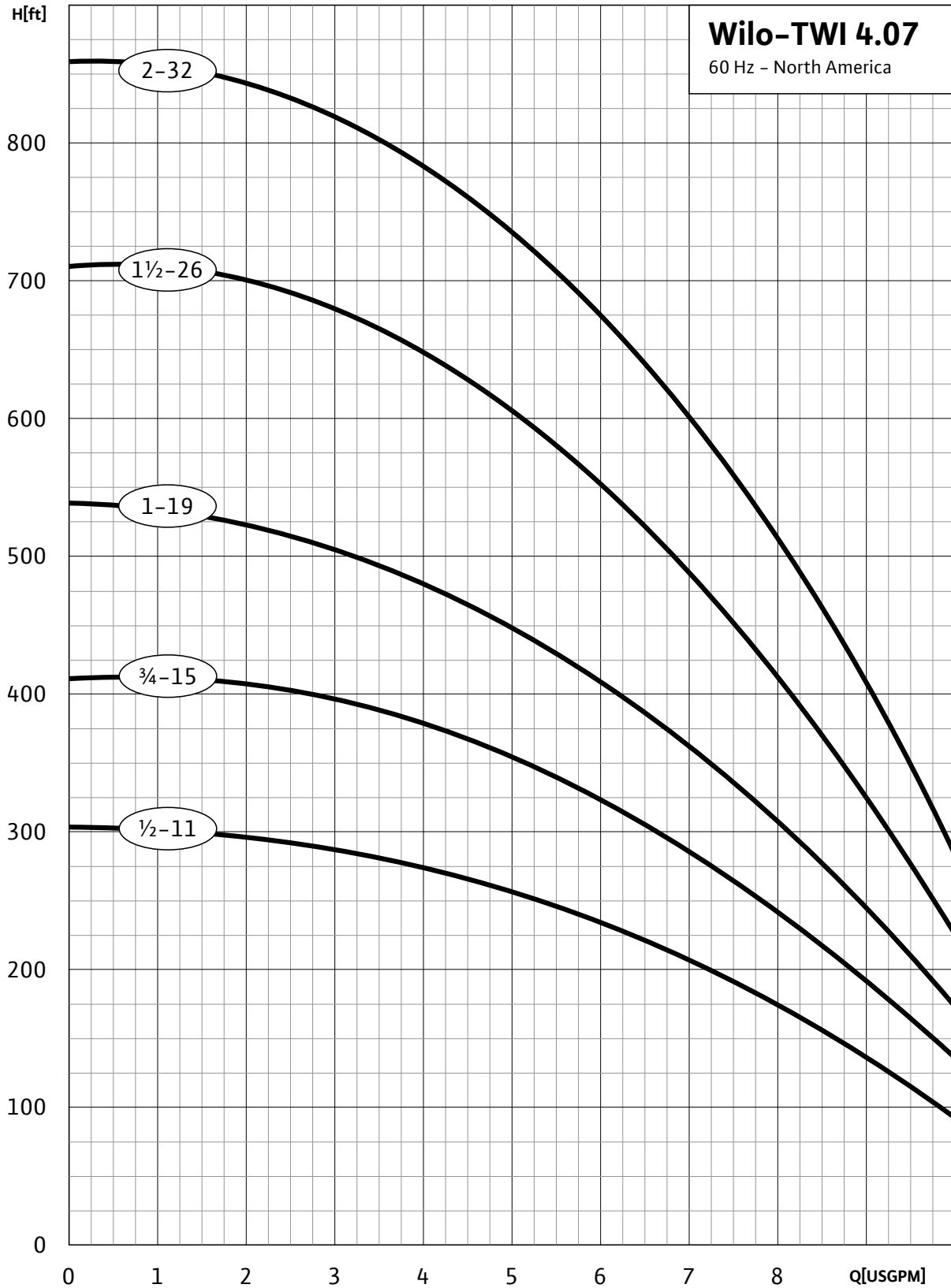

MODEL	HP	PSI	Depth to Water in Feet																					
			20	40	60	80	100	120	140	160	180	200	220	240	260	280	300	340	400	460	520	600	700	
TWI4.07-11.05	½	0					9.9	9.5	8.9	8.4	7.8	7.3	6.7	6.0	5.0	4.0								
		20			9.8	9.3	8.8	8.2	7.7	7.1	6.5	5.8	4.7	3.5	1.8									
		30	10.1	9.7	9.2	8.7	8.1	7.6	7.0	6.4	5.6	4.7	2.9											
		40	9.6	9.2	8.6	8.1	7.5	6.9	6.2	5.6	4.3	3.0	1.5											
		50	9.1	8.5	8.0	7.4	6.8	6.2	5.3	4.3	2.2													
60	8.4	7.9	7.3	6.8	6.0	5.3	3.8	2.3																
Shut-off PSI			122	113	105	96	87	79	70	61	53	44	35	27	18	10								
TWI4.07-15.07	¾	0					10.2	9.9	9.5	9.2	8.8	8.4	8.0	7.6	7.1	6.7	5.6	2.9						
		20				10.1	9.8	9.4	9.0	8.6	8.2	7.8	7.4	7.0	6.5	6.1	5.4	3.6						
		30			10.0	9.7	9.4	9.0	8.6	8.2	7.8	7.4	6.9	6.5	5.9	5.4	4.5	1.8						
		40		10.0	9.7	9.3	8.9	8.5	8.1	7.7	7.3	6.9	6.4	5.9	5.2	4.5	3.2	1.0						
		50	9.9	9.6	9.2	8.9	8.5	8.1	7.6	7.2	6.8	6.4	5.8	5.2	4.2	3.2	1.6							
60	9.5	9.2	8.8	8.4	8.0	7.6	7.2	6.7	6.2	5.7	4.9	4.2	2.8	1.4										
Shut-off PSI			170	101	153	144	135	127	118	110	101	92	84	75	66	58	49	32	6					
TWI4.07-19.10	1	0								10.1	9.8	9.6	9.3	9.0	8.7	8.4	8.0	7.4	6.4	4.8				
		20					10.0	9.8	9.5	9.2	8.9	8.6	8.3	7.9	7.6	7.3	6.6	5.3	2.8					
		30					10.0	9.7	9.5	9.2	8.9	8.5	8.2	7.9	7.6	7.3	6.9	6.2	4.6	1.4				
		40				10.0	9.7	9.4	9.1	8.8	8.5	8.2	7.8	7.5	7.2	6.9	6.5	5.6	3.7					
		50		10.2	9.9	9.7	9.4	9.1	8.8	8.4	8.1	7.8	7.5	7.2	6.8	6.5	6.0	5.0	2.4					
60	10.1	9.9	9.6	9.3	9.0	8.7	8.4	8.1	7.8	7.4	7.1	6.8	6.4	6.0	5.5	4.2								
Shut-off PSI			218	209	200	192	183	174	166	157	148	140	131	123	114	105	97	79	53	27				
TWI4.07-26.15	1½	0										10.1	9.9	9.7	9.5	9.3	8.8	8.1	7.4	6.7	5.5			
		20									10.0	9.8	9.6	9.4	9.2	9.0	8.8	8.3	7.6	6.9	6.1	4.4		
		30									10.0	9.8	9.6	9.4	9.2	9.0	8.7	8.5	8.0	7.3	6.6	5.7	3.7	
		40					10.1	10.0	9.8	9.6	9.4	9.1	8.9	8.7	8.5	8.2	7.8	7.1	6.3	5.2	2.9			
		50				10.1	9.9	9.7	9.6	9.3	9.1	8.9	8.7	8.4	8.2	8.0	7.5	6.8	5.9	4.7	1.9			
60				10.1	9.9	9.7	9.5	9.3	9.1	8.9	8.6	8.4	8.2	7.9	7.7	7.2	6.5	5.5	4.1					
Shut-off PSI						274	265	257	248	239	231	222	213	205	196	187	179	161	135	110	84	49		
TWI4.07-32.20	2	0										10.6	10.5	10.4	10.4	10.3	10.1	9.6	9.1	8.4	7.3	5.7		
		20									10.5	10.5	10.4	10.3	10.2	10.1	10.0	9.8	9.2	8.6	7.8	6.6	4.8	
		30									10.5	10.5	10.4	10.3	10.2	10.1	10.0	9.9	9.6	9.0	8.3	7.5	6.2	4.3
		40								10.5	10.5	10.4	10.3	10.2	10.1	10.0	9.9	9.7	9.4	8.8	8.0	7.2	5.8	3.9
		50							10.5	10.4	10.3	10.2	10.1	10.0	9.8	9.7	9.5	9.1	8.5	7.7	6.8	5.4	3.3	
60						10.5	10.4	10.3	10.2	10.1	10.0	9.8	9.7	9.5	9.3	8.9	8.2	7.4	6.4	5.0				
Shut-off PSI						343	334	326	317	308	300	291	282	274	265	256	239	213	187	161	126	83		

Wilo-TWI 4.07 weight & dimensional data can be found on page 22



10 GPM

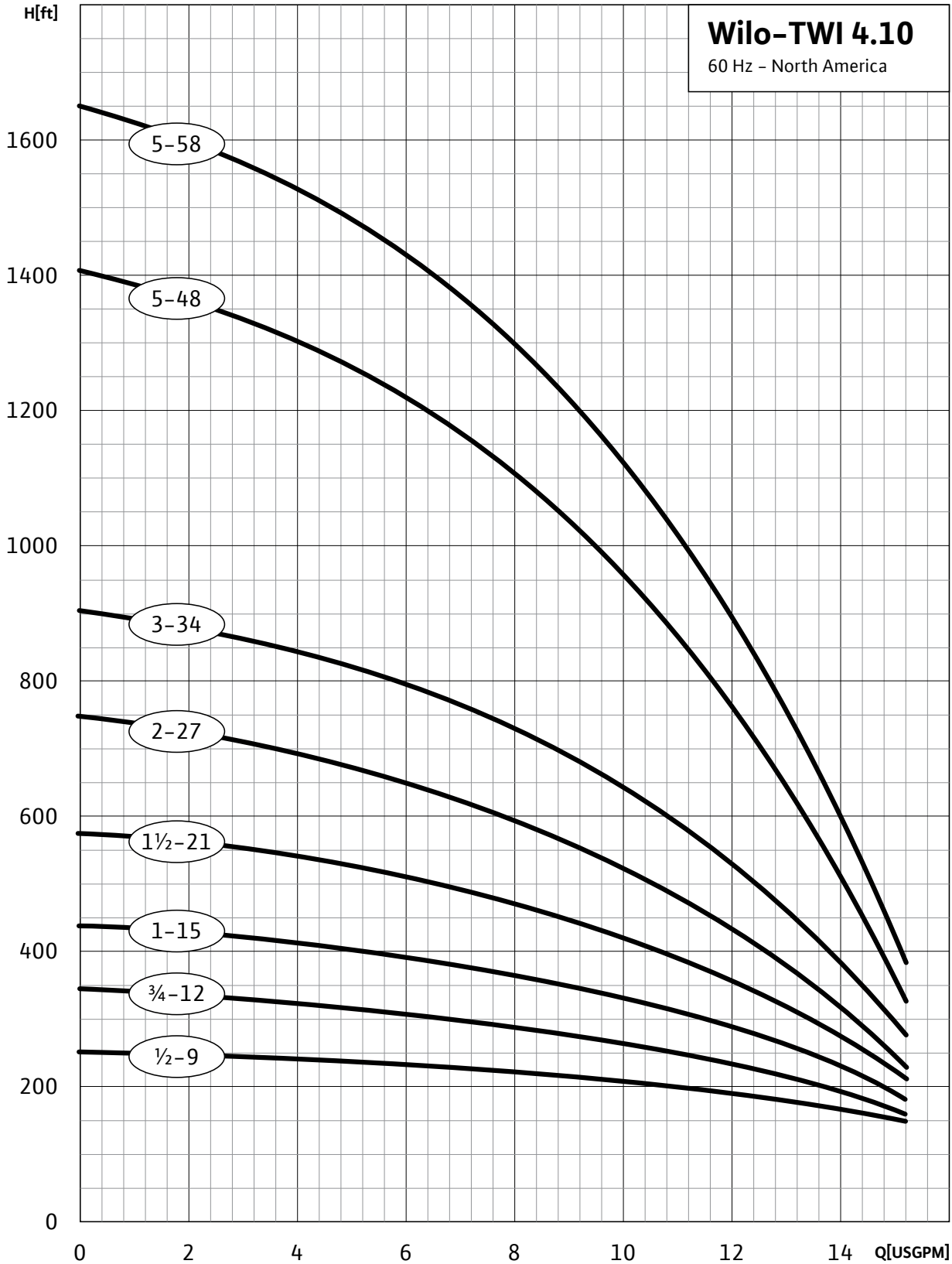

Wilо-TWI 4.18

Stainless Steel Submersible Well Pumps



18 GPM

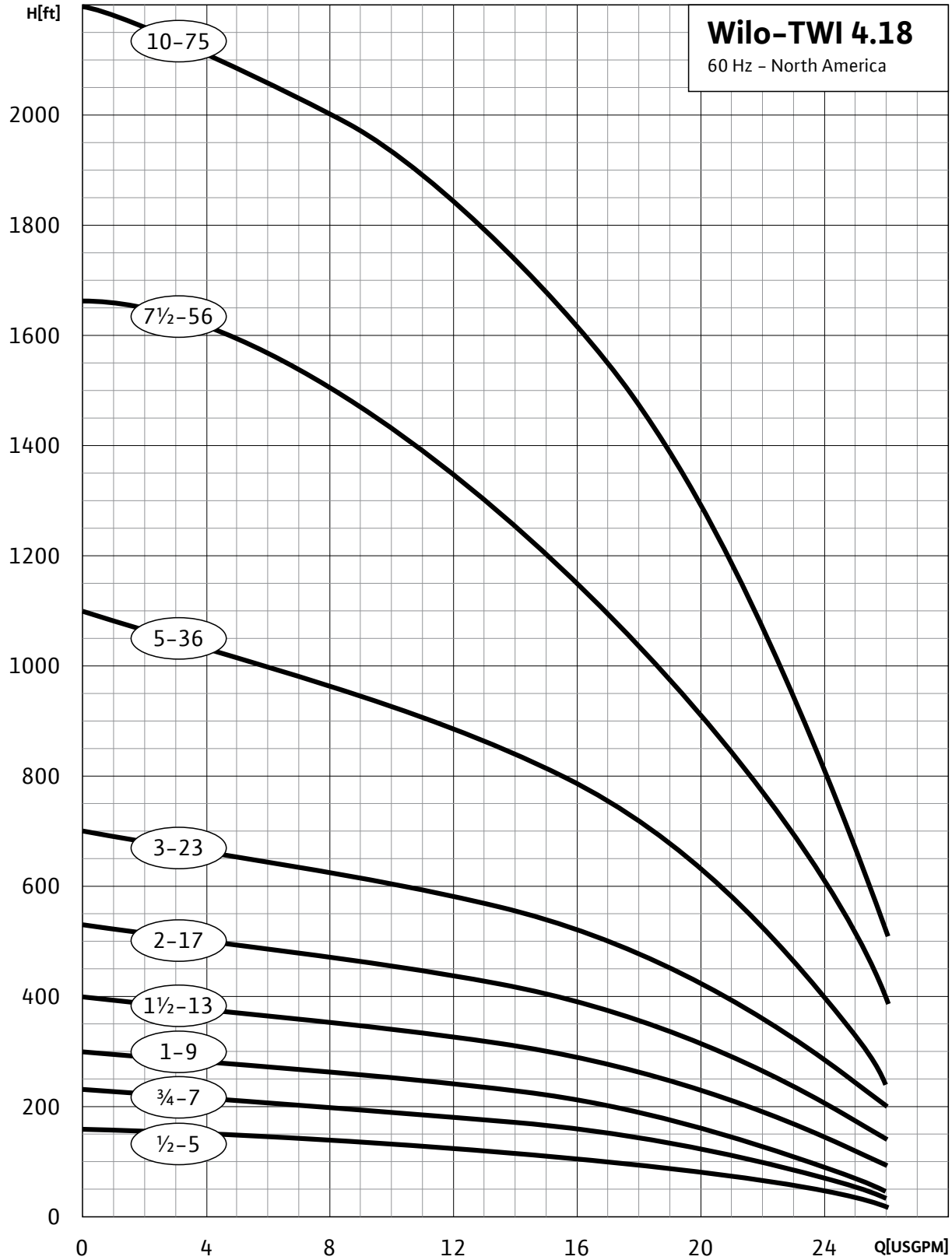

25 GPM

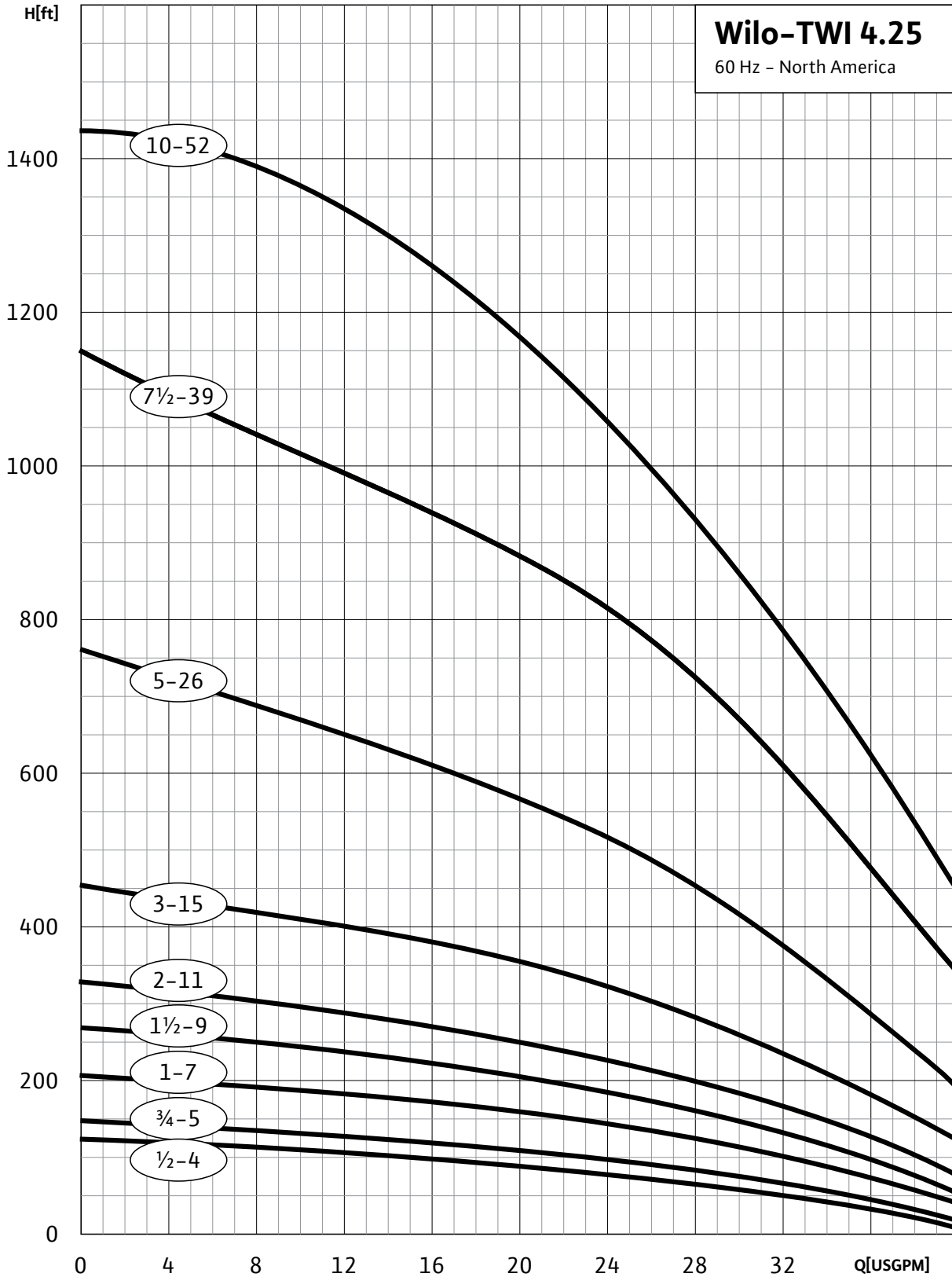

Wilo-TWI 4.40

Stainless Steel Submersible Well Pumps



40 GPM

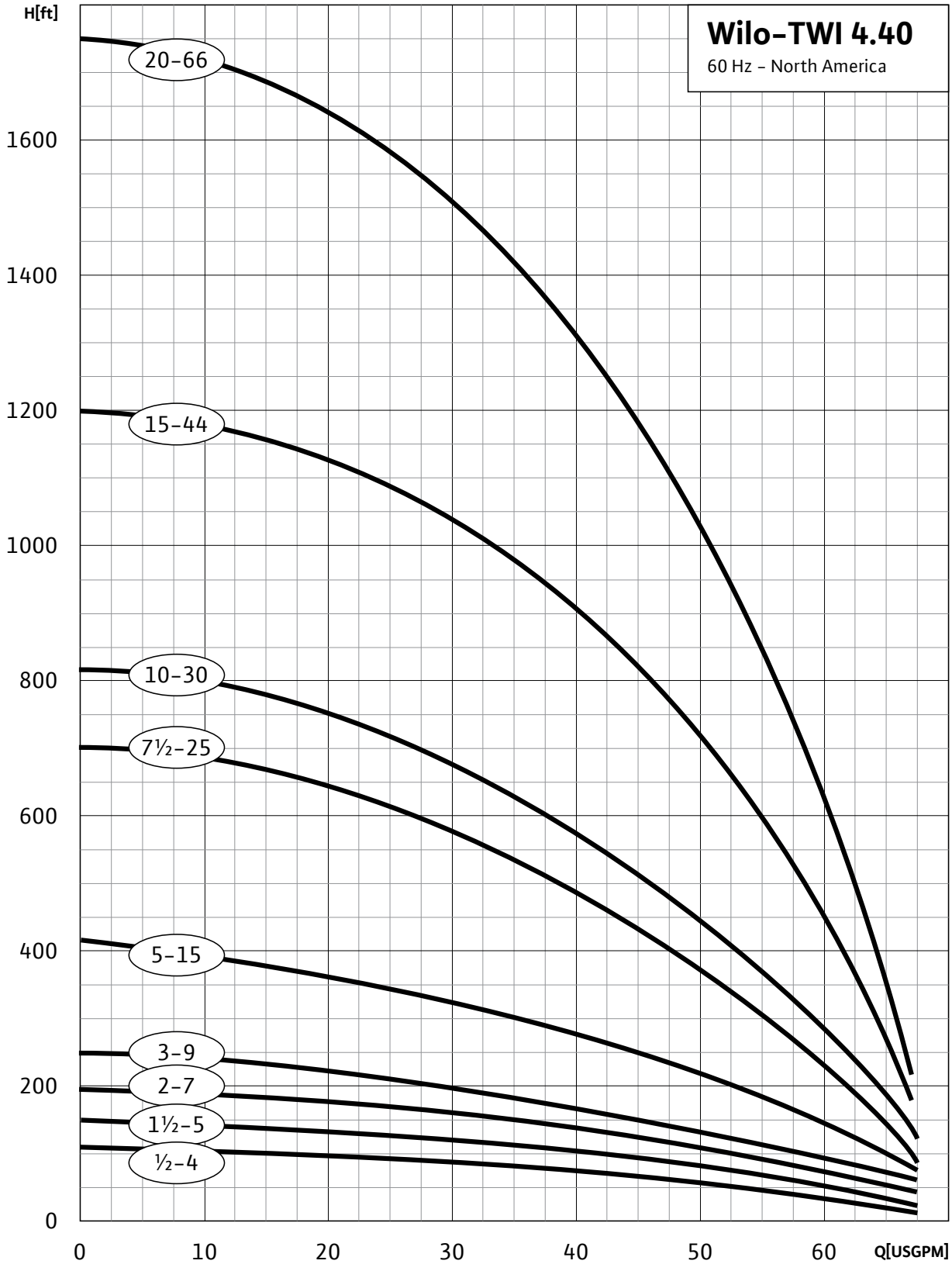

MODEL	HP	PSI	Depth to Water in Feet																														
			20	40	60	80	100	120	140	160	180	200	220	240	260	280	300	340	380	420	460	500	540	580	620	660	700	740	780	800			
TWI4.40-04	1	0		63.5	55.7	43.2																											
		20	53.0	36.5																													
		30	32.7																														
		40																															
		50																															
		60																															
Shut-off PSI			40	32	23	14																											
TWI4.40-05	1½	0			60.1	54.0	43.2	23.4																									
		20	58.2	51.5	38.0																												
		30	50.0	35.0																													
		40	31.9																														
		50																															
		60																															
Shut-off PSI			52	44	35	27	18	9																									
TWI4.40-07	2	0				61.0	56.7	51.7	43.2	29.9																							
		20	64.5	59.6	55.4	49.6	39.6	24.9																									
		30	58.9	54.7	48.3	37.6	22.3																										
		40	53.9	47.0	35.5																												
		50	45.5	33.2																													
		60	30.9																														
Shut-off PSI			77	68	60	51	42	34	25	16																							
TWI4.40-09	3	0				65.6	61.5	58.1	54.8	50.2	43.2	33.2	20.8																				
		20		64.3	60.4	57.1	53.6	48.4	40.4	29.6																							
		30	63.6	59.8	56.6	52.9	47.3	38.9	27.7																								
		40	59.3	56.1	52.2	46.2	37.4	25.7																									
		50	55.6	51.4	45.0	35.7	23.7																										
		60	50.6	43.8	34.0	21.7																											
Shut-off PSI			101	93	84	75	67	58	49	41	32	23	15																				
TWI4.40-15	5	0							64.4	62.1	60.1	58.3	56.3	54.0	51.0	47.1	42.2	29.4															
		20					63.6	61.5	59.5	57.7	55.7	53.2	49.9	45.7	40.5	34.2	27.1																
		30					63.3	61.2	59.3	57.4	55.3	52.7	49.3	45.0	39.6	33.2	26.9																
		40					62.9	60.9	59.0	57.1	54.9	52.2	48.7	44.2	38.6	32.1	24.7																
		50	64.9	62.6	60.6	58.7	56.8	54.6	51.8	48.1	43.4	37.7	31.0	23.5																			
		60	62.3	60.3	58.4	56.5	54.2	51.3	47.4	42.6	36.7	29.9	22.4																				
Shut-off PSI			173	164	156	147	138	130	121	112	104	95	86	78	69	60	52	34															
TWI4.40-25	7½	0											65.3	63.9	62.5	61.3	60.1	57.9	55.5	52.3	48.0	42.2	34.9	26.4									
		20												64.9	63.5	62.2	60.9	59.8	58.7	57.5	55.0	51.7	47.2	41.2	33.7	25.0							
		30													64.7	63.3	62.0	60.7	59.6	58.5	57.4	56.2	53.2	49.3	43.9	37.0	28.8						
		40														64.4	63.1	61.8	60.6	59.4	58.3	57.2	56.0	54.6	51.1	46.4	40.1	32.4	23.6				
		50															65.6	64.2	62.8	61.6	61.8	59.3	58.2	57.0	55.8	54.3	52.7	48.5	42.9	35.8	27.4		
		60																65.4	64.0	62.6	61.4	60.2	59.1	58.0	56.8	55.6	54.1	52.4	50.5	45.5	39.0	31.1	22.1
Shut-off PSI						288	259	251	242	233	225	216	207	199	190	181	173	155	138	121	103	86	69	51									
TWI4.40-30	10	0																															
		20																															
		30																															
		40																															
		50																															
		60																															
Shut-off PSI																																	
Shut-off PSI																																	

Wilo-TWI 4.40 weight & dimensional data can be found on page 26



70 GPM

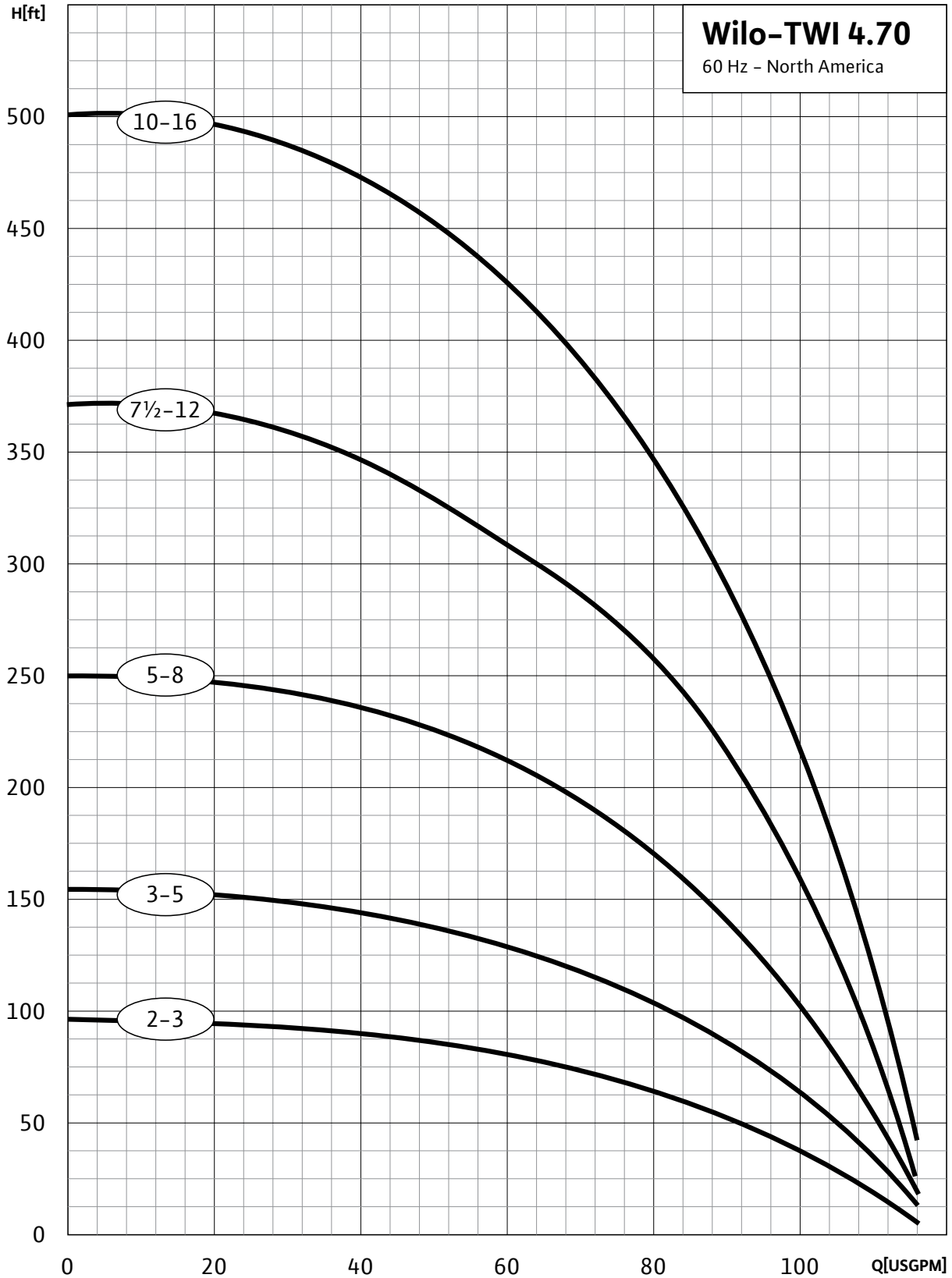

MODEL	HP	PSI	Depth to Water in Feet																			
			20	40	60	80	100	120	140	160	180	200	220	240	260	280	300	340	380	420		
TWI4.70-03	2	0		89.1	68.9	38.8																
		20	60.8																			
		30																				
		40																				
		50																				
		60																				
Shut-off PSI			31	23	14	5																
TWI4.70-05	3	0			91.1	78.8	68.9	51.0														
		20	89.4	75.5	64.4	44.9																
		30	74.1	61.8	41.1																	
		40	58.8	39.6																		
		50	37.1																			
		60																				
Shut-off PSI			58	49	40	32	23	14														
TWI4.70-08	5	0					88.9	84.8	78.5	69.4	59.4	49.7										
		20			87.8	83.2	75.9	66.3	65.4	46.3												
		30	91.0	87.2	82.3	74.6	64.7	54.9	44.4													
		40	86.5	81.3	73.1	63.2	53.4	52.2														
		50	80.2	71.6	61.6	51.9	39.8															
		60	70.1	60.1	50.4																	
Shut-off PSI			94	86	77	68	60	51	42	34	25	16										
TWI4.70-12	7½	0							90.2	87.7	84.8	81.0	75.7	69.4	62.7	56.1	49.7					
		20					89.4	86.9	83.8	79.5	73.9	67.4	60.6	54.2	47.5							
		30				89.0	86.4	83.2	78.7	72.9	66.3	59.6	53.2	46.3								
		40			88.6	86.0	82.6	77.9	71.9	65.3	58.6	52.2	45.0	33.0	11.3							
		50		88.2	85.5	81.9	77.0	70.9	64.2	57.6	51.2	43.7										
		60	87.8	85.1	82.3	76.1	69.9	63.2	56.6	50.2	42.2											
Shut-off PSI			146	137	128	120	111	102	94	85	76	68	59	50	42	33	24					
TWI4.70-16	10	0							88.5	86.4	85.2	84.3	83.2	81.3	78.4	74.5	64.5	54.2	43.8			
		20					90.7	87.7	85.9	84.0	82.7	80.5	77.3	73.1	68.2	62.9	52.7	41.7				
		30				90.7	87.4	85.7	84.7	83.8	82.4	80.1	76.7	72.4	67.4	62.1	56.9	47.0				
		40			89.6	87.1	85.6	84.6	83.6	82.1	79.7	76.1	71.6	66.5	61.2	56.1	51.2					
		50		89.2	86.8	85.4	83.5	81.8	79.2	75.5	70.9	65.7	60.4	55.4	50.5	45.2						
		60	88.7	86.5	85.2	84.3	83.3	81.5	78.7	74.8	70.0	64.9	59.6	54.6	49.7	44.3						
Shut-off PSI			197	188	180	171	162	154	145	136	128	119	110	102	93	84	76	59	41	24		

Wilo-TWI 4.70 weight & dimensional data can be found on page 27



Weights and Dimensions

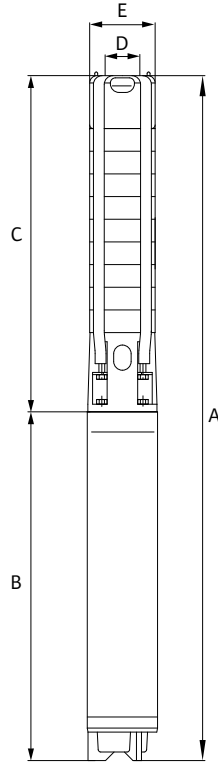

5 GPM										
Motor Type	Model	HP	Dimensions (In)					Weights (Lbs)		
			A	B	C	D	E	Complete Unit	Pump End	Motor
2 Wire	TWI4.05-13.05	½	28.3	11.0	17.3	1 ¼	3.9	28	8	20
	TWI4.05-13.05	½	28.3	11.0	17.3			28	8	20
	TWI4.05-18.07	¾	33.9	12.4	21.5			33	10	23
	TWI4.05-22.10	1	38.1	13.3	24.8			37	12	25
	TWI4.05-26.15	1½	43	14.9	28.1			43	13	30
	TWI4.05-31.15	1½	48	14.9	33.1			50	20	30
3 Wire	TWI4.05-13.05	½	27.3	10.0	17.3	1 ¼	3.9	27	8	19
	TWI4.05-13.05	½	27	9.7	17.3			27	8	19
	TWI4.05-18.07	¾	32.3	10.8	21.5			32	10	22
	TWI4.05-22.10	1	36.5	11.7	24.8			37	12	25
	TWI4.05-26.15	1½	41.7	13.6	28.1			40	13	27
	TWI4.05-26.15	1½	39.8	11.7	28.1			46	13	23
	TWI4.05-26.15	1½	39.8	11.7	28.1			46	13	23
	TWI4.05-31.15	1½	46.7	13.6	33.1			47	20	27
	TWI4.05-31.15	1½	44.8	11.7	33.1			43	20	23
	TWI4.05-31.15	1½	44.8	11.7	33.1			43	20	23

7 GPM										
Motor Type	Model	HP	Dimensions (in)					Weights (lbs)		
			A	B	C	D	E	Complete Unit	Pump End	Motor
2 Wire	TWI4.07-11.05	½	24.7	9.5	15.2	1¼ NPT	3.9	30	10	20
	TWI4.07-11.05	½	24.7	9.5	15.2			30	10	20
	TWI4.07-15.07	¾	29.2	10.7	18.5			33	11	23
	TWI4.07-19.10	1	33.6	11.8	21.8			37	12	25
	TWI4.07-26.15	1½	41.2	13.6	27.6			46	16	30
3 Wire	TWI4.07-11.05	½	24.7	9.5	15.2	1¼ NPT	3.9	30	10	19
	TWI4.07-11.05	½	24.7	9.5	15.2			30	10	19
	TWI4.07-15.07	¾	29.2	10.7	18.5			33	11	22
	TWI4.07-19.10	1	33.6	11.8	21.8			36	12	25
	TWI4.07-26.15	1½	41.2	13.6	27.6			43	16	27
	TWI4.07-26.15	1½	41.2	13.6	27.6			39	16	23
	TWI4.07-26.15	1½	41.2	13.6	27.6			39	16	23
	TWI4.07-32.20	2	48.5	14.0	34.5			55	28	31
	TWI4.07-32.20	2	48.5	14.0	34.5			55	28	27
	TWI4.07-32.20	2	48.5	14.0	34.5			55	28	27

10 GPM											
Motor Type	Model	HP	Dimensions (in)					Weights (lbs)			
			A	B	C	D	E	Complete Unit	Pump End	Motor	
2 Wire	TWI4.10-9.05	½	25	11.0	14.0	1¼ NPT	3.9	27	7	20	
	TWI4.10-9.05	½	25	11.0	14.0			27	7	20	
	TWI4.10-12.07	¾	28.9	12.4	16.5			31	8	23	
	TWI4.10-15.10	1	32.3	13.3	19.0			34	9	25	
	TWI4.10-21.15	1½	38.8	14.9	23.9			42	12	30	
3 Wire	TWI4.10-9.05	½	24	10.0	14.0	1¼ NPT	3.9	26	7	19	
	TWI4.10-9.05	½	23.7	9.7	14.0			26	7	19	
	TWI4.10-12.07	¾	27.3	10.8	16.5			30	8	22	
	TWI4.10-15.10	1	30.7	11.7	19.0			34	9	25	
	TWI4.10-21.15	1½	37.5	13.6	23.9			39	12	27	
	TWI4.10-21.15	1½	35.6	11.7	23.9			35	12	23	
	TWI4.10-21.15	1½	35.6	11.7	23.9			35	12	23	
	TWI4.10-27.20	2	44	15.1	28.9			45	14	31	
	TWI4.10-27.20	2	42.7	13.8	28.9			41	14	27	
	TWI4.10-27.20	2	42.7	13.8	28.9			41	14	27	
	TWI4.10-34.30	3	53.9	18.3	35.6			62	22	40	
	TWI4.10-34.30	3	50.9	15.3	35.6			54	22	32	
	TWI4.10-34.30	3	50.9	15.3	35.6			54	22	32	
	TWI4.10-48.50	5	71.3	23.6	47.7			4.6	108	38	70
	TWI4.10-48.50	5	71.3	23.6	47.7				93	38	55
	TWI4.10-48.50	5	71.3	23.6	47.7				93	38	55
TWI4.10-58.50	5	88.2	23.6	64.5	112	42	70				
TWI4.10-58.50	5	88.2	23.6	64.5	97	42	55				
TWI4.10-58.50	5	88.2	23.6	64.5	97	42	55				

Weights and Dimensions

18 GPM										
Motor Type	Model	HP	Dimensions (in)					Weights (lbs)		
			A	B	C	D	E	Complete Unit	Pump End	Motor
2 Wire	TWI4.18-5.05	½	21.7	11.0	10.7	1¼ NPT	3.9	25	5	20
	TWI4.18-5.05	½	21.7	11.0	10.7			25	5	20
	TWI4.18-7.07	¾	24.8	12.4	12.4			29	6	23
	TWI4.18-9.10	1	27.3	13.3	14.0			32	7	25
	TWI4.18-13.15	1½	32.2	14.9	17.3			39	9	30
3 Wire	TWI4.18-5.05	½	20.7	10.0	10.7	1¼ NPT	3.9	24	5	19
	TWI4.18-5.05	½	20.4	9.7	10.7			24	5	19
	TWI4.18-7.07	¾	23.2	10.8	12.4			28	6	22
	TWI4.18-9.10	1	25.7	11.7	14.0			32	7	25
	TWI4.18-13.15	1½	30.9	13.6	17.3			36	9	27
	TWI4.18-13.15	1½	29	11.7	17.3			32	9	23
	TWI4.18-13.15	1½	29	11.7	17.3			32	9	23
	TWI4.18-17.20	2	35.7	15.1	20.6			41	10	31
	TWI4.18-17.20	2	34.4	13.8	20.6			37	10	27
	TWI4.18-17.20	2	34.4	13.8	20.6			37	10	27
	TWI4.18-23.30	3	43.9	18.3	25.6			53	13	40
	TWI4.18-23.30	3	40.9	15.3	25.6			45	13	32
	TWI4.18-23.30	3	40.9	15.3	25.6			45	13	32
	TWI4.18-36.50	5	64.9	27.7	37.2		93	23	70	
	TWI4.18-36.50	5	58.9	21.7	37.2		78	23	55	
	TWI4.18-36.50	5	58.9	21.7	37.2		78	23	55	
	TWI4.18-56.75	7½	93	24.2	68.8		4.6		45	70
	TWI4.18-56.75	7½	93	24.2	68.8				45	95
	TWI4.18-75.100	10	109.9	25.4	84.5				60	95

25 GPM

Motor Type	Model	HP	Dimensions (in)					Weights (lbs)		
			A	B	C	D	E	Complete Unit	Pump End	Motor
2 Wire	TWI4.25-4.05	½	20.9	11.0	9.9	1½ NPT	3.9	25	5	20
	TWI4.25-4.05	½	20.9	11.0	9.9			25	5	20
	TWI4.25-5.07	¾	23.1	12.4	10.7			29	5	23
	TWI4.25-7.10	1	25.7	13.3	12.4			32	6	25
	TWI4.25-9.15	1½	28.9	14.9	14.0			39	7	30
3 Wire	TWI4.25-4.05	½	19.9	10.0	9.9	1½ NPT	3.9	24	5	19
	TWI4.25-4.05	½	19.6	9.7	9.9			24	5	19
	TWI4.25-5.07	¾	21.5	10.8	10.7			28	5	22
	TWI4.25-7.10	1	24.1	11.7	12.4			32	6	25
	TWI4.25-9.15	1½	27.6	13.6	14.0			36	7	27
	TWI4.25-9.15	1½	25.7	11.7	14.0			32	7	23
	TWI4.25-9.15	1½	25.7	11.7	14.0			32	7	23
	TWI4.25-11.20	2	30.7	15.1	15.6			41	8	31
	TWI4.25-11.20	2	29.4	13.8	15.6			37	8	27
	TWI4.25-11.20	2	29.4	13.8	15.6			37	8	27
	TWI4.25-15.30	3	37.3	18.3	19.0			53	9	40
	TWI4.25-15.30	3	34.3	15.3	19.0			45	9	32
	TWI4.25-15.30	3	34.3	15.3	19.0			45	9	32
	TWI4.25-26.50	5	56	27.7	28.3			84	14	70
	TWI4.25-26.50	5	50	21.7	28.3			69	14	55
	TWI4.25-26.50	5	50	21.7	28.3			69	14	55
	TWI4.25-39.75	7½	66.8	27.7	39.1			4.6	95	25
	TWI4.25-39.75	7½	66.8	27.7	39.1		95		25	70
	TWI4.25-52.100	10	90.9	25.4	65.5		5.4	142	47	95

Weights and Dimensions

40 GPM										
Motor Type	Model	HP	Dimensions (in)					Weights (lbs)		
			A	B	C	D	E	Complete Unit	Pump End	Motor
2 Wire	TWI4.40-4.10	1	27.9	13.3	14.6	2 NPT	3.9	33	8	25
	TWI4.40-5.15	1½	31.1	14.9	16.2			39	9	30
3 Wire	TWI4.40-4.10	1	26.3	11.7	14.6	2 NPT	3.9	33	8	25
	TWI4.40-5.15	1½	29.8	13.6	16.2			36	9	27
	TWI4.40-5.15	1½	27.9	11.7	16.2			32	9	23
	TWI4.40-5.15	1½	27.9	11.7	16.2			32	9	23
	TWI4.40-7.20	2	34.6	15.1	19.5			43	12	31
	TWI4.40-7.20	2	33.3	13.8	19.5			39	12	27
	TWI4.40-7.20	2	33.3	13.8	19.5			39	12	27
	TWI4.40-9.30	3	41.1	18.3	22.8			54	14	40
	TWI4.40-9.30	3	38.1	15.3	22.8			46	14	32
	TWI4.40-9.30	3	38.1	15.3	22.8			46	14	32
	TWI4.40-15.50	5	60.5	27.7	32.8			91	21	70
	TWI4.40-15.50	5	54.5	21.7	32.8			76	21	55
	TWI4.40-15.50	5	54.5	21.7	32.8			76	21	55
	TWI4.40-25.75	7½	77.0	27.7	49.3			102	32	70
	TWI4.40-25.75	7½	77.0	27.7	49.3			102	32	70
	TWI4.40-30.100	10	95.8	38.3	57.5			150	37	113
TWI4.40-44.150	15	111	28	83	5.4	142	57	85		
TWI4.40-66.200	20	162.4	30.6	131.8		169	73	96		

70 GPM

Motor Type	Model	HP	Dimensions (In)					Weights (Lbs)		
			A	B	C	D	E	Complete Unit	Pump End	Motor
3 Wire	TWI4.70-3.20	2	29.9	15.1	14.8	2	3.9	39	8	31
	TWI4.70-3.20	2	28.6	13.8	14.8			35	8	27
	TWI4.70-3.20	2	28.6	13.8	14.8			35	8	27
	TWI4.70-5.30	3	38.2	18.3	19.9			52	12	40
	TWI4.70-5.30	3	35.2	15.3	19.9			44	12	32
	TWI4.70-5.30	3	35.2	15.3	19.9			44	12	32
	TWI4.70-8.50	5	55.3	27.7	27.6			86	16	70
	TWI4.70-8.50	5	49.3	21.7	27.6			71	16	55
	TWI4.70-8.50	5	49.3	21.7	27.6			71	16	55
	TWI4.70-12.75	7½	65.5	27.7	37.8			91	21	70
	TWI4.70-12.75	7½	65.5	27.7	37.8			91	21	70
	TWI4.70-16.100	10	86.3	38.3	48.0			140	27	113



Wilo-TWI, SPI, TWU

All NSF Certified



General Material Data

TWU 4"

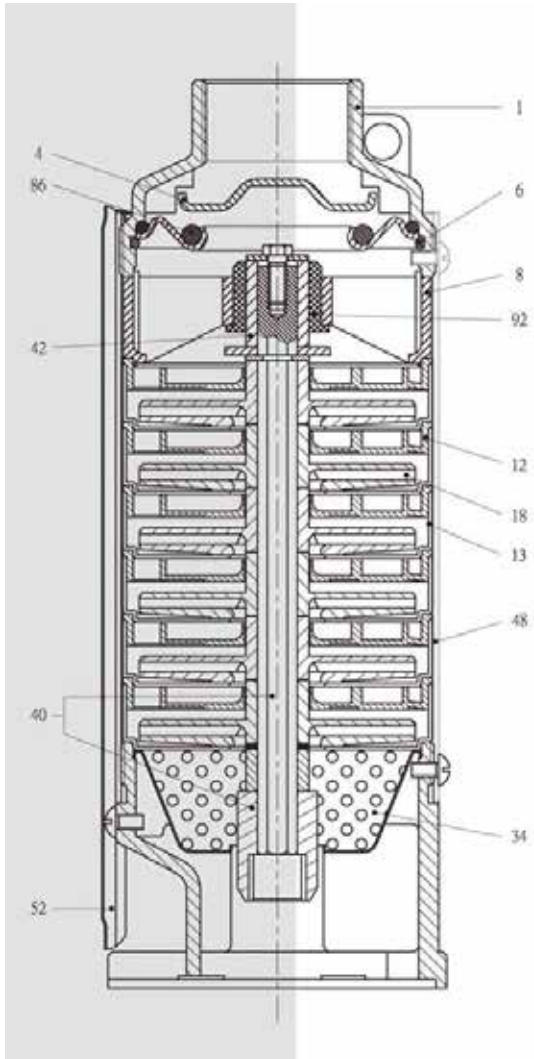

Pos.	Components	Material	Standard
01	Discharge Head	Stainless Steel	304
04	Check Valve Cone	Stainless Steel	304
06	Check Valve retaining Ring	Stainless Steel	304
08	Bearing Spider	Glass Filled Poly-carbonate	
12	Diffuser	Glass Filled Poly-carbonate	
13	Bowl	Stainless Steel	304
18	Impeller	Noryl	
34	Strainer	Stainless Steel	304
40	Pump Shaft / Coupling	Stainless Steel	304
42	Shaft Sleeve	Stainless Steel or Noryl	304
48	Pump Casing	Stainless Steel	304
52	Cable Guard	Stainless Steel	304
86	O-Ring	NBR	
92	Bearing	Polyacetal	

Wilco-TWU 4.05

Submersible Well Pumps with Noryl Impeller



5 GPM

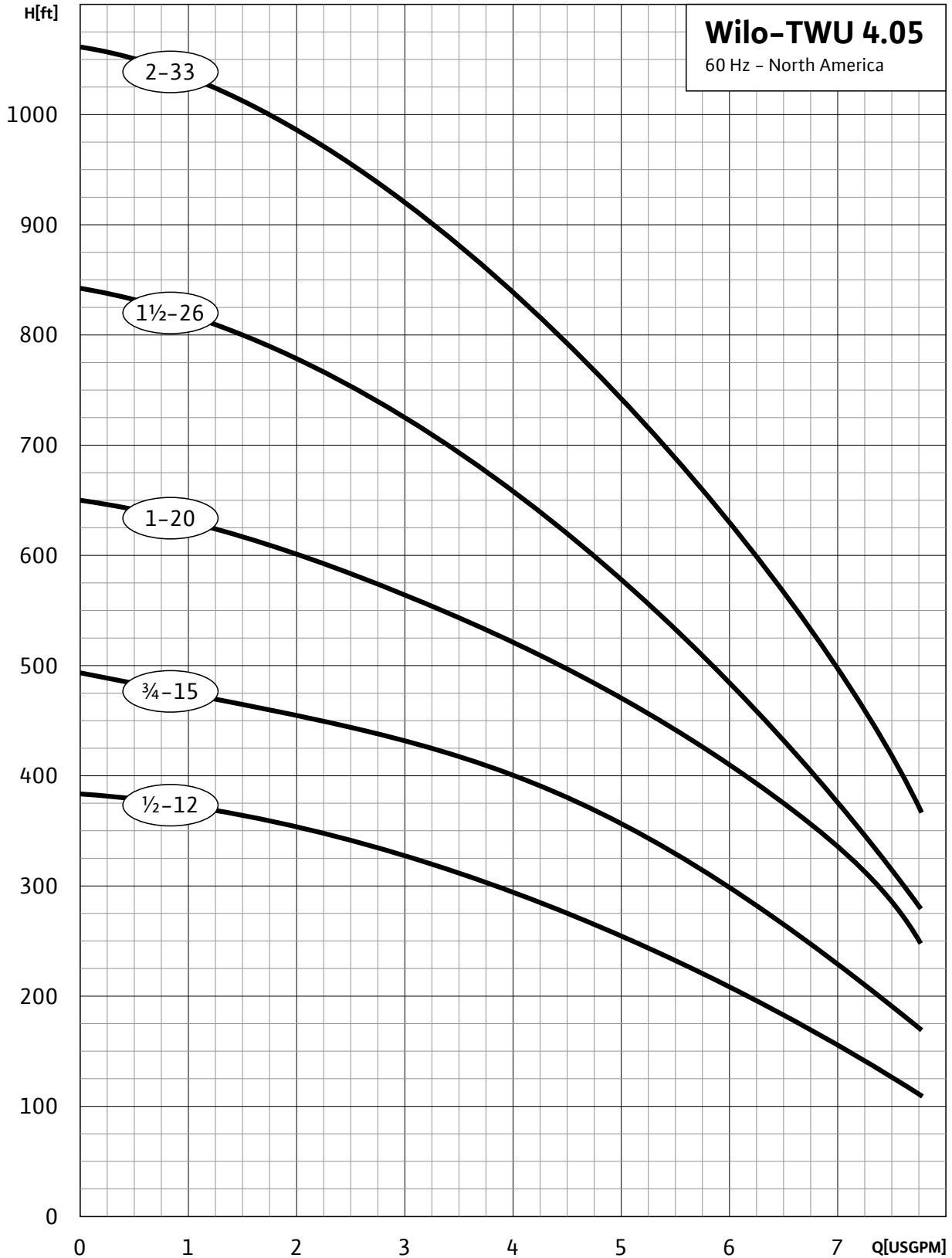

MODEL	HP	PSI	Depth to Water in Feet																																															
			20	40	60	80	100	120	140	160	180	200	220	240	260	280	300	340	380	420	460	500	540	580	620	660	700	740	780	820	860	900	940	980	1020															
TWU4.05-12.05	½	0							7.7	7.3	6.9	6.4	6.0	5.6	5.1	4.7	4.1	2.6																																
		20						7.5	7.1	6.7	6.3	5.9	5.4	5.0	4.5	3.9	3.2	2.3																																
		30				7.5	7.1	6.7	6.2	5.8	5.4	4.9	4.4	3.8	3.1	2.1																																		
		40			7.4	7.0	6.6	6.2	5.7	5.3	4.9	4.3	3.7	2.9	1.9																																			
		50	7.7	7.4	6.9	6.5	6.1	5.7	5.2	4.8	4.2	3.6	2.8	1.8																																				
60	7.3	6.9	6.5	6.0	5.6	5.2	4.7	4.2	3.5	2.6	1.6																																							
Shut-off PSI			156	147	138	130	121	112	104	95	86	78	69	60	52	43	34	17																																
TWU4.05-15.07	¾	0											7.6	7.3	7.0	6.6	6.3	5.9	5.2	4.4	3.3	1.6																												
		20							7.5	7.2	6.9	6.5	6.2	5.8	5.5	5.1	4.2	3.1	1.3																															
		30							7.5	7.2	6.8	6.5	6.1	5.8	5.4	5.0	4.6	3.6	2.1																															
		40					7.4	7.1	6.8	6.4	6.1	5.7	5.4	5.0	4.6	4.1	2.8																																	
		50				7.4	7.1	6.7	6.4	6.0	5.7	5.3	4.9	4.5	4.0	3.4	1.8																																	
60			7.6	7.3	7.0	6.7	6.3	6.0	5.6	5.3	4.9	4.4	3.9	3.3	2.6																																			
Shut-off PSI			184	175	167	158	149	141	132	123	115	106	97	89	80	63	45	28	11																															
TWU4.05-20.10	1	0															7.5	7.0	6.5	5.9	5.3	4.6	3.8	2.8	1.6																									
		20											7.6	7.4	7.2	7.0	6.4	5.9	5.2	4.5	3.7	2.6																												
		30										7.6	7.4	7.2	6.9	6.7	6.1	5.5	4.8	4.0	3.1	1.9																												
		40									7.6	7.4	7.1	6.9	6.6	6.3	5.8	5.1	4.4	3.5	2.5																													
		50							7.5	7.3	7.1	6.8	6.6	6.3	6.0	5.4	4.7	3.9	2.9	1.7																														
60							7.5	7.3	7.1	6.8	6.5	6.3	6.0	5.7	5.0	4.3	3.4	2.3																																
Shut-off PSI									214	206	197	188	180	171	162	154	136	119	102	84	67	50	32	15																										
TWU4.05-26.15	1½	0															7.5	7.2	6.8	6.3	5.9	5.5	5.1	4.6	4.1	3.5	2.8	1.8																						
		20															7.6	7.5	7.1	6.7	6.3	5.8	5.4	5.0	4.5	4.0	3.4	2.6	1.6																					
		30															7.6	7.5	7.3	6.9	6.5	6.0	5.6	5.2	4.7	4.2	3.7	3.0	2.1																					
		40															7.6	7.4	7.3	7.1	6.6	6.2	5.8	5.3	4.9	4.5	3.9	3.3	2.5	1.4																				
		50												7.6	7.4	7.2	7.0	6.8	6.4	6.0	5.5	5.1	4.7	4.2	3.6	2.9	1.9																							
60										7.6	7.4	7.2	7.0	6.8	6.6	6.1	5.7	5.3	4.8	4.4	3.8	3.2	2.4																											
Shut-off PSI													274	265	257	248	239	231	213	196	179	162	144	127	110	92	75	58	40	23																				
TWU4.05-33.20	2	0																7.4	7.1	6.8	6.4	6.1	5.7	5.4	5.0	4.7	4.3	3.9	3.3	2.7																				
		20																7.4	7.1	6.7	6.4	6.0	5.7	5.3	5.0	4.6	4.2	3.8	3.3	2.6	1.9																			
		30																7.5	7.2	6.9	6.5	6.2	5.8	5.5	5.1	4.8	4.4	4.0	3.5	2.9	2.2																			
		40																7.3	7.0	6.7	6.3	6.0	5.6	5.3	4.9	4.6	4.2	3.7	3.2	2.5	1.7																			
		50																7.5	7.2	6.8	6.5	6.1	5.8	5.4	5.1	4.7	4.3	3.9	3.4	2.8	2.1																			
60																7.6	7.3	7.0	6.6	6.3	5.9	5.6	5.2	4.9	4.5	4.1	3.6	3.1	2.4	1.6																				
Shut-off PSI																					328	311	293	276	259	242	224	207	190	172	155	138	120	103	86	68	51													

Wilo-TWU 4.05 weight & dimensional data can be found on page 48



Wilо-TWU 4.07

Submersible Well Pumps with Noryl Impeller



7 GPM

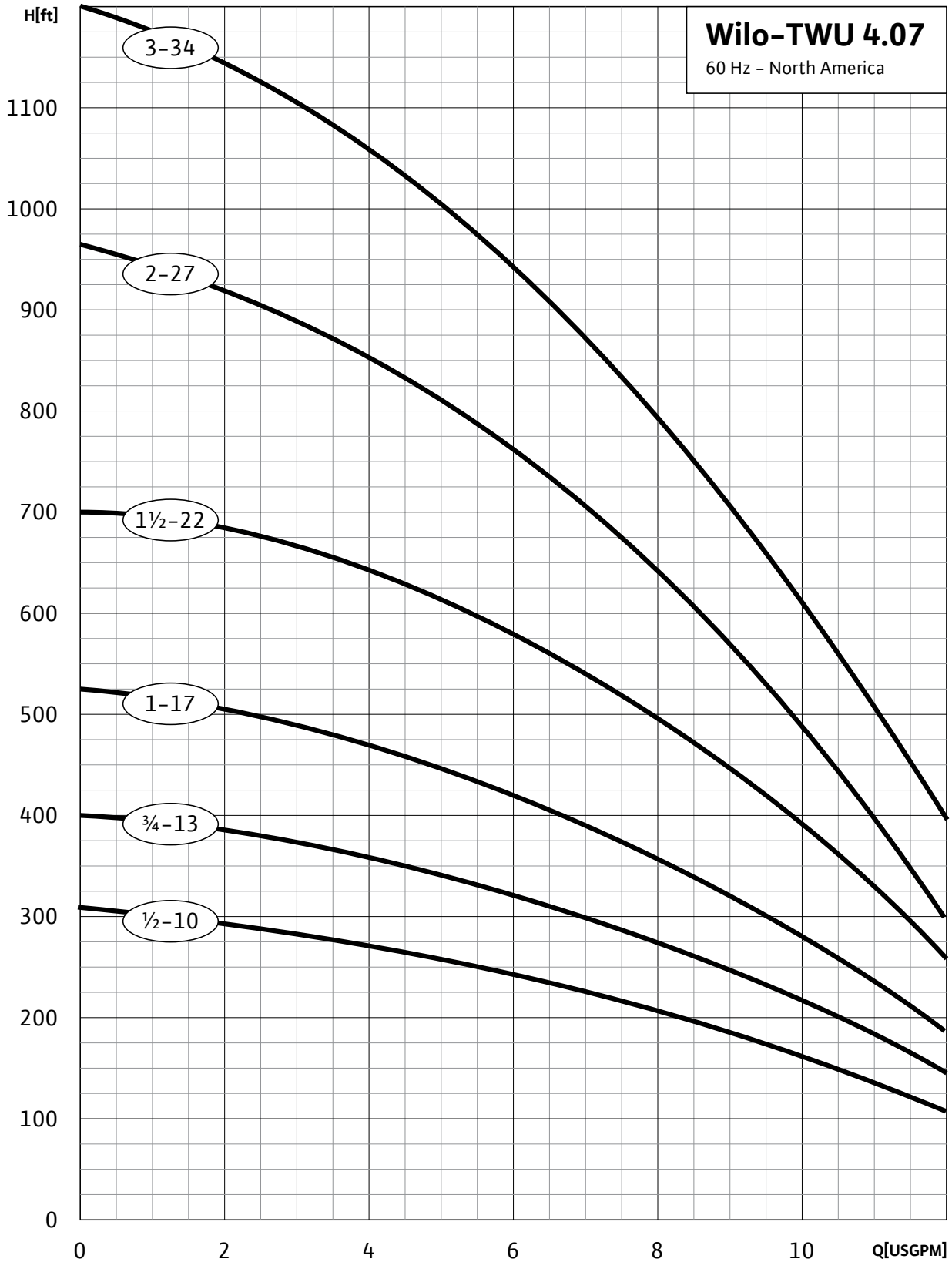

MODEL	HP	PSI	Depth to Water in Feet																																		
			20	40	60	80	100	120	140	160	180	200	220	240	260	280	300	320	340	360	380	400	420	440	460	480	500	540	580	620							
TWU4.07-10.05	½	0									10.1	9.2	8.3	7.4	6.3	5.0	3.4																				
		20					9.8	9.0	8.1	7.1	6.0	4.6	2.7																								
		30					9.7	8.8	7.9	6.9	5.8	4.3	2.4																								
		40			10.4	9.6	8.7	7.8	6.7	5.6	4.1	2.0																									
		50		10.3	9.4	8.5	7.6	6.6	5.4	3.8	1.7																										
		60	10.2	9.3	8.4	7.5	6.4	5.1	3.5																												
Shut-off PSI			125	116	107	99	90	81	73	64	55	47	38	29	21	12																					
TWU4.07-13.07	¾	0											10.0	9.3	8.6	7.9	7.1	6.2	5.2	4.0	2.4																
		20								10.4	9.8	9.1	8.4	7.7	6.9	6.0	4.9	3.5	1.8																		
		30							10.3	9.7	9.0	8.3	7.5	6.7	5.8	4.7	3.3	1.5																			
		40					10.2	9.5	8.9	8.2	7.4	6.6	5.6	4.5	3.1																						
		50				10.1	9.4	8.8	8.1	7.3	6.5	5.5	4.3	2.8																							
		60			10.0	9.3	8.7	7.9	7.2	6.3	5.3	4.1	2.5																								
Shut-off PSI					140	131	122	114	105	96	88	79	70	62	53	44	36	27	18	10																	
TWU4.07-17.10	1	0																		10.1	9.6	9.0	8.5	7.9	7.3	6.7	6.0	5.3	4.4	3.4	2.1						
		20											10.4	9.9	9.4	8.9	8.3	7.7	7.1	6.5	5.8	5.0	4.1	3.0	1.6												
		30											10.3	9.9	9.3	8.8	8.2	7.6	7.0	6.4	5.7	4.9	4.0	2.8													
		40										10.3	9.8	9.2	8.7	8.1	7.5	6.9	6.3	5.6	4.8	3.8	2.6														
		50						10.2	9.7	9.2	8.6	8.0	7.4	6.8	6.2	5.4	4.6	3.7	2.4																		
		60					10.1	9.6	9.1	8.5	7.9	7.3	6.7	6.0	5.3	4.5	3.5	2.2																			
Shut-off PSI									166	158	149	140	132	123	114	106	97	88	80	71	62	54	45	36	28	19	10										

MODEL	HP	PSI	Depth to Water in Feet																																			
			200	220	240	260	280	300	340	380	420	460	500	540	580	620	660	700	740	780	820	860	900	940	980	1020	1060	1100	1140									
TWU4.07-22.15	1½	0									10.2	9.3	8.5	7.6	6.8	5.9	4.7	2.6																				
		20								10.1	9.2	8.3	7.5	6.7	5.8	4.5	2.1																					
		30						10.4	9.6	8.7	7.8	7.0	6.2	5.1	3.3																							
		40				10.3	9.9	9.1	8.2	7.4	6.6	5.6	4.2	1.6																								
		50			10.3	9.9	9.4	8.6	7.7	6.9	6.0	4.9	2.9																									
		60		10.2	9.8	9.4	8.9	8.1	7.2	6.4	5.4	3.9																										
Shut-off PSI					194	186	177	168	151	134	116	99	82	64	47	30	12																					
TWU4.07-27.20	2	0												9.8	9.3	8.7	8.4	7.8	7.1	6.3	5.4	4.5	3.5	2.2														
		20												9.8	9.3	8.7	8.4	7.7	6.9	6.2	5.3	4.3	3.2	2.8														
		30											9.9	9.5	9.0	8.5	7.9	7.2	6.4	5.7	4.4	3.7																
		40									10.0	9.7	9.2	8.7	8.3	7.5	6.7	6.0	5.2	4.1	3.0																	
		50									9.9	9.4	8.9	8.5	7.8	7.2	6.3	5.5	4.7	3.5																		
		60						10.0	9.6	9.1	8.7	8.2	7.4	6.6	5.8	5.0	4.0																					
Shut-off PSI									268	251	234	216	199	182	165	147	130	113	95	80	61	43	26															
TWU4.07-34.30	3	0														9.8	9.5	9.2	8.7	8.3	7.9	7.4	6.8	6.2	5.4	4.7	3.9	3.0	2.0									
		20														9.8	9.4	9.2	8.7	8.3	7.8	7.2	6.7	6.2	5.3	4.5	3.7	3.3	1.7									
		30														10.0	9.6	9.2	8.8	8.5	8.0	7.5	6.9	6.3	5.7	4.8	4.1	3.2	2.3									
		40														10.0	9.7	9.4	9.0	8.6	8.2	7.7	7.2	6.6	5.9	5.2	4.4	3.6	2.7	1.7								
		50														9.9	9.5	9.2	8.7	8.4	7.9	7.4	6.8	6.3	5.5	4.8	3.9	3.1	2.2									
		60														10.0	9.7	9.3	9.0	8.6	8.1	7.6	7.0	6.5	5.8	5.1	4.2	3.4	2.5	1.5								
Shut-off PSI															320	303	286	268	251	234	216	199	182	165	147	130	113	95	78	61	43	27						

Wilco-TWU 4.07 weight & dimensional data can be found on page 49

Wilо-TWU 4.10

Submersible Well Pumps with Noryl Impeller



10 GPM

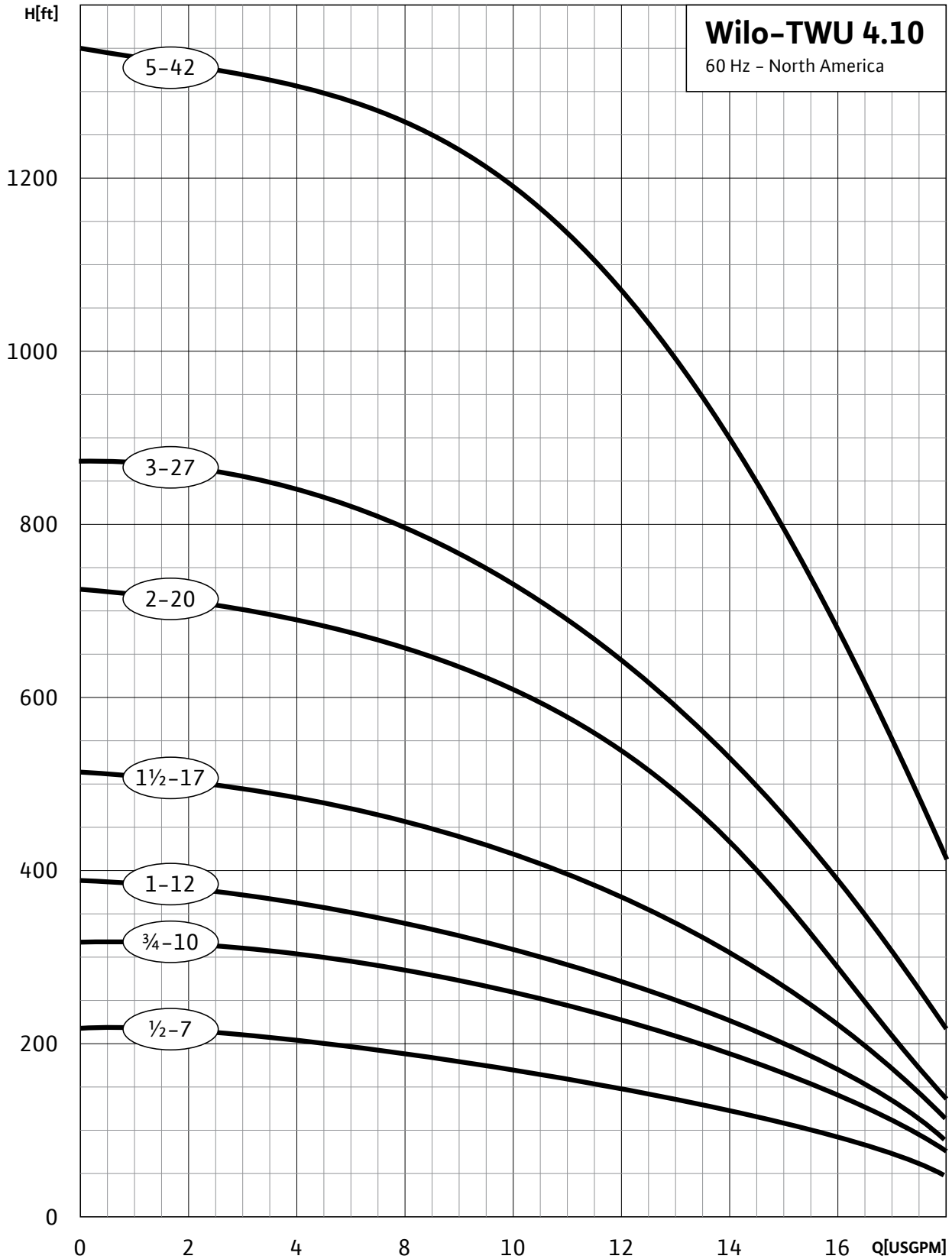

MODEL	HP	PSI	Depth to Water in Feet																												
			20	40	60	80	100	120	140	160	180	200	220	240	260	280	300	340	380	420	460	500	540	580	620	660	700	740	780	820	
TWU4.10-07.05	½	0				16.0	15.3	14.3	12.8	11.3	9.0	6.4																			
		20		15.9	14.9	13.8	12.5	10.8	8.3	4.8																					
		30	15.7	14.6	13.5	12.3	10.5	7.8	4.0																						
		40	14.5	13.4	12.0	10.3	7.5	3.0																							
		50	13.0	11.5	9.8	7.2																									
		60	11.3	9.0	6.4																										
Shut-off PSI			89	81	72	63	55	46	37	29	20	11																			
TWU4.10-10.07	¾	0					16.0	15.2	14.3	13.4	12.5	11.5	10.3	9.0	7.0	4.0															
		20				15.8	15.0	14.0	13.0	12.3	11.2	10.2	8.5	6.0																	
		30			15.7	14.8	13.9	12.8	12.0	11.0	9.8	8.2	5.5																		
		40		15.6	14.7	13.8	12.7	11.9	10.8	9.7	8.1	5.2																			
		50	15.3	14.4	13.5	12.6	11.6	10.5	9.4	7.5	4.8																				
		60	14.3	13.4	12.5	11.5	10.3	9.0	7.0	4.0																					
Shut-off PSI			130	121	113	104	95	87	78	69	61	52	43	35	26	17	9														
TWU4.10-12.10	1	0								15.8	15.2	14.5	13.7	12.8	12.0	11.0	10.0	6.7													
		20						15.7	14.9	14.3	13.5	12.7	11.7	10.6	9.6	8.1	6.5														
		30					16.0	15.6	14.8	14.2	13.3	12.5	11.6	10.4	9.4	7.8	5.5	3.0													
		40				16.0	15.5	14.7	14.1	13.2	12.4	11.5	10.3	9.1	7.4	5.0	3.0														
		50			15.3	14.6	13.9	13.0	12.3	11.3	10.1	8.9	7.0	4.3																	
		60	15.8	15.2	14.5	13.7	12.8	12.0	11.0	10.0	8.6	6.7	4.0																		
Shut-off PSI			158	150	141	132	124	115	106	98	89	81	72	63	55	46	37	20													
TWU4.10-17.15	1½	0											15.7	15.3	14.8	14.4	13.3	12.2	10.9	9.3	7.1	3.0									
		20										16.0	15.6	15.2	14.7	14.3	13.7	13.2	11.9	10.6	9.0	6.5									
		30									15.9	15.5	15.2	14.6	14.2	13.5	13.1	12.6	11.3	9.7	7.6	4.0									
		40							15.8	15.5	15.1	14.6	14.2	13.5	13.0	12.5	11.8	10.3	8.8	6.0											
		50					15.7	15.4	14.9	14.5	14.0	13.4	12.8	12.3	11.7	11.0	9.4	7.4	3.4												
		60				15.7	15.3	14.8	14.4	13.9	13.3	12.8	12.2	11.6	10.9	10.1	8.1	5.6													
Shut-off PSI						197	188	180	171	162	154	144	136	128	119	110	93	76	58	41	24	6									
TWU4.10-20.20	2	0													16.0	15.7	14.9	14.2	13.4	12.4	11.4										
		20												15.9	15.5	15.3	14.8	14.1	13.2	12.2	11.0	9.9									
		30											15.8	15.4	15.1	14.7	10.1	13.5	12.7	11.7	10.3	8.8									
		40										15.8	15.4	15.1	14.7	14.4	14.0	12.9	12.2	10.9	9.5	7.8									
		50								16.1	15.7	15.3	15.0	14.6	14.2	14.0	13.4	12.5	11.5	10.1	8.5	6.0									
		60					16.0	15.7	15.3	14.9	14.5	14.2	13.8	13.4	12.8	11.8	10.7	9.1	7.2	3.4											
Shut-off PSI						225	216	208	199	190	182	173	164	156	139	121	104	87	69												
TWU4.10-27.30	3	0															15.8	15.2	14.6	14.0											
		20															15.7	15.1	14.5	13.9	13.2										
		30															15.9	15.4	14.8	14.2	13.4	12.8									
		40														15.9	15.6	15.0	14.4	13.8	13.1	12.4									
		50												16.0	15.8	15.6	15.3	14.7	14.1	13.3	12.7	11.9									
		60											16.0	15.8	15.5	15.2	14.8	14.3	13.7	12.9	12.3	11.4									
Shut-off PSI												284	275	267	258	249	232	215	197	180	163										
			440	480	520	560	600	640	680	720	760	800	840	880	920	960	1000	1040	1080	1120	1160	1200									
TWU4.10-42.50	5	0					16	15.5	15.2	14.9	14.5	14	13.5	13	12.5	12	11.5	10.8	10.2	9.5	8.5										
		20					15.9	15.4	15.1	14.8	14.5	13.9	13.4	12.9	12.4	11.9	11.3	10.7	10.1	9.4	8.2	6.8									
		30					15.6	15.2	14.9	14.6	14.2	13.7	13.1	12.6	12.1	11.6	11.0	10.4	9.8	8.8	7.5	6.0									
		40				15.8	15.3	15.1	14.7	14.4	13.8	13.3	12.8	12.3	11.8	11.2	10.6	10.0	9.2	7.9	6.6	4.1									
		50				15.5	15.2	14.9	14.6	14.1	13.6	13.0	12.5	12.1	11.5	10.9	10.3	9.7	8.6	7.3	5.6										
		60			15.7	15.3	15.0	14.7	14.3	13.7	13.2	12.7	12.2	11.7	11.1	10.5	9.9	9.0	7.7	6.5	3.2										
Shut-off PSI					346	329	312	294	277	260	242	225	208	191	173	156	139	121	104	87	69	52									

Wilo-TWU 4.10 weight & dimensional data can be found on page 50



Wilо-TWU 4.13

Submersible Well Pumps with Noryl Impeller



13 GPM

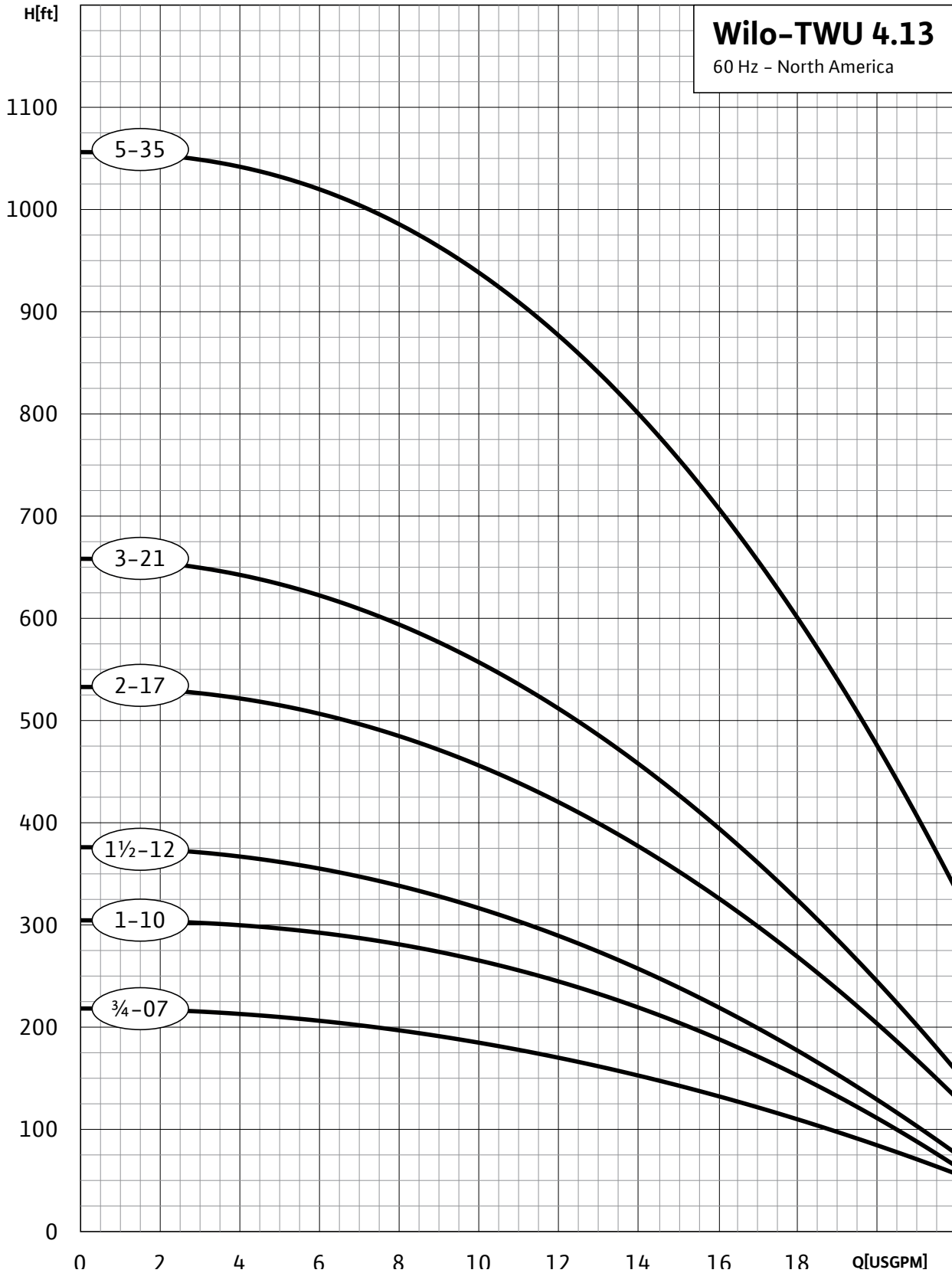

MODEL	HP	PSI	Depth to Water in Feet																						
			20	40	60	80	100	120	140	160	180	200	240	260	280	300	340	380	420	460	500	540	580	620	660
TWU4.13-07.75	¾	0				17.7	16.5	15.0	13.0	11.2	9.5	6.5													
		20		17.4	16.0	14.4	12.8	10.9	8.5	4.0															
		30	16.9	15.5	14.0	12.6	10.5	8.0	3.0																
		40	15.4	13.9	12.4	10.4	7.7	2.0																	
		50	13.4	11.8	10.0	7.5																			
		60	11.2	9.5	6.5																				
Shut-off PSI			86	78	69	61	52	43	35	26	17	8													
TWU4.13-10.10	1	0						17.6	16.4	15.6	14.6	13.4	12.1	10.8	9.4	7.5	4.0								
		20			18.0	17.4	16.5	15.2	14.3	13.0	11.8	10.5	9.0	6.5	2.0										
		30		18.0	17.2	16.2	15.1	13.8	12.7	11.6	10.2	8.5	5.5												
		40	17.9	17.0	16.0	15.0	13.7	12.6	11.5	10.0	8.1	5.3													
		50	16.8	15.8	14.8	13.5	12.5	11.0	9.6	7.9	5.0														
		60	15.6	14.6	13.4	12.1	10.8	9.4	7.5	4.0															
Shut-off PSI			128	119	110	102	93	84	76	67	58	50	41	32	24	15	6								
TWU4.13-12.15	1½	0							21.7	20.9	20.2	19.3	18.3	17.2	16.2	15.2	14.1	10.7							
		20					21.5	20.4	19.9	19.0	18.0	17.1	16.1	14.9	13.8	12.2	10.8								
		30			22.2	21.4	20.6	19.6	18.8	17.8	16.9	16.0	14.6	13.5	11.9	9.9	6.0								
		40	22.0	21.3	20.5	19.5	18.6	17.7	16.8	15.9	14.5	13.4	11.5	9.3	6.0										
		50	22.0	21.1	20.3	19.4	18.4	17.5	16.5	15.6	14.3	13.0	11.2	8.3											
		60	20.9	20.2	19.3	18.3	17.2	15.3	14.1	13.0	10.7	7.6													
Shut-off PSI			156	147	139	130	121	113	104	95	87	78	69	61	52	43	35	17							
TWU4.13-17.20	2	0										21.0	20.5	20.0	19.3	18.9	18.2	16.8	15.4	13.6	11.5	8.7			
		20								20.8	20.4	19.8	19.2	18.6	18.0	17.3	16.6	15.1	13.4	11.2	7.8				
		30							20.7	20.3	19.7	19.2	18.4	17.8	17.2	16.5	15.8	14.1	12.1	9.8					
		40					20.6	20.2	19.6	19.1	18.3	17.7	17.1	16.4	15.7	14.8	13.0	10.8	7.0						
		50			21.1	20.5	20.1	19.4	19.0	18.2	17.6	17.0	16.2	15.6	14.7	13.9	11.8	9.5							
		60		21.0	20.5	19.3	18.9	18.2	17.5	16.8	16.1	15.4	14.6	13.6	12.5	10.2	6.0								
Shut-off PSI				206	198	180	172	163	155	146	137	129	120	111	103	85	68	51	33	16					
TWU4.13-21.30	3	0											21.8	21.4	20.9	20.0	19.1	18.0	16.6	15.5	13.9	12.0	9.3		
		20									21.6	21.2	20.9	20.3	19.9	19.0	17.9	16.7	15.3	13.8	11.7	8.9			
		30							22.0	21.5	21.1	20.7	20.2	19.8	19.3	18.8	17.6	16.5	15.0	13.4	11.5	8.0			
		40						22.0	21.4	21.1	20.7	20.2	19.8	19.3	18.8	17.6	16.5	15.0	13.4	11.5	8.0				
		50					21.9	21.5	21.0	20.6	20.1	19.7	19.2	18.7	18.1	16.9	15.7	14.0	12.1	9.9					
		60				21.8	21.4	20.9	20.5	20.0	19.5	19.1	18.6	18.0	17.4	16.2	14.9	13.0	11.0	7.0					
Shut-off PSI					235	226	217	209	200	191	183	174	165	157	139	122	104	87	70	53	35	18			

MODEL	HP	PSI	Depth to Water in Feet																							
			200	240	260	300	340	380	420	460	480	520	560	600	700	800	900									
TWU4.13-35.50	5	0											23.0	22.0	21.0	20.5	19.7	19.5	19.0	18.7	18.0	16.2	14.5	12.2		
		20												21.5	21.0	20.5	20.0	19.4	19.1	18.5	18.0	17.3	15.5	13.6	11.0	
		30												21.8	20.9	20.3	20.0	19.5	18.9	18.6	18.1	17.5	17.0	15.2	13.0	10.0
		40											21.5	21.3	20.7	20.3	19.8	19.5	18.8	18.5	17.9	17.1	16.6	14.7	12.7	9.2
		50											21.3	21.0	20.5	20.0	19.5	19.0	18.4	18.4	17.5	16.8	16.2	14.2	11.9	8.5
		60										21.2	20.9	20.6	20.2	19.2	19.2	18.7	18.0	17.7	17.0	16.4	15.8	13.7	11.2	6.5
Shut-off PSI												381	363	354	337	320	303	285	268	260	242	225	208	165	121	78

Wilo-TWU 4.13 weight & dimensional data can be found on page 51



Wilco-TWU 4.18

Submersible Well Pumps with Noryl Impeller



18 GPM

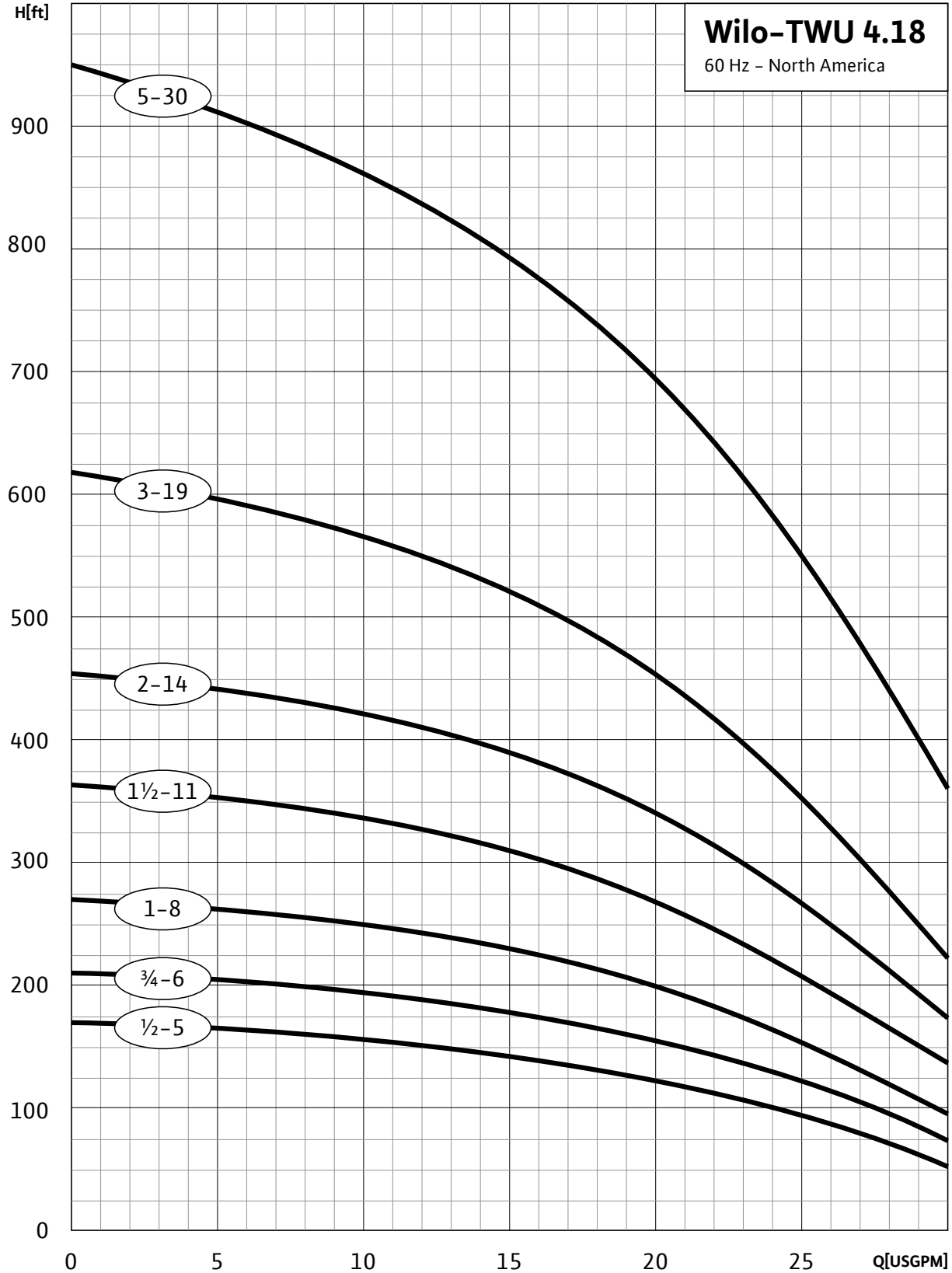

MODEL	HP	PSI	Depth to Water in Feet																														
			20	40	60	80	100	120	140	160	180	200	220	240	260	280	300	340	380	420	460	500	540	580	620	660	700	740	780	820	860		
TWU 4.18-05.05	½	0	29.3	26.6	24.5	21.3	12.0																										
		20	23.9	20.7	16.3	9.4																											
		30	16.1	15.6	6.0																												
		40	14.8	6.2																													
		50	5.4																														
		60																															
TWU 4.18-06.07	¾	0	28.6	26.3	24.9	22.2	19.2	14.3	10.5																								
		20	26.6	24.4	21.4	18.1	14.3	8																									
		30	23.1	21.2	17.7	13	5.0																										
		40	21.1	17.6	12.4	2.3																											
		50	17.0	11.7	2.0																												
		60																															
TWU4.18-08.10	1	0					27.0	25.5	23.6	21.2	18.8	15.9	12.0																				
		20		28.0	26.6	25.1	22.7	20.0	17.6	14.0	10.0																						
		30	27.9	26.1	24.3	22.2	19.8	17.1	13.8	8.3																							
		40	26.0	24.1	22.0	19.7	17.0	13.1	8.0																								
		50	24.0	22.0	19.1	16.5	13.0	7.1																									
		60	21.0	18.6	15.8	12.0																											
Shut-off PSI			103	94	86	77	68	60	51	42	34	25	16																				
TWU4.18-11.15	1½	0					28.4	27.2	26.0	24.8	23.0	21.4	19.6	17.5	15.0	12.1																	
		20				27.8	26.8	25.4	24.0	22.2	20.6	18.8	16.7	14.0	10.0																		
		30			27.7	26.5	25.3	23.8	22.0	20.2	18.5	16.1	13.5	10.0																			
		40		27.5	26.3	25.0	23.6	22.0	20.1	18.1	16.0	13.1	9.5																				
		50	27.6	26.4	25.0	23.4	21.8	20.0	18.0	15.5	13.0	9.2																					
		60	26.0	24.6	23.0	21.2	19.5	17.5	15.0	12.0	7.9																						
Shut-off PSI			143	134	126	117	108	100	91	82	74	65	56	48	39	30	22																
TWU4.18-14.20	2	0					28.0	27.1	26.2	25.1	24.0	22.9	21.4	20.0	16.8	12.8																	
		20				27.8	26.8	25.8	24.6	23.7	22.6	21.0	19.5	18.0	16.0	11.6																	
		30				27.5	26.5	25.5	24.5	23.3	22.1	20.6	19.0	17.5	15.8	13.6	6.5																
		40			28.5	27.4	26.4	25.4	24.4	23.2	22.0	20.5	18.9	17.4	15.7	13.5	11.0																
		50	28.0	27.2	26.2	25.3	24.3	23.0	21.8	20.3	18.7	17.0	15.3	13.1	10.5	6.0																	
		60	28.0	27.1	26.2	25.1	24.0	22.9	21.4	20.0	18.3	16.8	14.8	12.8	9.5																		
Shut-off PSI			183	174	165	157	148	139	131	122	113	105	96	87	79	70	61	44	27														
TWU4.18-19.30	3	0									28.0	27.4	26.7	26.0	25.0	23.5	21.5	19.2	16.9	14.2	10.5												
		20									27.7	27.0	26.3	25.8	24.9	24.0	23.0	21.0	18.9	16.5	13.5	9.0											
		30									27.6	26.9	26.2	25.5	24.8	23.9	22.9	21.9	19.8	17.5	14.9	11.2											
		40									27.5	26.9	26.2	25.4	24.6	23.8	22.8	21.8	20.9	18.5	16.0	13.3	8.0										
		50								27.4	26.8	26.0	25.2	24.5	23.6	22.6	21.7	20.6	19.5	17.3	14.5	11.0											
		60						28.0	27.4	26.7	26.0	25.0	24.3	23.5	22.5	21.5	20.5	19.2	18.0	15.7	12.8	7.0											
Shut-off PSI						225	216	208	199	190	182	173	164	156	147	139	130	113	95	78	61	43	26										
TWU4.18-30.50	5	0															27.9	26.8	25.8	24.8	23.7	22.6	21.2	19.9	18.4	16.8	14.8	12.4	9.7				
		20															27.5	26.6	25.6	24.5	23.3	22.2	21.0	19.8	18.0	16.2	14.3	12.0	8.8				
		30															28.0	26.9	26.0	25.0	23.9	22.9	21.6	20.3	18.6	17.0	15.0	13.0	10.2	6.2			
		40															28.0	27.4	26.3	25.3	24.4	23.2	22.1	20.1	19.4	17.9	16.0	14.0	11.6	8.0			
		50															27.9	27.3	26.8	25.9	24.9	23.8	22.7	21.3	20.1	18.5	16.9	14.9	12.8	10.0	6.0		
		60															27.9	27.2	26.8	26.2	25.2	24.1	23.0	21.9	20.7	19.2	17.5	15.8	13.6	11.0	7.8		
Shut-off PSI																307	298	290	281	264	246	229	212	195	177	160	143	125	108	91	73	56	39

25 GPM

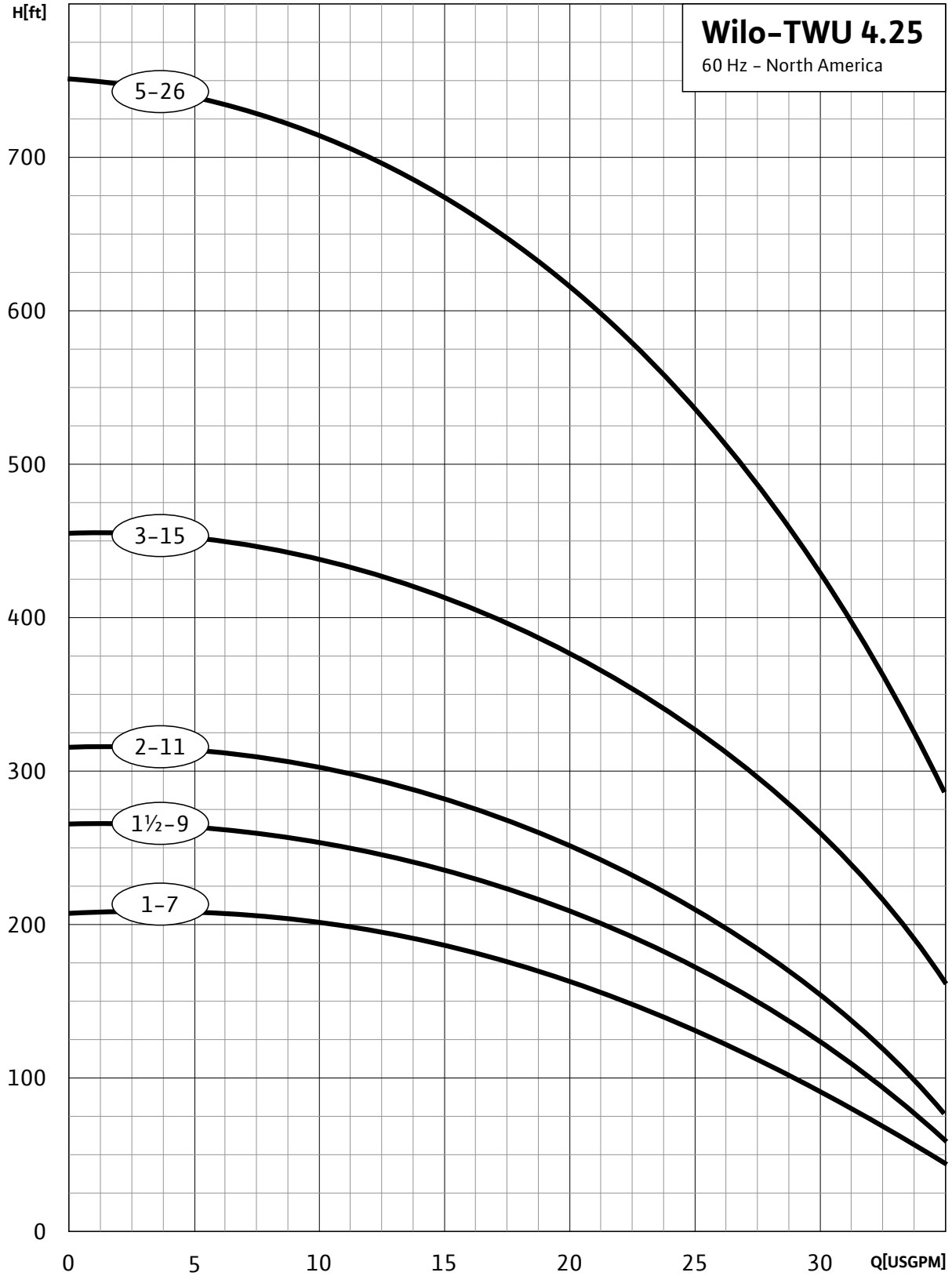

MODEL	HP	PSI	Depth to Water in Feet																											
			20	40	60	80	100	120	140	160	180	200	220	240	260	280	300	340	380	420	460	500	540	580	620	660	700	740		
TWU4.25-07.10	1	0			32.8	30.8	28.6	26.2	23.5	20.0	16.2	11.0																		
		20	31.8	30.0	27.5	25.2	22.0	19.0	15.0	8.0																				
		30	29.6	27.2	25.0	21.6	18.0	14.0																						
		40	27.1	24.9	21.5	17.9	13.9																							
		50	24.3	21.0	17.5	13.0																								
		60	20.0	16.2	11.0																									
Shut-off PSI			82	74	65	56	48	39	30	22	13	4																		
TWU4.25-09.15	1½	0				33.0	31.8	30.3	28.8	26.9	24.8	22.0	19.8	16.5	11.0															
		20		32.6	31.2	29.6	28.0	26.0	23.8	21.0	18.1	14.8	8.0																	
		30	32.5	31.0	29.5	27.6	25.6	23.2	20.9	17.9	14.0																			
		40	30.9	29.4	27.5	25.5	23.1	20.8	17.7	13.6																				
		50	29.0	27.2	25.1	22.9	20.4	17.2	13.0																					
		60	26.9	24.8	22.0	19.8	16.5	11.0																						
Shut-off PSI			111	103	94	85	77	68	59	51	42	33	25	16	7															
TWU4.25-11.20	2	0					33.0	31.8	30.4	29.0	27.4	25.7	22.6	21.5	19.3	15.4														
		20				32.7	31.3	30.0	28.6	26.8	25.0	22.9	20.9	18.3	14.3	9.0														
		30			32.3	31.0	29.6	28.5	26.4	24.5	22.6	20.5	18.0	14.0	8.0															
		40			30.9	29.5	28.2	26.3	24.3	22.4	20.4	17.8	13.6	8.0																
		50		30.5	29.4	28.0	26.0	24.1	22.1	20.0	17.2	13.2																		
		60	30.4	29.0	27.4	25.7	22.6	21.5	19.3	15.4	12.2																			
Shut-off PSI			139	130	121	113	104	95	87	78	69	61	52	43	35	26	17													
TWU4.25-15.30	3	0							33.0	32.2	31.5	30.5	29.6	28.3	27.1	25.8	22.6	19.0	14.0											
		20						32.8	32.0	31.0	30.0	29.0	27.9	26.6	25.0	23.8	21.9	20.0	12.6											
		30					32.6	31.8	30.9	30.0	28.8	27.6	25.5	24.9	23.4	21.6	19.9	15.2	8.0											
		40				32.5	31.7	30.9	29.9	28.8	27.5	26.2	24.7	23.3	21.5	19.9	17.8	11.9												
		50			32.3	31.6	30.8	29.8	28.5	27.3	26.0	24.5	23.0	21.2	19.5	17.4	11.5													
		60	33.0	32.2	31.5	30.5	29.6	28.3	27.1	25.8	24.1	22.6	20.9	19.0	16.9	14.0	10.0													
Shut-off PSI			191	183	174	165	157	148	139	131	122	113	105	96	87	79	70	53	35	18										
TWU4.25-26.50	5	0														33.0	32.5	31.5	30.2	29.0	27.6	26.0	24.2	22.4	20.5	18.3	15.8	12.0		
		20														32.9	32.3	31.8	31.3	30.0	28.8	27.2	25.8	23.9	22.0	20.0	17.8	15.0	11.0	
		30														32.8	32.2	31.8	31.2	30.5	29.3	27.9	26.4	24.8	22.9	21.0	18.9	16.2	13.0	8.0
		40														32.7	32.1	31.7	31.1	30.4	29.9	28.5	27.1	25.4	23.7	21.9	19.9	17.5	14.5	10.5
		50														32.6	32.1	31.6	31.0	30.3	29.9	29.2	27.8	26.3	24.5	22.6	21.8	18.7	16.0	12.7
		60									33.0	32.5	32.0	31.5	30.8	30.2	29.8	29.0	28.3	26.9	25.1	23.3	21.5	19.5	17.0	14.0	9.5			
Shut-off PSI									286	277	268	260	251	242	234	225	216	199	182	165	147	130	113	95	78	61	43	26		

Wilo-TWU 4.25 weight & dimensional data can be found on page 52



Wilо-TWU 4.35

Submersible Well Pumps with Noryl Impeller



35 GPM

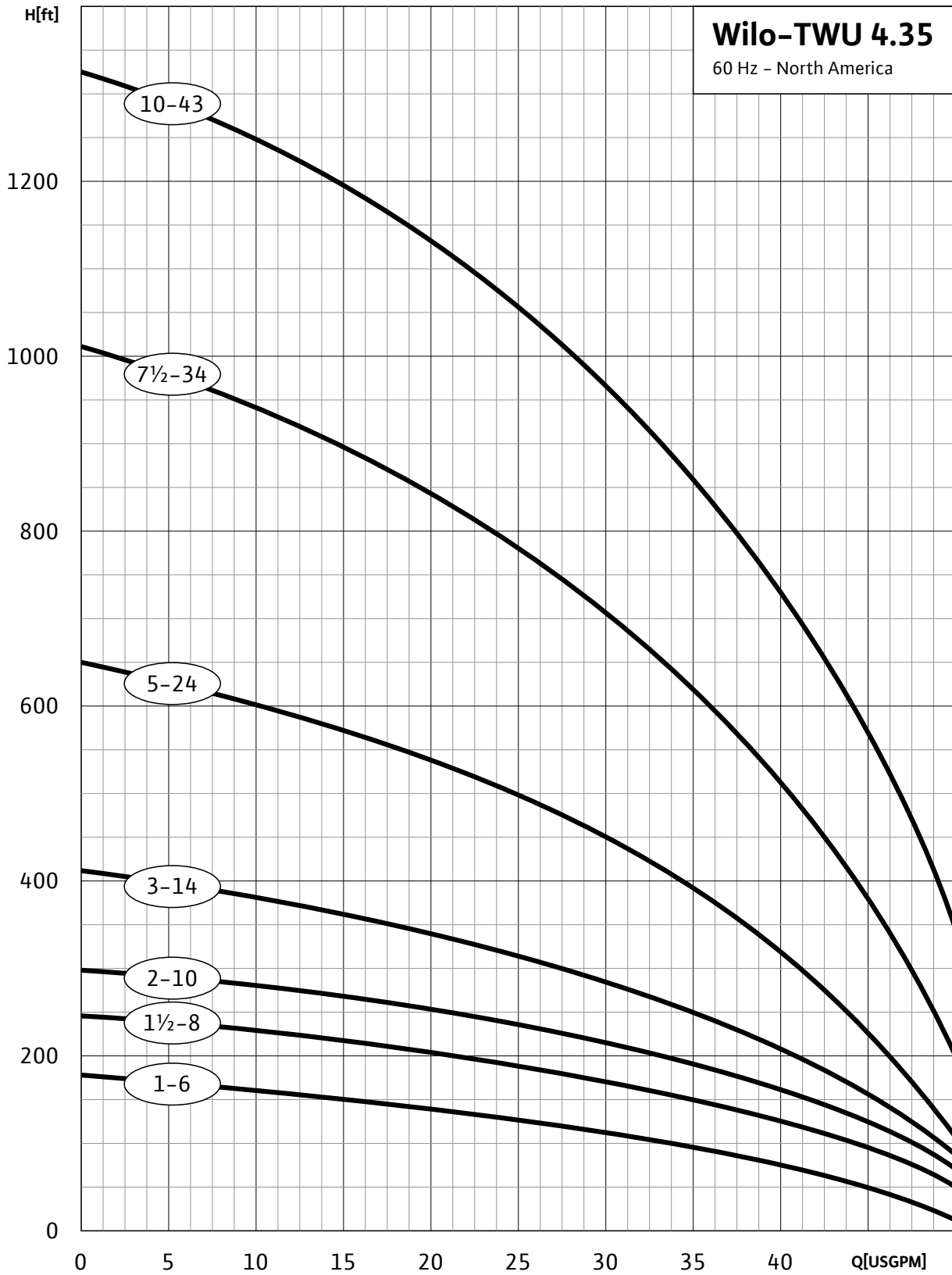

MODEL	HP	PSI	Depth to Water in Feet																											
			20	40	60	80	100	120	140	160	180	200	220	240	260	280	300	320	340	360	380	400	420	440	460	480	520	560	600	
TWU4.35-06.10	1	0		48	45	41	36	30	22	11																				
		20	44	39	34	28	19																							
		30	39	33	27	17																								
		40	32	25	15																									
		50	24	14																										
		60	12																											
Shut-off PSI			67	58	50	41	32	24	15	6																				
TWU4.35-08.15	1½	0		50	48	46	43	40	37	32	26	19																		
		20	48	45	43	39	35	31	24	17																				
		30	45	42	39	35	30	23	15																					
		40	42	38	34	29	22	14																						
		50	38	33	28	21	12																							
		60	33	27	20	11																								
Shut-off PSI			95	86	78	69	60	52	43	34	26	17																		
TWU4.35-10.20	2	0			49	48	46	44	41	38	35	32	28	22																
		20	49	47	45	43	40	38	34	31	26	21	14																	
		30	47	45	42	40	37	34	30	25	20	13																		
		40	44	42	40	37	33	29	24	19	11																			
		50	42	39	36	33	29	24	18																					
		60	39	36	32	28	23	16																						
Shut-off PSI			121	112	103	95	86	77	69	60	51	43	34	26																
TWU4.35-14.30	3	0				49	48	46	45	43	41	40	38	35	33	31	28	24	20	15										
		20	50	49	47	46	44	43	41	39	37	35	32	30	27	23	19	13												
		30	49	47	46	44	42	41	39	37	34	32	29	26	22	18	12													
		40	47	45	44	42	40	38	36	34	32	29	25	22	17	11														
		50	45	44	42	40	38	36	34	31	28	25	21	16																
		60	43	42	40	38	36	33	31	28	24	20	15																	
Shut-off PSI			170	161	152	144	135	126	118	109	100	92	83	74	66	57	48	40	31	23										

MODEL	HP	PSI	Depth to Water in Feet																											
			50	100	150	200	250	300	350	400	450	500	550	600	650	700	750	800	850	900	950	1000	1050	1100	1150	1200	1250	1300	1350	
TWU4.35-24.50	5	0																												
		20	50	48	46	44	41	38	35	31	27	20	11																	
		30	49	47	45	43	40	37	34	30	25	17																		
		40	48	46	44	41	39	36	32	27	21	12																		
		50	47	45	43	40	37	34	30	25	18																			
		60	46	44	42	39	36	32	28	22	13																			
Shut-off PSI			264	242	220	199	177	156	134	112	91	69	47	26																
TWU4.35-34.75	7½	0				50	48	47	46	44	42	40	38	36	33	31	27	23	19	14										
		20			50	49	47	46	44	42	41	38	36	34	31	28	24	19	14											
		30		50	49	48	46	45	43	42	40	37	35	32	29	26	22	17	12											
		40		50	49	47	46	44	43	41	39	36	34	31	28	24	20	15												
		50		49	48	47	45	43	42	40	38	35	33	30	26	22	17	12												
		60	50	49	47	46	44	43	41	39	37	34	31	28	24	20	15													
Shut-off PSI			415	393	371	350	328	306	285	263	241	220	198	176	155	133	111	90	68	47										
TWU4.35-43.100	10	0																												
		20						50	48	46	45	43	42	41	40	39	38	36	34	31	29	25	22	18	14					
		30						49	47	45	44	43	42	41	40	38	37	35	33	30	27	24	20	16	12					
		40					50	48	46	45	44	43	42	40	39	38	36	34	32	29	26	22	18	14						
		50					49	47	45	44	43	42	41	40	39	37	35	33	30	27	24	20	16	12						
		60					50	48	46	45	44	43	42	41	39	38	36	34	32	29	26	22	19	14						
Shut-off PSI			551	529	508	486	464	443	421	399	378	356	334	313	291	269	248	226	205	183	161	140	118	96	75	53				

Wilo-TWU 4.35 weight & dimensional data can be found on page 53



Wilo-TWU 4.55

Submersible Well Pumps with Noryl Impeller



55 GPM

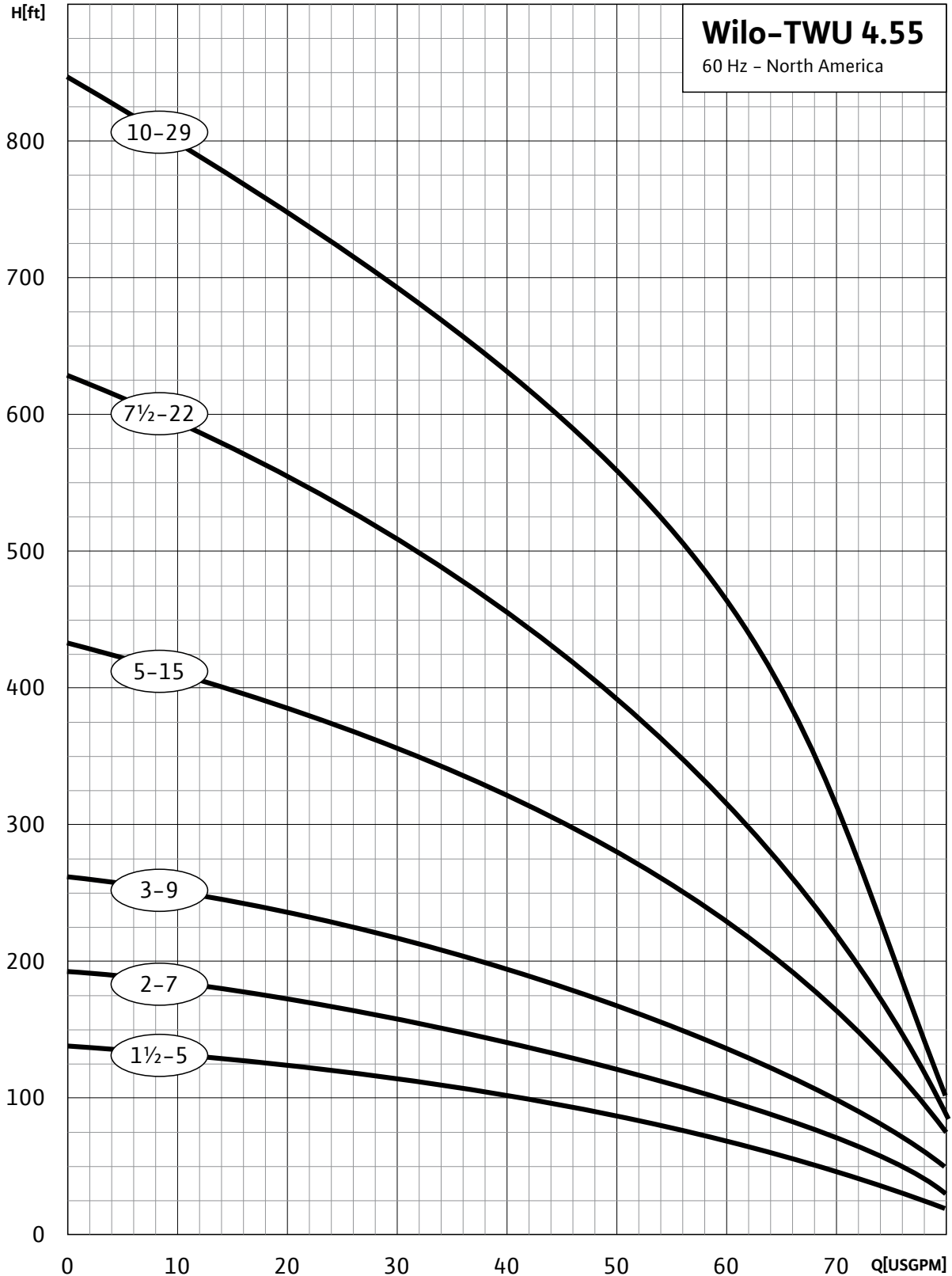

MODEL	HP	PSI	Depth to Water in Feet																								
			20	40	60	80	100	120	140	160	180	200	220	240	260	280	300	320	340	360	380	400	420	440	460	480	500
TWU4.55-05.15	1½	0	78	71	64	54	42	24																			
		20	61	51	37																						
		30	49	35																							
		40	32																								
		50																									
		60																									
Shut-off PSI			52	43	35	26	17	9																			
TWU4.55-07.20	2	0		76	71	65	58	50	41	28																	
		20	69	63	56	48	37	24																			
		30	62	55	46	35	21																				
		40	54	45	34																						
		50	43	32																							
		60	29																								
Shut-off PSI			76	67	58	50	41	32	24	15																	
TWU4.55-09.30	3	0		80	76	72	68	63	58	52	44	35															
		20	75	71	67	62	56	49	42	32																	
		30	70	66	61	55	48	40	30																		
		40	65	60	54	47	39	28																			
		50	59	53	46	37	26																				
		60	52	45	36	25																					
Shut-off PSI			102	94	85	76	68	59	50	42	33	24															
TWU4.55-15.50	5	0			80	78	76	73	71	68	65	62	58	55	50	46	40	34	27								
		20		80	77	75	73	70	67	64	61	57	53	49	44	39	32	25									
		30	79	77	75	72	70	67	64	60	57	53	48	43	38	31	24										
		40	77	74	72	69	66	63	60	56	52	47	42	37	30	23											
		50	74	71	69	66	63	59	55	51	47	42	36	29	22												
		60	71	68	65	62	59	55	51	46	41	35	28	20													
Shut-off PSI			178	169	161	152	143	135	126	117	109	100	91	83	74	65	57	48	39	31							

MODEL	HP	PSI	Depth to Water in Feet																								
			20	60	100	140	180	220	260	300	340	380	420	460	500	540	580	620	660	700	740	780	820	860	900	940	980
TWU4.55-22.75	7½	0			79	76	73	70	66	62	58	52	46	39	31	22											
		20		78	76	73	69	66	61	57	52	45	38	30	20												
		30	80	77	74	71	67	63	59	54	48	41	33	24													
		40	78	75	72	69	65	61	56	51	44	37	28														
		50	76	73	70	67	63	58	53	47	40	32	23														
		60	75	72	68	64	60	55	50	43	36	27															
Shut-off PSI			261	243	226	209	191	174	157	139	122	105	88	70	53	36											
TWU4.55-29.100	10	0			80	78	76	75	73	71	68	66	63	60	56	51	47	41	35	28							
		20		80	78	76	74	73	70	68	65	62	59	55	51	46	40	33	26								
		30		79	77	75	73	71	69	67	64	61	57	53	48	42	36	29	22								
		40	79	78	76	74	72	70	68	65	62	59	55	50	45	39	32	25									
		50	78	77	75	73	71	69	66	63	60	56	52	47	42	35	28	21									
		60	77	76	74	72	70	67	65	61	58	54	49	44	38	31	24										
Shut-off PSI			353	336	319	301	284	267	250	232	215	198	180	163	146	128	111	94	76	59							

Wilo-TWU 4.55 weight & dimensional data can be found on page 54



Wilo-TWU 4.80

Submersible Well Pumps with Noryl Impeller



80 GPM

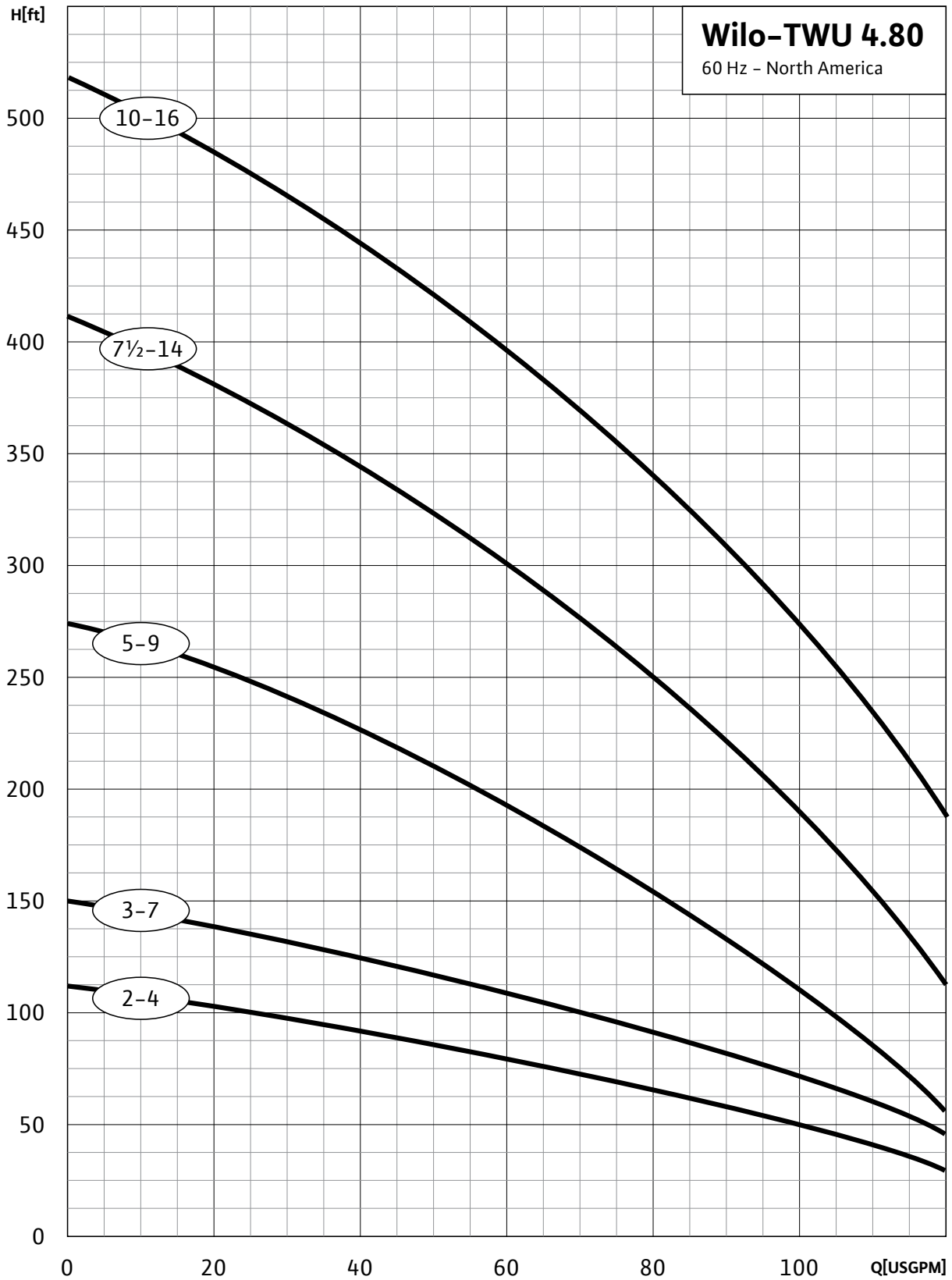

MODEL	HP	PSI	Depth to Water in Feet																								
			20	40	60	80	100	120	140	160	180	200	220	240	260	280	300	320	340	360	380	400	420	440	460		
TWU4.80-4.20	2	0	97	87	77	66	49	33																			
		20	87	60	46	26																					
		30	63	42	26																						
		40	45	25																							
		50	22																								
		60																									
Shut-off PSI																											
TWU4.80-5.30	3	0		119	105	87	68																				
		20	99	82	62																						
		30	79	58																							
		40	55																								
		50																									
		60																									
Shut-off PSI			55	46	38	29	20																				
TWU4.80-9.50	5	0				118	109	101	92	71	58																
		20	123	115	107	98	89	78	67	54																	
		30	114	105	97	87	77	65																			
		40	104	95	86	75	63																				
		50	93	84	73	61																					
		60	82	72	59																						
Shut-off PSI			107	98	90	81	72	64	55	46	38	29															
TWU4.80-14.75	7½	0						115	110	104	98	82	86	79	72	65	57										
		20			119	114	108	102	97	90	84	77	69	63													
		30		118	113	107	102	96	89	83	76	69	62														
		40	117	112	106	101	95	88	82	75	68	60															
		50	111	106	99	94	87	81	74	67	59																
		60	105	99	93	86	80	73	66	58																	
Shut-off PSI			171	162	153	145	136	127	119	110	101	93	84	75	67	58	49										
TWU4.80-16.100	10	0							120	117	111	107	101	95	90	85	79	74	67	57	53	43	37	28			
		20							118	112	106	102	96	90	85	79	73	55	58	52	44	36	26				
		30					115	112	110	106	99	94	88	83	77	71	63	56	50	40	32	25					
		40					115	113	109	103	97	92	87	82	76	69	63	55	48	38	32						
		50					116	113	108	103	97	92	87	80	75	68	63	55	48	39	32						
		60	120	116	112	107	103	97	92	85	79	74	68	62	56	45	38	28									
Shut-off PSI			216	208	119	190	181	173	164	156	147	138	130	121	112	104	95	86	78	69	61	52	43	35			

Wilo-TWU 4.80 weight & dimensional data can be found on page 55



Weights and Dimensions

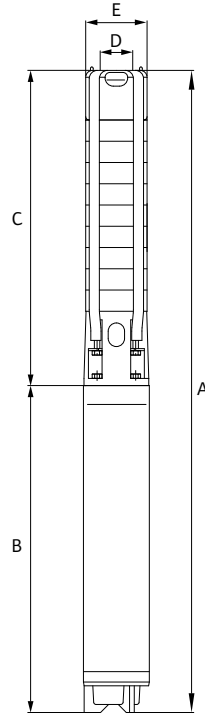

5 GPM										
Motor Type	Model	HP	Dimensions (In)					Weights (Lbs)		
			A	B	C	D	E	Complete Unit	Pump End	Motor
2 Wire	TWU 4.05-12.05	½	26	11	15	1¼	3.9	29	9	20
	TWU 4.05-12.05	½	26	11	15			29	9	20
	TWU 4.05-15.07	¾	29.4	12.4	17			34	11	23
	TWU 4.05-20.10	1	35	13.3	21.7			38	13	25
	TWU 4.05-26.15	1½	40.7	14.9	25.8			45	15	30
3 Wire	TWU 4.05-12.05	½	25	10	15			38	9	19
	TWU 4.05-12.05	½	24.7	9.7	15			38	9	19
	TWU 4.05-15.07	¾	27.8	10.8	17			33	11	22
	TWU 4.05-20.10	1	33.4	11.7	21.7			38	13	25
	TWU 4.05-20.10	1	33.4	11.7	21.7			38	13	25
	TWU 4.05-20.10	1	33.4	11.7	21.7			38	13	25
	TWU 4.05-26.15	1	39.4	13.6	25.8			42	15	27
	TWU 4.05-26.15	1½	37.5	11.7	25.8			38	15	23
	TWU 4.05-26.15	1½	37.5	11.7	25.8			38	15	23
	TWU 4.05-33.20	1½	46.7	15.1	31.6	50	19	31		
	TWU 4.05-33.20	2	45.4	13.8	31.6	46	19	27		
	TWU 4.05-33.20	2	45.4	13.8	31.6	46	19	27		

7 GPM										
Motor Type	Model	HP	Dimensions (In)					Weights (Lbs)		
			A	B	C	D	E	Complete Unit	Pump End	Motor
2 Wire	TWU 4.07-10.05	½	24.8	11	13.8	1¼	3.9	27	7	20
	TWU 4.07-10.05	½	24.8	11	13.8			27	7	20
	TWU 4.07-13.07	¾	28.4	12.4	16			31	8	23
	TWU 4.07-17.10	1	32.1	13.3	18.8			34	9	25
	TWU 4.07-22.15	1½	38.5	14.9	23.6			42	12	30
3 Wire	TWU 4.07-10.05	½	23.8	10	13.8			26	7	19
	TWU 4.07-10.05	½	23.5	9.7	13.8			26	7	19
	TWU 4.07-13.07	¾	26.8	10.8	16			31	8	22
	TWU 4.07-17.10	1	30.5	11.7	18.8			34	9	25
	TWU 4.07-17.10	1	30.5	11.7	18.8			34	9	25
	TWU 4.07-17.10	1	30.5	11.7	18.8			34	9	25
	TWU 4.07-22.15	1½	37.2	13.6	23.6			39	12	27
	TWU 4.07-22.15	1½	35.3	11.7	23.6			35	12	23
	TWU 4.07-22.15	1½	35.3	11.7	23.6			35	12	23
	TWU 4.07-27.20	2	42.3	15.1	27.2			44	13	31
	TWU 4.07-27.20	2	41	13.8	27.2	40	13	27		
	TWU 4.07-27.20	2	41	13.8	27.2	40	13	27		
	TWU 4.07-34.30	3	51.5	18.3	33.2	58	18	40		
	TWU 4.07-34.30	3	48.5	15.3	33.2	50	18	32		
	TWU 4.07-34.30	3	48.5	15.3	33.2	50	18	32		

Weights and Dimensions

10 GPM										
Motor Type	Model	HP	Dimensions (In)					Weights (Lbs)		
			A	B	C	D	E	Complete Unit	Pump End	Motor
2 Wire	TWU 4.10-07.05	½	22.5	11.0	11.5	1¼	3.9	27	7	20
	TWU 4.10-07.05	½	22.5	11.0	11.5			27	7	20
	TWU 4.10-10.07	¾	26	12.4	13.6			31	8	23
	TWU 4.10-12.10	1	28.3	13.3	15			34	9	25
	TWU 4.10-17.15	1½	33.3	14.9	18.4			42	12	30
3 Wire	TWU 4.10-07.05	½	21.5	10.0	11.5			26	7	19
	TWU 4.10-07.05	½	21.2	9.7	11.5			26	7	19
	TWU 4.10-10.07	¾	24.4	10.8	13.6			31	8	22
	TWU 4.10-12.10	1	26.7	11.7	15			34	9	25
	TWU 4.10-12.10	1	26.7	11.7	15			34	9	25
	TWU 4.10-12.10	1	26.7	11.7	15			34	9	25
	TWU 4.10-17.15	1½	32	13.6	18.4			39	12	27
	TWU 4.10-17.15	1½	30.1	11.7	18.4			35	12	23
	TWU 4.10-17.15	1½	30.1	11.7	18.4			35	12	23
	TWU 4.10-20.20	2	36.8	15.1	21.7			44	13	31
	TWU 4.10-20.20	2	35.5	13.8	21.7			40	13	27
	TWU 4.10-20.20	2	35.5	13.8	21.7			40	13	27
	TWU 4.10-27.30	3	45.8	18.3	27.5			58	18	40
	TWU 4.10-27.30	3	42.8	15.3	27.5			50	18	32
	TWU 4.10-27.30	3	42.8	15.3	27.5			50	18	32
TWU 4.10-42.50	5	67.9	27.7	40.2	94	24	70			
TWU 4.10-42.50	5	61.9	21.7	40.2	79	24	55			
TWU 4.10-42.50	5	61.9	21.7	40.2	79	24	55			

13 GPM										
Motor Type	Model	HP	Dimensions (In)					Weights (Lbs)		
			A	B	C	D	E	Complete Unit	Pump End	Motor
2 Wire	TWU4.13-10.10	1	26.8	13.3	13.5	1¼	3.9	34	7	25
	TWU4.13-12.15	1½	29.7	13.6	16.1			37	9	30



13 GPM continued										
Motor Type	Model	HP	Dimensions (In)					Weights (Lbs)		
			A	B	C	D	E	Complete Unit	Pump End	Motor
3 Wire	TWU4.13-10.10	1	26.8	13.3	13.5	1¼	3.9	32	7	25
	TWU4.13-10.10	1	26.8	13.3	13.5			31	7	25
	TWU4.13-10.10	1	26.8	13.3	13.5			31	7	25
	TWU4.13-12.15	1½	29.7	13.6	16.1			35	9	27
	TWU4.13-12.15	1½	29.7	13.6	16.1			34	9	23
	TWU4.13-12.15	1½	29.7	13.6	16.1			34	9	23
	TWU4.13-17.20	2	33.7	15.1	18.6			36	12	31
	TWU4.13-17.20	2	33.7	15.1	18.6			35	12	27
	TWU4.13-17.20	2	33.7	15.1	18.6			35	12	27
	TWU4.13-21.30	3	39.4	15.3	24.1			38	14	40
	TWU4.13-21.30	3	39.4	15.3	24.1			36	14	32
	TWU4.13-21.30	3	39.4	15.3	24.1			36	14	32
	TWU4.13-35.50	5	62.1	27.7	34.4			59	19	70
	TWU4.13-35.50	5	62.1	27.7	34.4			52	19	55
TWU4.13-35.50	5	62.1	27.7	34.4	52	19	55			

18 GPM										
Motor Type	Model	HP	Dimensions (In)					Weights (Lbs)		
			A	B	C	D	E	Complete Unit	Pump End	Motor
2 Wire	TWU 4.18-05.05	½	21.5	11.0	10.5	1¼	3.9	26	6	20
	TWU 4.18-05.05	½	21.5	11.0	10.5			26	6	20
	TWU 4.18-06.07	¾	24.2	12.4	11.8			30	7	23
	TWU 4.18-08.10	1	26.8	13.3	13.5			33	8	25
	TWU 4.18-11.15	1½	31	14.9	16.1			40	10	30
3 Wire	TWU 4.18-05.05	½	20.5	10.0	10.5			25	6	19
	TWU 4.18-05.05	½	20.2	9.7	10.5			25	6	19
	TWU 4.18-06.07	¾	22.6	10.8	11.8			29	7	22
	TWU 4.18-08.10	1	25.2	11.7	13.5			33	8	25
	TWU 4.18-08.10	1	25.2	11.7	13.5			33	8	25
	TWU 4.18-08.10	1	25.2	11.7	13.5			33	8	25
	TWU 4.18-11.15	1½	29.7	13.6	16.1			37	10	27
	TWU 4.18-11.15	1½	27.8	11.7	16.1			33	10	23
	TWU 4.18-11.15	1½	27.8	11.7	16.1			33	10	23
	TWU 4.18-14.20	2	33.7	15.1	18.6			42	11	31
	TWU 4.18-14.20	2	32.4	13.8	18.6			38	11	27
	TWU 4.18-14.20	2	32.4	13.8	18.6			38	11	27
	TWU 4.18-19.30	3	42.4	18.3	24.1			55	15	40
	TWU 4.18-19.30	3	39.4	15.3	24.1			47	15	32
TWU 4.18-19.30	3	39.4	15.3	24.1	47	15	32			
TWU 4.18-30.50	5	62.1	27.7	34.4	91	21	70			
TWU 4.18-30.50	5	56.1	21.7	34.4	76	21	55			
TWU 4.18-30.50	5	56.1	21.7	34.4	76	21	55			

Weights and Dimensions

25 GPM										
Motor Type	Model	HP	Dimensions (In)					Weights (Lbs)		
			A	B	C	D	E	Complete Unit	Pump End	Motor
2 Wire	TWU 4.25-07.10	1	26.7	13.3	13.4	1¼	3.9	33	8	25
	TWU 4.25-09.15	1½	30.2	14.9	15.3			39	9	30
3 Wire	TWU 4.25-07.10	1	25.1	11.7	13.4			33	8	25
	TWU 4.25-07.10	1	25.1	11.7	13.4			33	8	25
	TWU 4.25-07.10	1	25.1	11.7	13.4			33	8	25
	TWU 4.25-09.15	1½	28.9	13.6	15.3			36	9	27
	TWU 4.25-09.15	1½	27	11.7	15.3			32	9	23
	TWU 4.25-09.15	1½	27	11.7	15.3			32	9	23
	TWU 4.25-11.20	2	32.3	15.1	17.2			41	10	31
	TWU 4.25-11.20	2	31	13.8	17.2			37	10	27
	TWU 4.25-11.20	2	31	13.8	17.2			37	10	27
	TWU 4.25-15.30	3	39.2	18.3	20.9			54	14	40
	TWU 4.25-15.30	3	36.2	15.3	20.9			46	14	32
	TWU 4.25-15.30	3	36.2	15.3	20.9			46	14	32
	TWU 4.25-26.50	5	61.1	27.7	33.4			91	21	70
	TWU 4.25-26.50	5	55.1	21.7	33.4			76	21	55
TWU 4.25-26.50	5	55.1	21.7	33.4	76			21	55	

35 GPM										
Motor Type	Model	HP	Dimensions (In)					Weights (Lbs)		
			A	B	C	D	E	Complete Unit	Pump End	Motor
2 Wire	TWU 4.35-06.10	1	27.5	13.3	14.2	1¼	3.9	33	8	25
	TWU 4.35-08.15	1½	31.5	14.9	16.6			39	9	30
3 Wire	TWU 4.35-06.10	1	25.9	11.7	14.2	1¼	3.9	33	8	25
	TWU 4.35-06.10	1	25.9	11.7	14.2			33	8	25
	TWU 4.35-06.10	1	25.9	11.7	14.2			33	8	25
	TWU 4.35-08.15	1½	30.2	13.6	16.6			36	9	27
	TWU 4.35-08.15	1½	28.3	11.7	16.6			32	9	23
	TWU 4.35-08.15	1½	28.3	11.7	16.6			32	9	23
	TWU 4.35-10.20	2	34.2	15.1	19.1			41	10	31
	TWU 4.35-10.20	2	32.9	13.8	19.1			37	10	27
	TWU 4.35-10.20	2	32.9	13.8	19.1			37	10	27
	TWU 4.35-14.30	3	42.3	18.3	24			53	13	40
	TWU 4.35-14.30	3	39.3	15.3	24			45	13	32
	TWU 4.35-14.30	3	39.3	15.3	24			45	13	32
	TWU 4.35-24.50	5	62.9	27.7	35.2			89	19	70
	TWU 4.35-24.50	5	56.9	21.7	35.2			74	19	55
	TWU 4.35-24.50	5	62.9	27.7	35.2			74	19	55
	TWU 4.35-34.75	7½	78.3	27.7	50.6			97	27	70
	TWU 4.35-34.75	7½	78.3	27.7	50.6			97	27	70
	TWU 4.35-43.100	10	88.2	25.4	62.8			127	33	95
TWU 4.35-43.100	10	88.2	25.4	62.8	127	33	95			

Weights and Dimensions

55 GPM										
Motor Type	Model	HP	Dimensions (In)					Weights (Lbs)		
			A	B	C	D	E	Complete Unit	Pump End	Motor
2 Wire	TWU 4.55-05.15	1½	32	14.9	17.1	1¼	3.9	40	10	30
	TWU 4.55-05.15	1½	30.7	13.6	17.1			37	10	27
3 Wire	TWU 4.55-05.15	1½	28.8	11.7	17.1			33	10	23
	TWU 4.55-05.15	1½	28.8	11.7	17.1			33	10	23
	TWU 4.55-07.20	2	36.3	15.1	21.2			43	12	31
	TWU 4.55-07.20	2	35	13.8	21.2			39	12	27
	TWU 4.55-07.20	2	35	13.8	21.2			39	12	27
	TWU 4.55-09.30	3	43.6	18.3	25.3			55	15	40
	TWU 4.55-09.30	3	40.6	15.3	25.3			47	15	32
	TWU 4.55-09.30	3	40.6	15.3	25.3			47	15	32
	TWU 4.55-15.50	5	66.8	27.7	39.1			92	22	70
	TWU 4.55-15.50	5	60.8	21.7	39.1			77	22	55
	TWU 4.55-15.50	5	60.8	21.7	39.1			77	22	55
	TWU 4.55-22.75	7½	81.8	27.7	54.1			102	32	70
	TWU 4.55-22.75	7½	81.8	27.7	54.1			102	32	70
	TWU 4.55-29.100	10	123.8	25.4	98.4			134	39	95
	TWU 4.55-29.100	10	123.8	25.4	98.4			134	39	95

80 GPM										
Motor Type	Model	HP	Dimensions (In)					Weights (Lbs)		
			A	B	C	D	E	Complete Unit	Pump End	Motor
3 Wire	TWU 4.80-07.30	3	39.7	18.3	21.4	1¼	3.9	50	10	40
	TWU 4.80-07.30	3	36.7	15.3	21.4			42	10	32
	TWU 4.80-07.30	3	36.7	15.3	21.4			42	10	32
	TWU 4.80-09.50	5	57.1	27.7	29.4			83	13	70
	TWU 4.80-09.50	5	51.1	21.7	29.4			68	13	55
	TWU 4.80-09.50	5	51.1	21.7	29.4			68	13	55
	TWU 4.80-14.75	7½	70.5	27.7	42.8			94	24	70
	TWU 4.80-14.75	7½	70.5	27.7	42.8			94	24	70





4" Standard Motors

HP	kW	Wire / PH	Voltage	FL Amps	SF Amps	SF	Start Amps	Cos Φ	Article Number
½	0.37	2-Wire	115	7.4	11.8	1.6	26	0.99	2707600
			230	5.5	8.8	1.6	22	0.78	2707601
		3-Wire	115	7.4	11.8	1.6	26	0.99	2707605
			230	5.5	8.8	1.6	22	0.78	2707606
¾	0.55	2-Wire	230	7	10.5	1.5	32	0.74	2707602
		3-Wire	230	7	10.5	1.5	32	0.74	2707607
1	0.75	2-Wire	230	8.4	11.8	1.4	40	0.75	2707603
		3-Wire	230	8.4	11.8	1.4	40	0.75	2707608
		3 ~	230	4.5	6.3	1.4	22.5	0.76	2707609
			460	1.95	2.7	1.4	12.5	0.8	2707610
1½	1.1	2-Wire	230	10.1	13.2	1.3	49	0.83	2707604
		3-Wire	230	10.1	13.2	1.3	49	0.83	2707611
		3 ~	230	5.7	7.4	1.3	31.2	0.85	2707612
			460	2.8	3.6	1.3	15	0.81	2707613
2	1.5	3-Wire	230	11.4	14.2	1.25	52	0.87	2707614
		3 ~	230	7.3	9.2	1.25	43.3	0.8	2707615
			460	3.5	4.4	1.25	22	0.81	2707616
3	2.2	3-Wire	230	14.2	16.4	1.15	68	0.93	2707617
		3 ~	230	10.9	12.5	1.15	60.6	0.76	2707618
			460	4.9	5.6	1.15	30.5	0.78	2707619
5	3.7	3-Wire	230	24.6	28.3	1.15	88	0.92	2707620
		3 ~	230	17.7	20.4	1.15	95.3	0.79	2707621
			460	9	10.4	1.15	62	0.76	2707622
7½	5.5	3 ~	230	25.1	28.9	1.15	142	0.78	2707623
			460	12	13.8	1.15	77	0.78	2707624
10	7.5	3 ~	230	38.1	43.9	1.15	177	0.79	2761798
			460	16.2	18.7	1.15	95	0.77	2707625

4" Industrial Motors 3~

HP	kW	Wire / PH	Voltage	FL Amps	SF Amps	SF	Start Amps	Cos Φ	Article Number
HP	kW	PH (~)	Voltage	FL Amps	SF amps	SF	Start Amps	Cos Φ	Article
0.50	0.37	3	230	1	1.6	1.6	10.4	0.78	2707762
			460	1	1.6	1.6	6.8	0.74	2707763
0.75	0.55	3	230	1	1.5	1.5	17.3	0.76	2707765
			460	1	1.5	1.5	10.5	0.8	2707766
1.00	0.75	3	230	1	1.4	1.4	22.5	0.83	2707769
			460	1	1.4	1.4	12.5	0.83	2707770
1.50	1.1	3	230	1	1.3	1.3	31.2	0.85	2707772
1.50	1.1	3	460	1	1.3	1.3	15	0.81	2707773
2	1.5	3	230	1	1.25	1.25	52	0.8	2707775
			460	1	1.25	1.25	43.3	0.81	2707776
3	2.2	3	230	10.2	11.8	1.15	40	0.75	2707626
			460	5.8	6.7	1.15	24	0.74	2707627
5	3.7	3	230	16.6	19	1.15	78	0.76	2707628
			460	9.8	11.3	1.15	45	0.78	2707629
7½	5.5	3	230	23.5	27	1.15	95	0.77	2707630
			460	13.5	15.6	1.15	62	0.77	2707631
10	7.5	3	460	18.5	21.3	1.15	76	0.77	2707632

4" Standard & Industrial Motors

HP	kW	PH (-)	A (in)	B (in)	C (in)	D (in)	Weight (lbs)
½	0.37	1	3.7	1.5	9.8	0.61	15
¾	0.55	1	3.7	1.5	10.4	0.61	17.8
1	0.75	1	3.7	1.5	11.6	0.61	23.3
		3	3.7	1.5	10.4	0.61	18.3
1½	1.1	1	3.7	1.5	13.4	0.61	24.6
		3	3.7	1.5	11.6	0.61	24
2	1.5	1	3.7	1.5	14.8	0.61	30.8
		3	3.7	1.5	13.4	0.61	25.1
3	2.2	1	3.7	1.5	16.9	0.61	36.1
		3	3.7	1.5	14.8	0.61	31.2
5	3.7	1	3.7	1.5	26.6	0.61	64.5
		3	3.7	1.5	21.9	0.61	51.5
7½	5.5	3	3.7	1.5	26.6	0.61	64.7
10	7.5	3	3.7	1.5	31.9	0.61	74.6

4" CBM Motors

HP	kW	PH (-)	A (in)	B (in)	C (in)	D (in)	Weight (lbs)
3	2.2	3	3.66	1.5	18.5	0.61	31.2
5	3.7	3	3.66	1.5	22.8	0.61	48.4
7 1/2	5.5	3	3.66	1.5	25.6	0.61	49.3
10	7.5	3	3.66	1.5	31.9	0.61	59.4

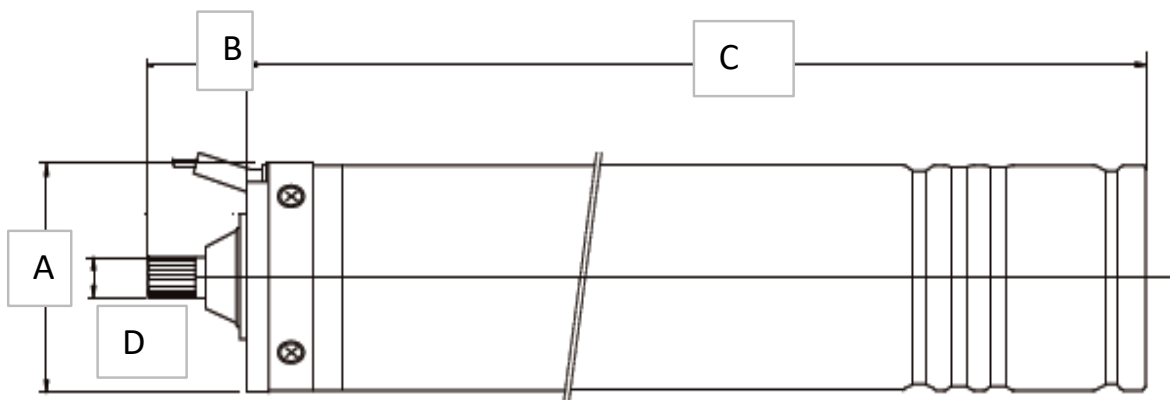

Submersible Motors – 4" Encapsulated & Industrial Data

TYPE – 2wire	Thrust #	Weight #	Height/ mm	H.P.	Kw	AMPS		St.Amps	RPM	Service Factor
						F.L.	S.F.			
115v	450	17	272	0.05	0.37	9.8	13	61	3550	1.6
230v	450	17	272	0.05	0.37	4.8	6.4	31	3550	1.6
230v	450	18	295	0.75	0.55	7	9.3	39	3500	1.5
230v	450	20	315	1	0.75	8.4	12	50	3500	1.4
230v	750	28	390	1.5	1.1	12	15.4	71	3500	1.3
TYPE – 3wire	Thrust #	Weight #	Height/ mm	H.P.	Kw	AMPS		St.Amps	RPM	Service Factor
						F.L.	S.F.			
115v	450	16	260	0.05	0.37	9.8	13	44	3550	1.6
230v	450	16	260	0.05	0.37	5.5	6.4	22	3550	1.6
230v	450	17	265	0.75	0.55	7	9.3	32	3520	1.5
230v	450	20	305	1	0.75	8.5	12	40	3520	1.4
230v	750	25	340	1.5	1.1	10.1	13	49	3500	1.3
230v	750	31	375	2	1.5	11.6	15	52	3500	1.25
230v	1500	36	430	3	2.2	14.8	16.9	68	3470	1.15
230v	1500	65	675	5	3.7	25.5	27.8	88	3580	1.15
TYPE – 3~	Thrust #	Weight #	Height/ mm	H.P.	Kw	AMPS		St.Amps	RPM	Service Factor
						F.L.	S.F.			
230v	450	13	235	0.05	0.37	2.3	3.5	10.4	3510	1.6
460v	450	13	235	0.05	0.37	1.2	1.6	6.8	3510	1.6
230v	450	15.5	250	0.75	0.55	3.5	5.2	17.3	3510	1.5
460v	450	15.5	250	0.75	0.55	1.6	1.95	10.5	3510	1.5
230v	750	18	265	1	0.75	4.5	6.2	22.5	3510	1.4
460v	750	18	265	1	0.75	2	2.5	12.5	3510	1.4
230v	750	24	295	1.5	1.1	5.7	7.3	31.2	3480	1.3
460v	750	24	295	1.5	1.1	2.8	3.3	15	3480	1.3
230v	750	25	340	2	1.5	7.3	9	43.3	3410	1.25
460v	750	25	340	2	1.5	3.5	4.2	22	3410	1.25
230v	1500	31	375	3	2.2	10.9	12.5	60.6	3450	1.15
460v	1500	31	375	3	2.2	4.9	5.5	30.5	3450	1.15
230v	1500	51.5	555	5.5	4	17.7	20.8	95.3	3470	1.15
460v	1500	51.5	555	5.5	4	9	9.9	45	3470	1.15
230v	1500	65	675	7.5	5.5	25.1	30	142	3470	1.15
460v	1500	65	675	7.5	5.5	12	13.3	77	3470	1.15
230v	1500	74.5	765	10	7.5	38.1	43.3	177	3470	1.15
460v	1500	74.5	765	10	7.5	16.2	18.5	95	3470	1.15

1~ 4" Wire Sizing (ft.)

Motor Rating		Copper Wire Size								
Voltage	HP	14	12	10	8	6	4	2	0	00
115	½	100	160	250	390	620	960	1460		
230	½	400	650	1020	1610	2510				
	¾	300	480	760	1200	1870	2890			
	1	250	400	630	990	1540	2380			
	1½	190	310	480	770	1200	1870	2850		
	2	150	250	390	620	970	1530	2360		
	3	120	190	300	470	750	1190	1850	2890	
	5			180	280	450	710	1110	1740	2170
	7½				200	310	490	750	1140	1410
	10					250	390	600	930	1160

3~ 4" Wire Sizing

Motor Rating		Copper Wire Size								
Voltage	HP	14	12	10	8	6	4	2	0	00
230	1½	420	670	1060	1670	2610				
	2	320	510	810	1280	2010				
	3	240	390	620	990	1540	2400			
	5		230	370	590	920	1430	2190		
	7½			260	420	650	1020	1560	2340	2870
	10					310	490	760	1170	1760
460	1½	1700	2710	4270	6730					
	2	1300	2070	3270	5150					
	3	1000	1600	2520	3970	6200				
	5	590	950	1500	2360	3700	5750			
	7½	420	680	1070	1690	2640	4100	6260		
	10	310	500	790	1250	1960	3050	4680		

Wilo USA LLC
+ 1-888-945-6872
www.wilo-usa.com
groundwater@wilo-usa.com

Wilo USA LLC
86 Genesis Parkway
Thomasville, GA 31792

