

Submittal Data Sheet

Wilco IL - Inline Centrifugal Circulators



Wilco IL 2-110, 2-130, 2-170 3500 RPM



Project:	
Engineer:	
Contractor:	
Submitted By:	Date:
Approved By:	Date:

Tag #	Model #	Flow	Head	HP	Cycle	Phase	Voltage	RPM
					60Hz			3,500 (2 Pole)

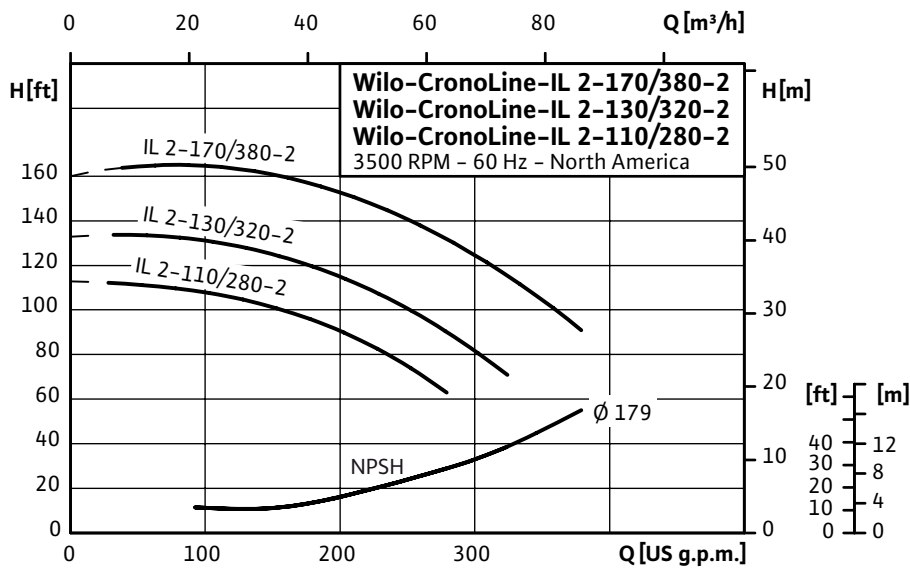

Technical Data	
Temp Range:	-5 °F to +285 °F (-20 °C to +140 °C)
Power Supply	3-208-230/460, 575 volt
Motor Options	TEFC, (ODP Opt), EPACK Rated
Flange Connection	2" NPT with 1/4" pressure gauge tapings
Max operating pressure:	250 PSI (16 bar)

Materials of Construction	
Pump volute	Cast Iron
Impeller	Bronze (cast iron optional)
Shaft	316L stainless steel
Mechanical seal	Q1Q1X4GG (silicium carbide seal faces, HNBR elastomers)

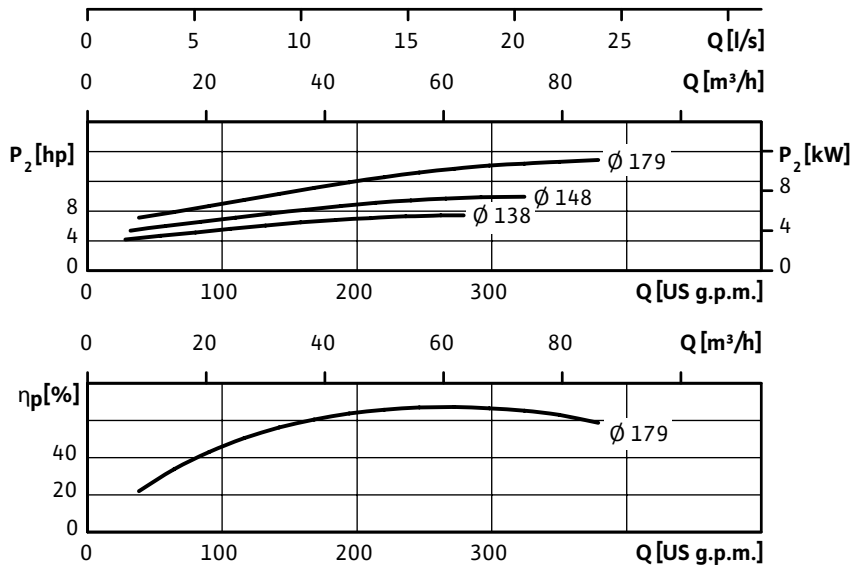

Applications	
• Hot water heating systems	• Industrial circulation systems
• Air conditioning systems	• Solar Systems
• Closed cooling circuits	• Geothermal Systems

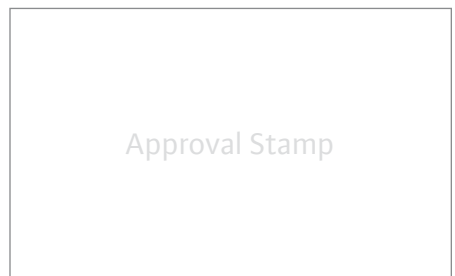

Dimensions & Weights

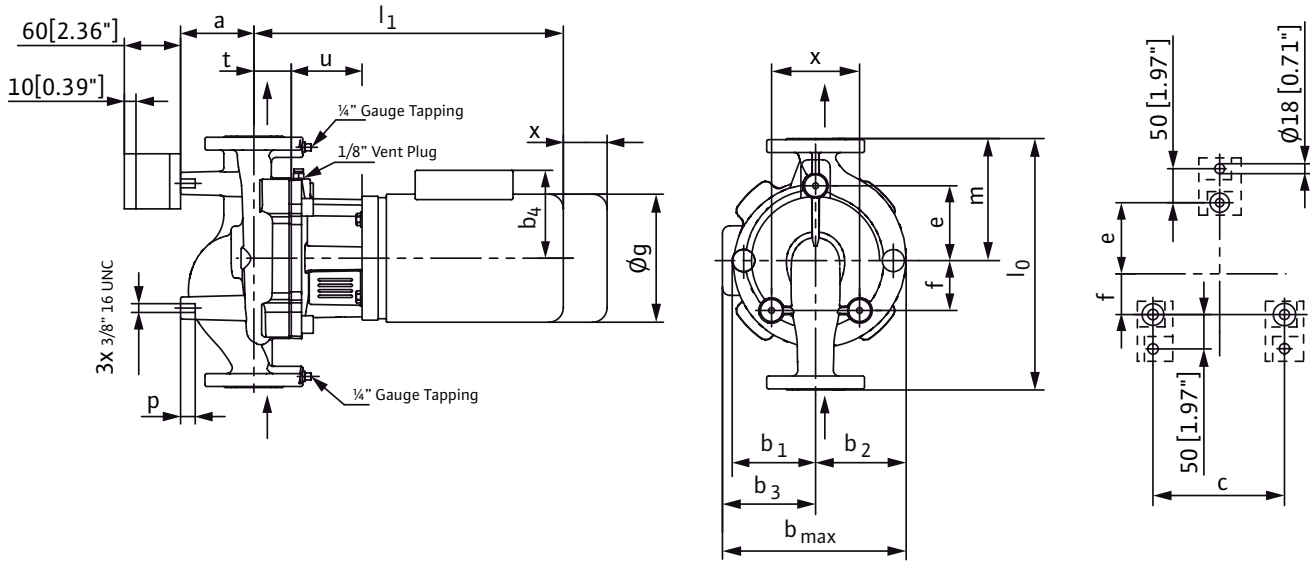

Dimensions and Weights

Model	Dia	Dimensions-inches (mm)															Weight		
		l_0	a	b_1	b_2	b_3	b_4	b_{max}	c	e	f	ϕg	l_1	m	p	t		u	x
IL 2-110/280-2	2	15	3 ⁹ / ₁₆	4 ³ / ₄	5 ¹ / ₂	6 ⁷ / ₈	-	12 ⁵ / ₁₆	6 ⁷ / ₁₆	4 ⁵ / ₈	1 ⁷ / ₈	8 ⁵ / ₈	22 ¹³ / ₁₆	7 ⁵ / ₁₆	1 ³ / ₁₆	2 ¹³ / ₁₆	4 ⁹ / ₁₆	4	139 lbs
	(381)	(90)	(120)	(139)	(175)	-	(314)	(164)	(117)	(48)	(218)	(579)	(186)	(20)	(72)	(116)	(102)	63 kg	
IL 2-130/320-2	2	15	3 ⁹ / ₁₆	4 ³ / ₄	5 ¹ / ₂	7 ¹⁵ / ₁₆	-	13 ³ / ₈	6 ⁷ / ₁₆	4 ⁵ / ₈	1 ⁷ / ₈	10 ³ / ₁₆	22 ¹¹ / ₁₆	7 ⁵ / ₁₆	1 ³ / ₁₆	2 ¹³ / ₁₆	4 ⁹ / ₁₆	4	207 lbs
	(381)	(90)	(120)	(139)	(201)	-	(340)	(164)	(117)	(48)	(259)	(577)	(186)	(20)	(72)	(116)	(102)	94 kg	
IL 2-170/380-2	2	15	3 ⁹ / ₁₆	4 ³ / ₄	5 ¹ / ₂	7 ¹⁵ / ₁₆	-	13 ³ / ₈	6 ⁷ / ₁₆	4 ⁵ / ₈	1 ⁷ / ₈	10 ³ / ₁₆	23 ¹¹ / ₁₆	7 ⁵ / ₁₆	1 ³ / ₁₆	2 ¹³ / ₁₆	4 ⁹ / ₁₆	4	223 lbs
	(381)	(90)	(120)	(139)	(201)	-	(340)	(164)	(117)	(48)	(259)	(602)	(186)	(20)	(72)	(116)	(102)	101 kg	

Flange Dimensions

Dimensions - Inches (mm)				
DN	ϕD	ϕd_1	ϕk	$n \times d_L$
2	6 ¹ / ₂	4 ³ / ₁₆	4 ³ / ₄	4 x 3/4
	(165)	(106)	(121)	(4 x 19)

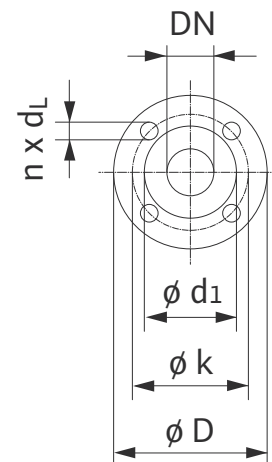

TEFC Motor Data

Model	P2	Phase	Voltage	FLA
	[HP]	[-]	[V]	[A]
IL 2-110/280-2	7.5	3	208-230/460	18-17.2/8.6
IL 2-130/320-2	10	3	208-230/460	25-23/11.5
IL 2-170/380-2	15	3	208-230/460	37.5-34/17